

OCCUPANCY
 SF DU TR
 CONVERSION
BUILDING TYPE
 MOBILE HOME
 BI/TR LEVEL
 MOD/MAN

FLOOR	AREA	CONST	VALUE
1	1363	BRK	204,930

ROOFING
 METAL
 SLT/TLE
 SHINGLES
 SHAKES
 COMPOSITE

EXTERIOR
 WOOD
 STUCCO
 ALM/VYNL
 CONC BLK
 METAL
 BRICK
 STONE

ROOF TYPE
 GABLE
 HIP
 GAMBREL
 MANSARD
 FLAT

FLOOR	AREA	CONST	VALUE
BSMT	1363		19,490
SUBTOTAL			224,420

FLOORS B 1 2 3 U
 CONCRETE
 WOOD
 TILE/COMPO
 CARPET

MULTI-FAMILY #	0	0
BUILDING TYPE	100%	0
BSMT FINISH	1,208 S.F.	17,270
FIREPLACE #	0	0
HEATING	0 S.F.	0
AIR COND	1,363 S.F.	2,250
PLUMBING #	3	3,630
GARAGES & CARPORTS		18,600
EXTRA FEATURES		10,100
SUBTOTAL		276,270

INT. FINISH B 1 2 3 U
 PLASTER/DW
 PANELING
 UNFINISHED

GRADE FACTOR		95 %
UNADJUSTED VALUE		262,460
FACTOR		100 %

ACCOMMODATIONS
 # OF ROOMS 5
 BEDROOMS 3
 FIREPLACES

OCCUPANCY	ST.HT	SIZE	AREA	GRADE	PRICE	AGE	REMD	CND	UNADJ VAL	PHYS	PHYS VAL	FUNC	TRUE VAL
DWELLING	1	SK	1,363	C-		1967		A	262,460	40	157,480		181,100
1													
2													
3													
4													
5													
6													
7													
8													
9													
10													
11													

HEAT & AC B 1 2 3 U
 NO HEAT
 CTRL HEAT
 HW/STEAM
 ELECTRIC
 HEAT PUMP
 FLR/WALL
 STVE/SPCE
 GEOTHERMAL
 OUTSIDE
 CTRL A/C

OCCUPANCY	ST.HT	SIZE	AREA	GRADE	PRICE	AGE	REMD	CND	UNADJ VAL	PHYS	PHYS VAL	FUNC	TRUE VAL
DWELLING	1	SK	1,363	C-		1967		A	262,460	40	157,480		181,100
1													
2													
3													
4													
5													
6													
7													
8													
9													
10													
11													

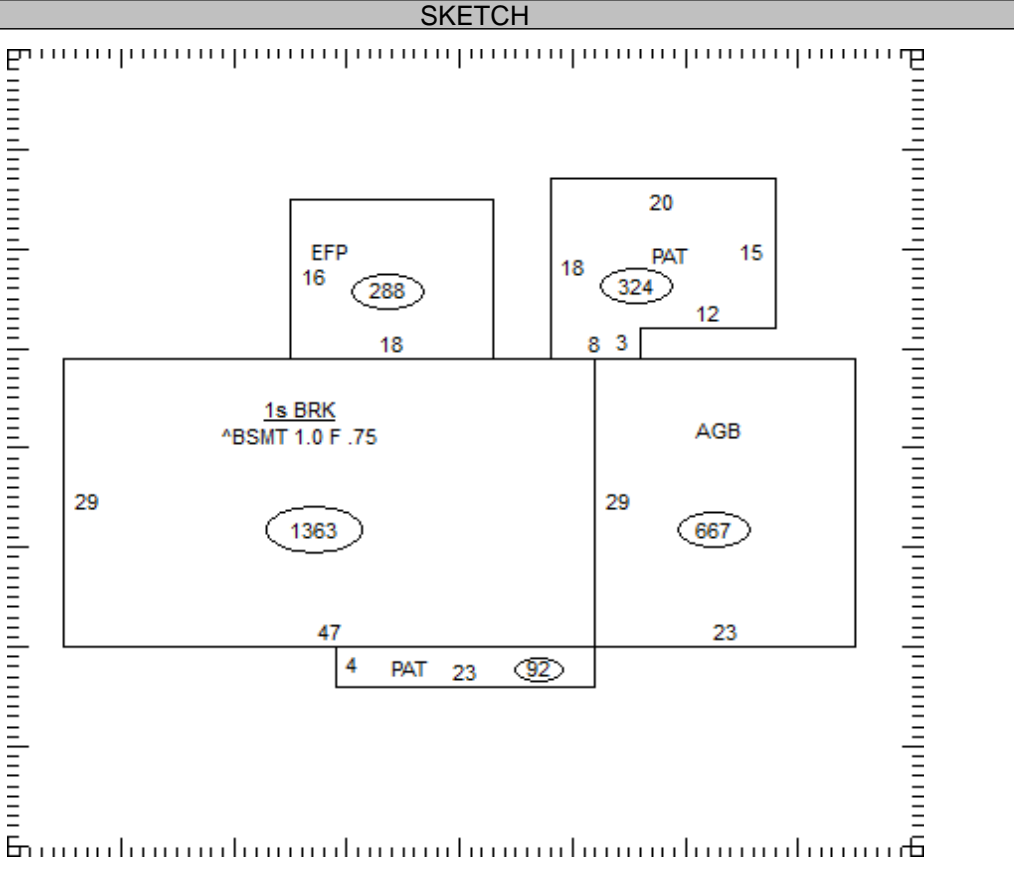

PLUMBING BASE
 X FULL BATH 1
 X HALF BATH
 X FIXTURES

TOTAL												181,100
--------------	--	--	--	--	--	--	--	--	--	--	--	---------

COMMENTS
 ELECTRIC
 Dwelling has an Economic Factor of 115%