

Property Address: ST RT 274

DTE Code: 390



\*35-024900.0000\*

MARION TWP-CHICKASAW CORP  
MARION SD  
12-15-226-001

**LEGAL INFORMATION**

SEITZ ADDITION

LOT#: 16  
**HOMAN KEVIN R & LISA A**  
HOMAN KEVIN R & LISA A  
2578 CASSELLA MONTEZUMA RD  
MARIA STEIN, OH 45860

Neighborhood INDS35
Map: 2A3
Block: Card: 15
Bk: Pg:

COMMENT  
TY2022:Net Gen=\$289.62, Other Assessment=\$0.00  
NO GRAIN BIN STRG  
DE23 RMV STG FERT BLDG  
ALL IMPROVEMENTS ON PCL 35-024500.0000

Sales Data						Date
Date	Amount	Deed:Conv#	Use	Valid	Lister:	03/08/23
03/03/2023	279,000	6:WDC : 107	390	<input checked="" type="checkbox"/>	Pricer:	
	0	: 0	390	<input type="checkbox"/>	Reviewer:	
				<input type="checkbox"/>	Final:	
				<input type="checkbox"/>	Call Back:	
				<input type="checkbox"/>	Visit:	

VALUATION SUMMARY			
VALUE YEAR	2023	2020	2017
REASON FOR CHANGE	RAPP	RAPP	RAPP
ESTIMATED	5,340	16,020	16,020
MARKET VALUE	6,700	0	0
	TOTAL	12,040	16,020
ASSESSED	1,870	5,610	5,610
VALUE	2,350	0	0
	TOTAL	4,220	5,610

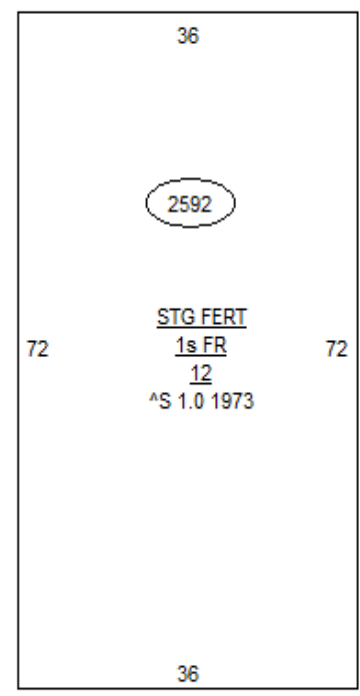

STREET/ROAD	TOPOGRAPHY	PU-UTILITIES-PR	ZONING
<input checked="" type="checkbox"/> PAVED	<input checked="" type="checkbox"/> LEVEL	<input type="checkbox"/> WATER	<input type="checkbox"/> AG-RES
<input type="checkbox"/> GRAVEL	<input type="checkbox"/> HIGH	<input type="checkbox"/> SEWER	<input type="checkbox"/> COMMERCIAL
<input type="checkbox"/> DIRT	<input type="checkbox"/> LOW	<input type="checkbox"/> GAS	<input checked="" type="checkbox"/> INDUSTRIAL
<input type="checkbox"/> SIDEWALKS	<input type="checkbox"/> ROLLING	<input type="checkbox"/> ELECTRIC	
<input type="checkbox"/> CURBS	<input type="checkbox"/> STANDARD	<input checked="" type="checkbox"/> STANDARD	

INFLUENCE FACTORS		
A. NO ROAD	E. SZ/SHAPE	I. WATER FRONT
B. TOPGRHY	F. RESTRICT	J. OTHER/CDU
C. Ex Front	G. WOOD LT	
D. QUANTITY	H. VACANCY	

LAND TYPE	SIZE	M	RATE	C	INF	M	VALUE	C
F:Front	F60 D120		ST100 DP89 ADJ89				5,340	0
Totals:							5,340	0

