



**OCCUPANCY**  
 SF  DU  TR  
 CONVERSION  
**BUILDING TYPE**  
 MOBILE HOME  
 BI/TR LEVEL  
 MOD/MAN

**EXTERIOR**  
 WOOD  
 STUCCO  
 ALM/VYNL  
 CONC BLK  
 METAL  
 BRICK  
 STONE

| FLOOR           | AREA | CONST | VALUE   |
|-----------------|------|-------|---------|
| 1               | 910  | FR    | 149,120 |
| .5              | 294  | FR    | 29,870  |
|                 |      |       |         |
|                 |      |       |         |
|                 |      |       |         |
|                 |      |       |         |
|                 |      |       |         |
|                 |      |       |         |
|                 |      |       |         |
|                 |      |       |         |
|                 |      |       |         |
|                 |      |       |         |
| BSMT            | 668  |       | 9,550   |
| <b>SUBTOTAL</b> |      |       | 188,540 |

**ROOFING**  
 METAL  
 SLT/TLE  
 SHINGLES  
 SHAKES  
 COMPOSITE

**ROOF TYPE**  
 GABLE  
 HIP  
 GAMBREL  
 MANSARD  
 FLAT

**FLOORS**

| B                        | 1                                   | 2                                   | 3                        | U                        |
|--------------------------|-------------------------------------|-------------------------------------|--------------------------|--------------------------|
| <input type="checkbox"/> | <input type="checkbox"/>            | <input type="checkbox"/>            | <input type="checkbox"/> | <input type="checkbox"/> |
| <input type="checkbox"/> | <input checked="" type="checkbox"/> | <input checked="" type="checkbox"/> | <input type="checkbox"/> | <input type="checkbox"/> |
| <input type="checkbox"/> | <input type="checkbox"/>            | <input type="checkbox"/>            | <input type="checkbox"/> | <input type="checkbox"/> |
| <input type="checkbox"/> | <input type="checkbox"/>            | <input type="checkbox"/>            | <input type="checkbox"/> | <input type="checkbox"/> |

CONCRETE  
WOOD  
TILE/COMPO  
CARPET

**INT. FINISH**

| B                        | 1                                   | 2                                   | 3                        | U                        |
|--------------------------|-------------------------------------|-------------------------------------|--------------------------|--------------------------|
| <input type="checkbox"/> | <input checked="" type="checkbox"/> | <input checked="" type="checkbox"/> | <input type="checkbox"/> | <input type="checkbox"/> |
| <input type="checkbox"/> | <input type="checkbox"/>            | <input type="checkbox"/>            | <input type="checkbox"/> | <input type="checkbox"/> |
| <input type="checkbox"/> | <input type="checkbox"/>            | <input type="checkbox"/>            | <input type="checkbox"/> | <input type="checkbox"/> |

PLASTER/DW  
PANELING  
UNFINISHED

**ACCOMMODATIONS**

| # OF ROOMS | 3 | 3 |  |  |
|------------|---|---|--|--|
| BEDROOMS   | 1 | 2 |  |  |

FIREPLACES

**HEAT & AC**

| B                        | 1                                   | 2                                   | 3                        | U                        |
|--------------------------|-------------------------------------|-------------------------------------|--------------------------|--------------------------|
| <input type="checkbox"/> | <input type="checkbox"/>            | <input type="checkbox"/>            | <input type="checkbox"/> | <input type="checkbox"/> |
| <input type="checkbox"/> | <input checked="" type="checkbox"/> | <input checked="" type="checkbox"/> | <input type="checkbox"/> | <input type="checkbox"/> |
| <input type="checkbox"/> | <input type="checkbox"/>            | <input type="checkbox"/>            | <input type="checkbox"/> | <input type="checkbox"/> |
| <input type="checkbox"/> | <input type="checkbox"/>            | <input type="checkbox"/>            | <input type="checkbox"/> | <input type="checkbox"/> |
| <input type="checkbox"/> | <input type="checkbox"/>            | <input type="checkbox"/>            | <input type="checkbox"/> | <input type="checkbox"/> |
| <input type="checkbox"/> | <input type="checkbox"/>            | <input type="checkbox"/>            | <input type="checkbox"/> | <input type="checkbox"/> |
| <input type="checkbox"/> | <input type="checkbox"/>            | <input type="checkbox"/>            | <input type="checkbox"/> | <input type="checkbox"/> |
| <input type="checkbox"/> | <input type="checkbox"/>            | <input type="checkbox"/>            | <input type="checkbox"/> | <input type="checkbox"/> |

NO HEAT  
CTRL HEAT  
HW/STEAM  
ELECTRIC  
HEAT PUMP  
FLR/WALL  
STVE/SPCE  
GEOTHERMAL  
OUTSIDE  
CTRL A/C

**PLUMBING**

| BASE                                |  |  |  |  |  |
|-------------------------------------|--|--|--|--|--|
| <input checked="" type="checkbox"/> |  |  |  |  |  |

X FULL BATH  
X HALF BATH  
X FIXTURES

|                         |        |         |
|-------------------------|--------|---------|
| MULTI-FAMILY #          | 0      | 0       |
| BUILDING TYPE           | 100%   | 0       |
| BSMT FINISH             | 0 S.F. | 0       |
| FIREPLACE #             | 0      | 0       |
| HEATING                 | 0 S.F. | 0       |
| AIR COND                | 0 S.F. | 0       |
| PLUMBING #              | 0      | 0       |
| GARAGES & CARPORTS      |        | 0       |
| EXTRA FEATURES          |        | 1,300   |
| <b>SUBTOTAL</b>         |        | 189,840 |
| GRADE FACTOR            |        | 100 %   |
| <b>UNADJUSTED VALUE</b> |        | 189,840 |
| FACTOR                  |        | 100 %   |

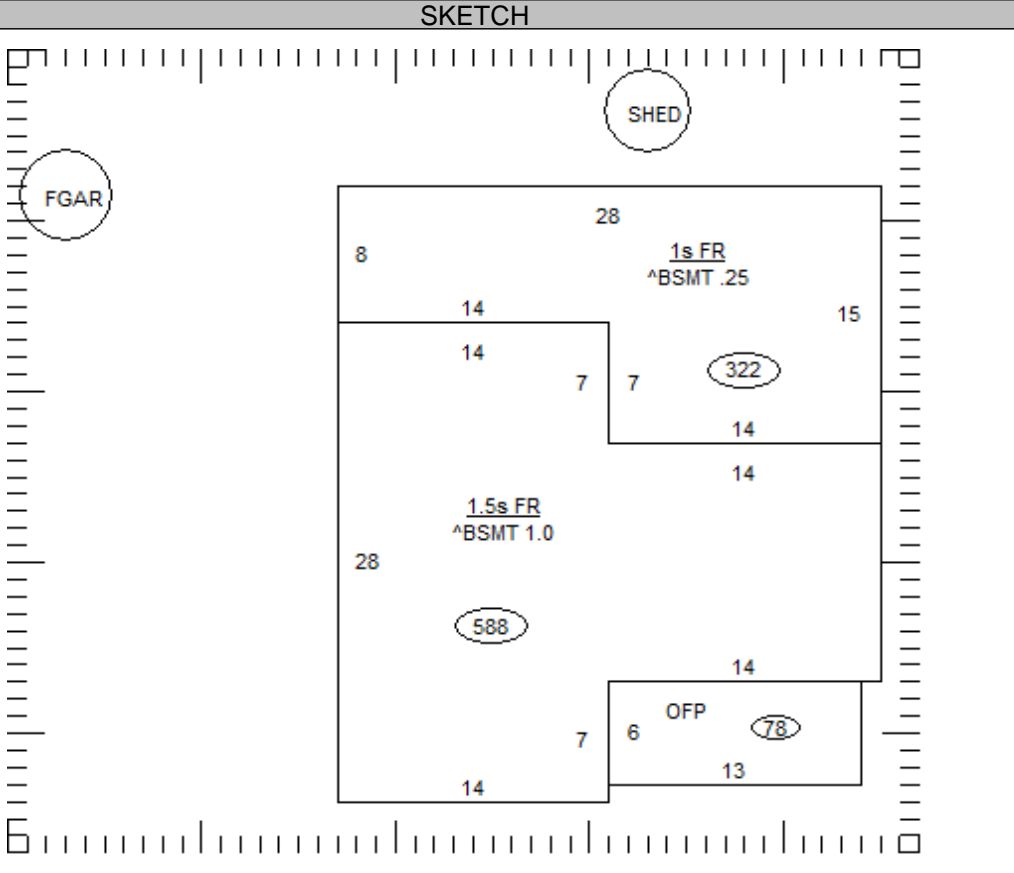

| OCCUPANCY     | ST.HT | SIZE  | AREA  | GRADE | PRICE | AGE  | REMD | CND | UNADJ VAL | PHYS | PHYS VAL | FUNC | TRUE VAL |
|---------------|-------|-------|-------|-------|-------|------|------|-----|-----------|------|----------|------|----------|
| DWELLING      | 1.5   | SK    | 1,204 | C     |       | 1896 | 1947 | A   | 189,840   | 45   | 104,410  |      | 141,000  |
| 1 Gar - Frame |       | 24x28 | 672   | C     | 23.70 | 1979 |      | A   | 15,930    | 77   | 3,660    |      | 3,700    |
| 2 Shed        |       | 16x12 | 192   | C     | 9.90  | 2008 |      | A   | 1,900     | 25   | 1,430    |      | 1,400    |
| 3             |       |       |       |       |       |      |      |     |           |      |          |      |          |
| 4             |       |       |       |       |       |      |      |     |           |      |          |      |          |
| 5             |       |       |       |       |       |      |      |     |           |      |          |      |          |
| 6             |       |       |       |       |       |      |      |     |           |      |          |      |          |
| 7             |       |       |       |       |       |      |      |     |           |      |          |      |          |
| 8             |       |       |       |       |       |      |      |     |           |      |          |      |          |
| 9             |       |       |       |       |       |      |      |     |           |      |          |      |          |
| 10            |       |       |       |       |       |      |      |     |           |      |          |      |          |
| 11            |       |       |       |       |       |      |      |     |           |      |          |      |          |

31-026000.0000 TOTAL 146,100

**COMMENTS**

Dwelling has an Economic Factor of 135% (Rollback Basis=\$169,100)

31-026000.0000

**KREMER ADAM J & MARIAH R**  
KREMER ADAM J & MARIAH R  
7967 ST RTE 119  
MARIA STEIN, OH 45860

**LEGAL INFORMATION**  
OUT S SD SE

RTS: 003-07-22  
Acres:0.2960 M:0.0000

|   | OWNERSHIP                                 | ADDRESS         | CITY        | STATE | ZIP   | DATE       | AMOUNT | DEED:CONV#    | JS                       | VALID                    |
|---|---|-----------------|-------------|-------|-------|------------|--------|---------------|--------------------------|--------------------------|
| 1 | THOBE PATRICK & CARLA<br>C/O BEN SCHAEFER | 7967 ST RTE 119 | MARIA STEIN | OH    | 45860 | 07/30/2009 | 0      | CTE : x : 0   | <input type="checkbox"/> | <input type="checkbox"/> |
| 2 | THOBE NATHAN P                            | 7967 ST RTE 119 | MARIA STEIN | OH    | 45860 | 11/07/2008 | 52,500 | WDC : A : 739 | <input type="checkbox"/> | <input type="checkbox"/> |
| 3 | HAUSFELD CYRIL                            | 7967 ST RT 119  | MARIA STEIN | OH    | 45860 |            | 0      | : 0           | <input type="checkbox"/> | <input type="checkbox"/> |

X:  TTO LISTER: JO DATE: 01/18/2005 TIME: 12:00:00 AM  LETTER  LETTER REC'D GIS CODE

| STREET/ROAD                               | TOPOGRAPHY                                | PU-UTILITIES-PR  | NEIGHBORHOOD                               | INFLUENCE FACTORS  | PROPERTY LOCATION           |
|---|---|--|--|--|-----------------------------|
| <input checked="" type="checkbox"/> PAVED | <input checked="" type="checkbox"/> LEVEL | <input type="checkbox"/> WATER <input type="checkbox"/>    | <input type="checkbox"/> IMPROVING         | <input type="checkbox"/> A. NO ROAD <input type="checkbox"/> F. RESTRICT     | 7967 ST RT 119, MARIA STEIN |
| <input type="checkbox"/> GRAVEL           | <input type="checkbox"/> HIGH             | <input type="checkbox"/> SEWER <input type="checkbox"/>    | <input checked="" type="checkbox"/> STATIC | <input type="checkbox"/> B. TOPGRHY <input type="checkbox"/> G. WOOD LT      | COMMENT                     |
| <input type="checkbox"/> DIRT             | <input type="checkbox"/> LOW              | <input type="checkbox"/> GAS <input type="checkbox"/>      | <input type="checkbox"/> DECLINING         | <input type="checkbox"/> C. Ex Front <input type="checkbox"/> H. VACANCY     |                             |
| <input type="checkbox"/> SIDEWALKS        | <input type="checkbox"/> ROLLING          | <input type="checkbox"/> ELECTRIC <input type="checkbox"/> | <input type="checkbox"/> OLD               | <input type="checkbox"/> D. QUANTITY <input type="checkbox"/> I. WATER FRONT |                             |
| <input type="checkbox"/> CURBS            | <input type="checkbox"/> STANDARD         | <input checked="" type="checkbox"/> STANDARD               | <input type="checkbox"/> STANDARD          | <input type="checkbox"/> E. SZ/SHAPE <input type="checkbox"/> J. OTHER/CDU   |                             |

| LAND COMPUTATIONS |      |   |      |   |     |        |         |
|-------------------|------|---|------|---|-----|--------|---------|
| LAND TYPE         | SIZE | M | RATE | C | INF | M      | VALUE C |
|                   |      |   |      |   |     |        |         |
|                   |      |   |      |   |     |        |         |
|                   |      |   |      |   |     |        |         |
|                   |      |   |      |   |     |        |         |
|                   |      |   |      |   |     |        |         |
|                   |      |   |      |   |     |        |         |
|                   |      |   |      |   |     |        |         |
|                   |      |   |      |   |     |        |         |
|                   |      |   |      |   |     |        |         |
| TOTAL             |      |   |      |   |     | 24,400 | 0       |

**VALUATION SUMMARY**

| VALUE YEAR | REASON FOR CHANGE | APPRaised | LAND IMPR | VALUE TOTAL | ASSESSED | LAND IMPR | VALUE TOTAL |
|------------|-------------------|-----------|-----------|-------------|----------|-----------|-------------|
|            |                   |           |           |             |          |           |             |
|            |                   |           |           |             |          |           |             |
|            |                   |           |           |             |          |           |             |
|            |                   |           |           |             |          |           |             |

| OCCUPANCY   | EXTERIOR                          | FLOOR | AREA | CONST | VALUE |
|---|-----------------------------------|-------|------|-------|-------|
| <input type="checkbox"/> SF <input type="checkbox"/> DU <input type="checkbox"/> TR | <input type="checkbox"/> WOOD     |       |      |       |       |
| <input type="checkbox"/> CONVERSION   | <input type="checkbox"/> STUCCO   |       |      |       |       |
| <b>BUILDING TYPE</b>  | <input type="checkbox"/> ALM/VYNL |       |      |       |       |
| <input type="checkbox"/> MOBILE HOME  | <input type="checkbox"/> CONC BLK |       |      |       |       |
| <input type="checkbox"/> BI/TR LEVEL  | <input type="checkbox"/> METAL    |       |      |       |       |
| <input type="checkbox"/> MOD/MAN  | <input type="checkbox"/> BRICK    |       |      |       |       |
| <input type="checkbox"/>  | <input type="checkbox"/> STONE    |       |      |       |       |

| ROOFING                            | ROOF TYPE                        |
|------------------------------------|----------------------------------|
| <input type="checkbox"/> METAL     | <input type="checkbox"/> GABLE   |
| <input type="checkbox"/> SLT/TLE   | <input type="checkbox"/> HIP     |
| <input type="checkbox"/> SHINGLES  | <input type="checkbox"/> GAMBREL |
| <input type="checkbox"/> SHAKES    | <input type="checkbox"/> MANSARD |
| <input type="checkbox"/> COMPOSITE | <input type="checkbox"/> FLAT    |

| FLOORS     | B                        | 1                        | 2                        | 3                        | U                        |
|------------|--------------------------|--------------------------|--------------------------|--------------------------|--------------------------|
| CONCRETE   | <input type="checkbox"/> | <input type="checkbox"/> | <input type="checkbox"/> | <input type="checkbox"/> | <input type="checkbox"/> |
| WOOD       | <input type="checkbox"/> | <input type="checkbox"/> | <input type="checkbox"/> | <input type="checkbox"/> | <input type="checkbox"/> |
| TILE/COMPO | <input type="checkbox"/> | <input type="checkbox"/> | <input type="checkbox"/> | <input type="checkbox"/> | <input type="checkbox"/> |
| CARPET     | <input type="checkbox"/> | <input type="checkbox"/> | <input type="checkbox"/> | <input type="checkbox"/> | <input type="checkbox"/> |

| INT. FINISH | B                        | 1                        | 2                        | 3                        | U                        |
|-------------|--------------------------|--------------------------|--------------------------|--------------------------|--------------------------|
| PLASTER/DW  | <input type="checkbox"/> | <input type="checkbox"/> | <input type="checkbox"/> | <input type="checkbox"/> | <input type="checkbox"/> |
| PANELING    | <input type="checkbox"/> | <input type="checkbox"/> | <input type="checkbox"/> | <input type="checkbox"/> | <input type="checkbox"/> |
| UNFINISHED  | <input type="checkbox"/> | <input type="checkbox"/> | <input type="checkbox"/> | <input type="checkbox"/> | <input type="checkbox"/> |

| ACCOMMODATIONS |                          |                               |                          |                          |                          |
|----------------|--------------------------|-------------------------------|--------------------------|--------------------------|--------------------------|
| # OF ROOMS     |                          |                               |                          |                          |                          |
| BEDROOMS       |                          |                               |                          |                          |                          |
| FIREPLACES     |                          |                               |                          |                          |                          |
| HEAT & AC      | B                        | 1                             | 2                        | 3                        | U                        |
| NO HEAT        | <input type="checkbox"/> | <input type="checkbox"/>      | <input type="checkbox"/> | <input type="checkbox"/> | <input type="checkbox"/> |
| CTRL HEAT      | <input type="checkbox"/> | <input type="checkbox"/>      | <input type="checkbox"/> | <input type="checkbox"/> | <input type="checkbox"/> |
| HW/STEAM       | <input type="checkbox"/> | <input type="checkbox"/>      | <input type="checkbox"/> | <input type="checkbox"/> | <input type="checkbox"/> |
| ELECTRIC       | <input type="checkbox"/> | <input type="checkbox"/>      | <input type="checkbox"/> | <input type="checkbox"/> | <input type="checkbox"/> |
| HEAT PUMP      | <input type="checkbox"/> | <input type="checkbox"/>      | <input type="checkbox"/> | <input type="checkbox"/> | <input type="checkbox"/> |
| FLR/WALL       | <input type="checkbox"/> | <input type="checkbox"/>      | <input type="checkbox"/> | <input type="checkbox"/> | <input type="checkbox"/> |
| STVE/SPCE      | <input type="checkbox"/> | <input type="checkbox"/>      | <input type="checkbox"/> | <input type="checkbox"/> | <input type="checkbox"/> |
| GEO THERMAL    | <input type="checkbox"/> | <input type="checkbox"/>      | <input type="checkbox"/> | <input type="checkbox"/> | <input type="checkbox"/> |
| OUTSIDE        | <input type="checkbox"/> | <input type="checkbox"/>      | <input type="checkbox"/> | <input type="checkbox"/> | <input type="checkbox"/> |
| CTRL A/C       | <input type="checkbox"/> | <input type="checkbox"/>      | <input type="checkbox"/> | <input type="checkbox"/> | <input type="checkbox"/> |
| PLUMBING       |                          | BASE <input type="checkbox"/> |                          |                          |                          |
| X FULL BATH    |                          |                               |                          |                          |                          |
| X HALF BATH    |                          |                               |                          |                          |                          |
| X FIXTURES     |                          |                               |                          |                          |                          |

| SUBTOTAL           |        | 0 |
|--------------------|--------|---|
| MULTI-FAMILY #     | 0      | 0 |
| BUILDING TYPE      | 000%   | 0 |
| BSMT FINISH        | 0 S.F. | 0 |
| FIREPLACE #        | 0      | 0 |
| HEATING            | 0 S.F. | 0 |
| AIR COND           | 0 S.F. | 0 |
| PLUMBING #         | 0      | 0 |
| GARAGES & CARPORTS |        | 0 |
| EXTRA FEATURES     |        | 0 |
| SUBTOTAL           |        | 0 |
| GRADE FACTOR       |        | % |
| UNADJUSTED VALUE   |        | 0 |
| FACTOR             |        | % |

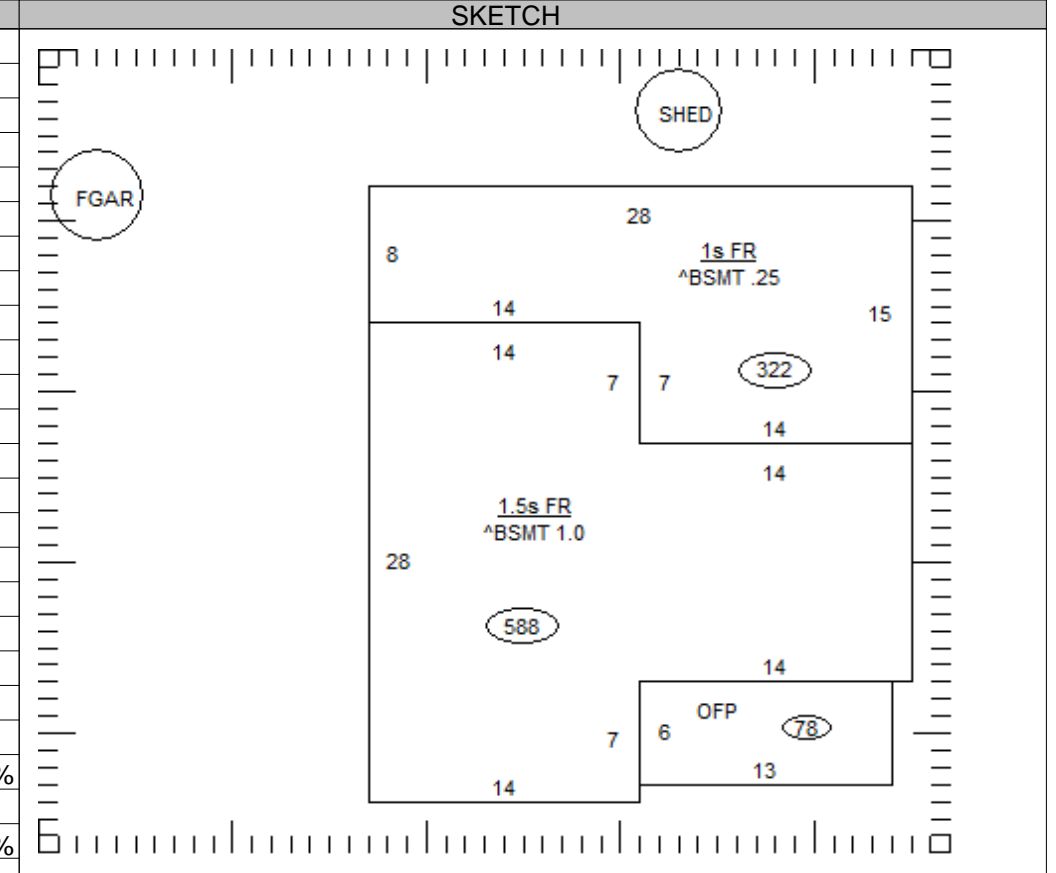

| OCCUPANCY | ST.HT | SIZE | AREA | GRADE | PRICE | AGE | REMD | CND | UNADJ VAL | PHYS | PHYS VAL | FUNC | TRUE VAL |
|-----------|-------|------|------|-------|-------|-----|------|-----|-----------|------|----------|------|----------|
| DWELLING  |       | SK   |      |       |       |     |      |     |           |      |          |      |          |
| 1         |       |      |      |       |       |     |      |     |           |      |          |      |          |
| 2         |       |      |      |       |       |     |      |     |           |      |          |      |          |
| 3         |       |      |      |       |       |     |      |     |           |      |          |      |          |
| 4         |       |      |      |       |       |     |      |     |           |      |          |      |          |
| 5         |       |      |      |       |       |     |      |     |           |      |          |      |          |
| 6         |       |      |      |       |       |     |      |     |           |      |          |      |          |
| 7         |       |      |      |       |       |     |      |     |           |      |          |      |          |
| 8         |       |      |      |       |       |     |      |     |           |      |          |      |          |
| 9         |       |      |      |       |       |     |      |     |           |      |          |      |          |
| 10        |       |      |      |       |       |     |      |     |           |      |          |      |          |
| 11        |       |      |      |       |       |     |      |     |           |      |          |      |          |

31-026000.0000

TOTAL 0

**COMMENTS**