

LIBERTY TWP / PARKWAY SD

04-20-100-002

Property Class: 111

Neighborhood

009301-A100

Map:

Block:

Card:

Bk:

Pg:

30-032600.0000

LEGAL INFORMATION

S1/2 NW

**QUALIFIED CREDITS: CAUV:
06809: 2021**

RTS: 001-05-20
Acres:4.0000

EISCHEN TREVOR
EISCHEN TREVOR
8328 ST RT 49
CELINA, OH 45822

| | OWNERSHIP | ADDRESS | CITY | STATE | ZIP | DATE | AMOUNT | DEED:CONV# | JS | VALID |
|---|--------------------|---------------|--------|-------|-------|------------|---------|------------|--------------------------|-------------------------------------|
| 1 | EISCHEN TREVOR | 8328 ST RT 49 | CELINA | OH | 45822 | 05/07/2020 | 120,000 | FDC : 287 | <input type="checkbox"/> | <input checked="" type="checkbox"/> |
| 2 | MUHLENKAMP WILLIAM | 7911 ST RT 49 | CELINA | OH | 45822 | 10/05/1984 | 104,000 | : A : 0 | <input type="checkbox"/> | <input type="checkbox"/> |
| 3 | | | | | | | 0 | 0 | <input type="checkbox"/> | <input type="checkbox"/> |

X: TTO LISTER: HK DATE: 07/03/2023 TIME: 12:00:00 AM LETTER LETTER REC'D GIS CODE

| STREET/ROAD | TOPOGRAPHY | PU-UTILITIES-PR | NEIGHBORHOOD | INFLUENCE FACTORS | | | | PROPERTY LOCATION |
|---|---|--|------------------------------------|--------------------------------------|---|----------------------------------|--|-------------------|
| <input checked="" type="checkbox"/> PAVED | <input checked="" type="checkbox"/> LEVEL | <input type="checkbox"/> WATER | <input type="checkbox"/> IMPROVING | <input type="checkbox"/> A. NO ROAD | <input type="checkbox"/> F. RESTRICT | ST RTE 49, CELINA | | |
| <input type="checkbox"/> GRAVEL | <input type="checkbox"/> HIGH | <input type="checkbox"/> SEWER | <input type="checkbox"/> STATIC | <input type="checkbox"/> B. TOPGRHY | <input type="checkbox"/> G. WOOD LT | COMMENT | | |
| <input type="checkbox"/> DIRT | <input type="checkbox"/> LOW | <input type="checkbox"/> GAS | <input type="checkbox"/> DECLINING | <input type="checkbox"/> C. Ex Front | <input type="checkbox"/> H. VACANCY | TY2022:Net Gen=\$1,126.34, Other | | |
| <input type="checkbox"/> SIDEWALKS | <input type="checkbox"/> ROLLING | <input type="checkbox"/> ELECTRIC | <input type="checkbox"/> OLD | <input type="checkbox"/> D. QUANTITY | <input type="checkbox"/> I. WATER FRONT | Assessment=\$0.00 | | |
| <input type="checkbox"/> CURBS | <input type="checkbox"/> STANDARD | <input checked="" type="checkbox"/> STANDARD | <input type="checkbox"/> STANDARD | <input type="checkbox"/> E. SZ/SHAPE | <input type="checkbox"/> J. OTHER/CDU | DE17 CORR ROAD FRONTAGE | | |

| LAND COMPUTATIONS | | | | | | | |
|---------------------------|-----------------|---------------|--------------|---|-------|---------------|--------------|
| LAND TYPE | SIZE | M | RATE | C | INF | M | VALUE C |
| CR:Crop Land TOTAL | A 2.7790 | 11,850 | 3,050 | | | 33,860 | 9,270 |
| 0087 | A 2.1620 | 12,450 | 3,560 | | | 26,920 | 7,700 |
| 0022 | A .6170 | 11,250 | 2,540 | | | 6,940 | 1,570 |
| HS:Home Site | A 1.0000 | 23,390 | 23,390 | | | 23,390 | 23,390 |
| RD:Road | A .2210 | 0 | 0 | | | 0 | 0 |
| | | | | | | | |
| | | | | | | | |
| | | | | | | | |
| | | | | | | | |
| | | | | | | | |
| Total Acres: 4.0000 | | | | | TOTAL | 57,250 | 32,660 |

DE22 DESKTOP RVW; RMV SHED
NC24 SCH F
DE23 \$2637 CAUV INCOME
DE23 ADD POLE GAR

| VALUATION SUMMARY | | | | | | | | |
|-------------------|---|---------|---------|---------|---------|--------|--------|--------|
| VALUE YEAR | 2023 | 2023 | 2023 | 2023 | 2022 | 2022 | 2021 | 2021 |
| REASON FOR CHANGE | CAUV | RAPP | CAUV | NC | CAUV | REMB | CAUV | MISC |
| APPRAISED | LAND | 32,660 | 57,250 | 28,420 | 57,250 | 21,530 | 42,280 | 42,280 |
| VALUE | IMPR | 127,400 | 127,400 | 127,400 | 127,400 | 51,400 | 51,400 | 51,600 |
| | TOTAL | 160,060 | 184,650 | 155,820 | 184,650 | 72,930 | 93,680 | 93,880 |
| ASSESSED | LAND | 11,430 | 20,040 | 9,950 | 20,040 | 7,540 | 14,800 | 14,800 |
| VALUE | IMPR | 44,590 | 44,590 | 44,590 | 44,590 | 17,990 | 17,990 | 18,060 |
| | TOTAL | 56,020 | 64,630 | 54,540 | 64,630 | 25,530 | 32,790 | 32,860 |
| POTENTIAL RECOUP | 2022=320.74, 2021=315.89, 2020=320.25: Total=956.88 | | | | | | | |

| | | | |
|--|-----------------------------|-----------------------------------|--|
| OCCUPANCY | | EXTERIOR | |
| <input checked="" type="checkbox"/> SF | <input type="checkbox"/> DU | <input type="checkbox"/> TR | <input checked="" type="checkbox"/> WOOD |
| <input type="checkbox"/> CONVERSION | | <input type="checkbox"/> STUCCO | |
| BUILDING TYPE | | <input type="checkbox"/> ALM/VYNL | |
| <input type="checkbox"/> MOBILE HOME | | <input type="checkbox"/> CONC BLK | |
| <input type="checkbox"/> BI/TR LEVEL | | <input type="checkbox"/> METAL | |
| <input type="checkbox"/> MOD/MAN | | <input type="checkbox"/> BRICK | |
| <input type="checkbox"/> | | <input type="checkbox"/> STONE | |

| | | | |
|--|--|----------------------------------|--|
| ROOFING | | ROOF TYPE | |
| <input type="checkbox"/> METAL | | <input type="checkbox"/> GABLE | |
| <input type="checkbox"/> SLT/TLE | | <input type="checkbox"/> HIP | |
| <input checked="" type="checkbox"/> SHINGLES | | <input type="checkbox"/> GAMBREL | |
| <input type="checkbox"/> SHAKES | | <input type="checkbox"/> MANSARD | |
| <input type="checkbox"/> COMPOSITE | | <input type="checkbox"/> FLAT | |

| | | | | | | |
|---------------|--------------------------|-------------------------------------|-------------------------------------|--------------------------|--------------------------|--------------------------|
| FLOORS | | B | 1 | 2 | 3 | U |
| CONCRETE | <input type="checkbox"/> | <input type="checkbox"/> | <input type="checkbox"/> | <input type="checkbox"/> | <input type="checkbox"/> | <input type="checkbox"/> |
| WOOD | <input type="checkbox"/> | <input checked="" type="checkbox"/> | <input checked="" type="checkbox"/> | <input type="checkbox"/> | <input type="checkbox"/> | <input type="checkbox"/> |
| TILE/COMPO | <input type="checkbox"/> | <input type="checkbox"/> | <input type="checkbox"/> | <input type="checkbox"/> | <input type="checkbox"/> | <input type="checkbox"/> |
| CARPET | <input type="checkbox"/> | <input type="checkbox"/> | <input type="checkbox"/> | <input type="checkbox"/> | <input type="checkbox"/> | <input type="checkbox"/> |

| | | | | | | |
|--------------------|--------------------------|-------------------------------------|-------------------------------------|--------------------------|--------------------------|--------------------------|
| INT. FINISH | | B | 1 | 2 | 3 | U |
| PLASTER/DW | <input type="checkbox"/> | <input checked="" type="checkbox"/> | <input checked="" type="checkbox"/> | <input type="checkbox"/> | <input type="checkbox"/> | <input type="checkbox"/> |
| PANELING | <input type="checkbox"/> | <input type="checkbox"/> | <input type="checkbox"/> | <input type="checkbox"/> | <input type="checkbox"/> | <input type="checkbox"/> |
| UNFINISHED | <input type="checkbox"/> | <input type="checkbox"/> | <input type="checkbox"/> | <input type="checkbox"/> | <input type="checkbox"/> | <input type="checkbox"/> |

| | | | | | | |
|-----------------------|--|---|---|---|---|---|
| ACCOMMODATIONS | | B | 1 | 2 | 3 | U |
| # OF ROOMS | | 4 | 3 | | | |
| BEDROOMS | | 1 | 3 | | | |
| FIREPLACES | | | | | | |
| HEAT & AC | | B | 1 | 2 | 3 | U |

| | | | | | |
|-------------|--------------------------|-------------------------------------|-------------------------------------|--------------------------|--------------------------|
| NO HEAT | <input type="checkbox"/> | <input checked="" type="checkbox"/> | <input checked="" type="checkbox"/> | <input type="checkbox"/> | <input type="checkbox"/> |
| CTRL HEAT | <input type="checkbox"/> | <input type="checkbox"/> | <input type="checkbox"/> | <input type="checkbox"/> | <input type="checkbox"/> |
| HW/STEAM | <input type="checkbox"/> | <input type="checkbox"/> | <input type="checkbox"/> | <input type="checkbox"/> | <input type="checkbox"/> |
| ELECTRIC | <input type="checkbox"/> | <input type="checkbox"/> | <input type="checkbox"/> | <input type="checkbox"/> | <input type="checkbox"/> |
| HEAT PUMP | <input type="checkbox"/> | <input type="checkbox"/> | <input type="checkbox"/> | <input type="checkbox"/> | <input type="checkbox"/> |
| FLR/WALL | <input type="checkbox"/> | <input type="checkbox"/> | <input type="checkbox"/> | <input type="checkbox"/> | <input type="checkbox"/> |
| STVE/SPCE | <input type="checkbox"/> | <input type="checkbox"/> | <input type="checkbox"/> | <input type="checkbox"/> | <input type="checkbox"/> |
| GEO THERMAL | <input type="checkbox"/> | <input type="checkbox"/> | <input type="checkbox"/> | <input type="checkbox"/> | <input type="checkbox"/> |
| OUTSIDE | <input type="checkbox"/> | <input type="checkbox"/> | <input type="checkbox"/> | <input type="checkbox"/> | <input type="checkbox"/> |
| CTRL A/C | <input type="checkbox"/> | <input type="checkbox"/> | <input type="checkbox"/> | <input type="checkbox"/> | <input type="checkbox"/> |

| | | | |
|-----------------|--------------------------|--------------------------|-------------------------------------|
| PLUMBING | BASE | | <input checked="" type="checkbox"/> |
| X FULL BATH | <input type="checkbox"/> | <input type="checkbox"/> | <input type="checkbox"/> |
| X HALF BATH | <input type="checkbox"/> | <input type="checkbox"/> | <input type="checkbox"/> |
| X FIXTURES | <input type="checkbox"/> | <input type="checkbox"/> | <input type="checkbox"/> |

| FLOOR | AREA | CONST | VALUE |
|-------------------------|------------|-------|---------|
| 1 | 980 | FR | 158,050 |
| .5 | 336 | FR | 33,600 |
| SUBTOTAL | | | 191,650 |
| MULTI-FAMILY # | 0 | | 0 |
| BUILDING TYPE | 100% | | 0 |
| BSMT FINISH | 0 S.F. | | 0 |
| FIREPLACE # | 0 | | 0 |
| HEATING | 1,316 S.F. | | -5,000 |
| AIR COND | 0 S.F. | | 0 |
| PLUMBING # | 0 | | 0 |
| GARAGES & CARPORTS | | | 0 |
| EXTRA FEATURES | | | 1,400 |
| SUBTOTAL | | | 188,050 |
| GRADE FACTOR | | | 100 % |
| UNADJUSTED VALUE | | | 188,050 |
| FACTOR | | | 100 % |

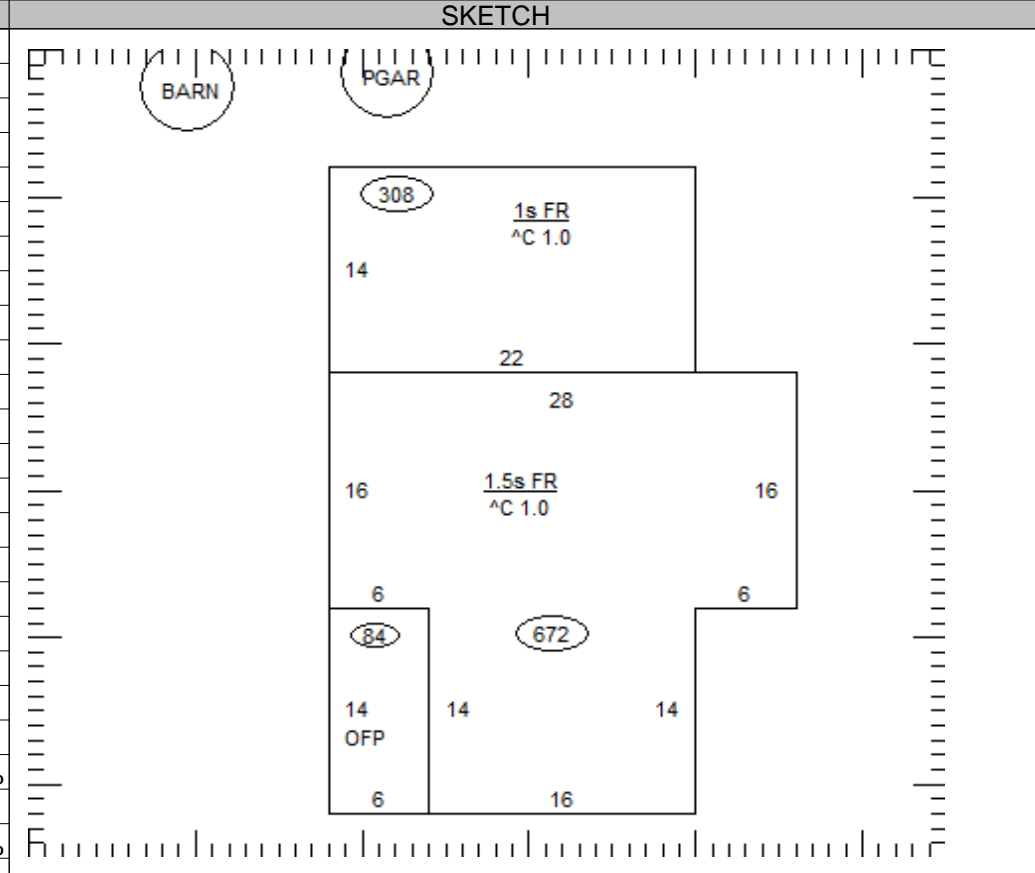

| OCCUPANCY | ST.HT | SIZE | AREA | GRADE | PRICE | AGE | REMD | CND | UNADJ VAL | PHYS | PHYS VAL | FUNC | TRUE VAL |
|--------------|-------|-------|-------|-------|-------|------|------|-----|-----------|------|----------|------|----------|
| DWELLING | 1.5 | SK | 1,316 | C | | 1900 | | A | 188,050 | 45 | 103,430 | | 103,400 |
| 1 Barn | 18 | 36x64 | 2,304 | C | 12.00 | 1910 | | F | 27,650 | 95 | 1,380 | | 1,400 |
| 2 Gar - Pole | 12 | 40x48 | 1,920 | C | 12.00 | 2022 | | A | 23,040 | 2 | 22,580 | | 22,600 |
| 3 | | | | | | | | | | | | | |
| 4 | | | | | | | | | | | | | |
| 5 | | | | | | | | | | | | | |
| 6 | | | | | | | | | | | | | |
| 7 | | | | | | | | | | | | | |
| 8 | | | | | | | | | | | | | |
| 9 | | | | | | | | | | | | | |
| 10 | | | | | | | | | | | | | |
| 11 | | | | | | | | | | | | | |

30-032600.0000

TOTAL 127,400

COMMENTS

Dwelling has an Economic Factor of 100%

LIBERTY TWP / PARKWAY SD

04-20-100-002

Property Class: 111

Neighborhood

009301-A100

Map:

Block:

Card:

Bk:

Pg:

30-032600.0000

EISCHEN TREVOR
 EISCHEN TREVOR
 8328 ST RT 49
 CELINA, OH 45822

LEGAL INFORMATION

S1/2 NW

RTS: 001-05-20
 Acres: 4.0000

QUALIFIED CREDITS: CAUV:
06809: 2021

| | OWNERSHIP | ADDRESS | CITY | STATE | ZIP | DATE | AMOUNT | DEED:CONV# | JS | VALID |
|---|--------------------|---------------|--------|-------|-------|------------|---------|------------|--------------------------|-------------------------------------|
| 1 | EISCHEN TREVOR | 8328 ST RT 49 | CELINA | OH | 45822 | 05/07/2020 | 120,000 | FDC : 287 | <input type="checkbox"/> | <input checked="" type="checkbox"/> |
| 2 | MUHLENKAMP WILLIAM | 7911 ST RT 49 | CELINA | OH | 45822 | 10/05/1984 | 104,000 | : A : 0 | <input type="checkbox"/> | <input type="checkbox"/> |
| 3 | | | | | | | 0 | 0 | <input type="checkbox"/> | <input type="checkbox"/> |

X: TTO LISTER: HK DATE: 07/03/2023 TIME: 12:00:00 AM LETTER LETTER REC'D GIS CODE

STREET/ROAD TOPOGRAPHY PU-UTILITIES-PR NEIGHBORHOOD INFLUENCE FACTORS PROPERTY LOCATION

- PAVED LEVEL WATER IMPROVING A. NO ROAD F. RESTRICT
- GRAVEL HIGH SEWER STATIC B. TOPGRHY G. WOOD LT
- DIRT LOW GAS DECLINING C. Ex Front H. VACANCY
- SIDEWALKS ROLLING ELECTRIC OLD D. QUANTITY I. WATER FRONT
- CURBS STANDARD STANDARD STANDARD E. SZ/SHAPE J. OTHER/CDU

ST RTE 49, CELINA

COMMENT

LAND COMPUTATIONS

| LAND TYPE | SIZE | M | RATE | C | INF | M | VALUE | C |
|---------------------|------|---|------|---|-----|-------|--------|--------|
| | | | | | | | | |
| | | | | | | | | |
| | | | | | | | | |
| | | | | | | | | |
| | | | | | | | | |
| | | | | | | | | |
| | | | | | | | | |
| | | | | | | | | |
| | | | | | | | | |
| | | | | | | | | |
| Total Acres: 4.0000 | | | | | | TOTAL | 57,250 | 32,660 |

VALUATION SUMMARY

| VALUE YEAR | 2020 | 2020 | 2020 | 2020 | 2018 | 2018 | 2018 | 2018 |
|-----------------------|---|--------|--------|--------|---------|---------|---------|---------|
| REASON FOR CHANGE | CAUV | RAPP | CAUV | MISC | CAUV | RAPP | CAUV | MISC |
| APPRAISED <u>LAND</u> | 21,100 | 42,280 | 23,950 | 42,220 | 205,500 | 701,960 | 208,950 | 701,960 |
| VALUE <u>IMPR</u> | 51,600 | 51,600 | 48,200 | 48,200 | 48,200 | 48,200 | 48,200 | 48,200 |
| <u>TOTAL</u> | 72,700 | 93,880 | 72,150 | 90,420 | 253,700 | 750,160 | 257,150 | 750,160 |
| ASSESSED <u>LAND</u> | 7,390 | 14,800 | 8,380 | 14,780 | 71,930 | 245,690 | 73,130 | 245,690 |
| VALUE <u>IMPR</u> | 18,060 | 18,060 | 16,870 | 16,870 | 16,870 | 16,870 | 16,870 | 16,870 |
| <u>TOTAL</u> | 25,450 | 32,860 | 25,250 | 31,650 | 88,800 | 262,560 | 90,000 | 262,560 |
| POTENTIAL RECOUP | 2022=320.74, 2021=315.89, 2020=320.25: Total=956.88 | | | | | | | |

| OCCUPANCY | EXTERIOR | FLOOR | AREA | CONST | VALUE |
|---|-----------------------------------|-------|------|-------|-------|
| <input type="checkbox"/> SF <input type="checkbox"/> DU <input type="checkbox"/> TR | <input type="checkbox"/> WOOD | | | | |
| <input type="checkbox"/> CONVERSION | <input type="checkbox"/> STUCCO | | | | |
| BUILDING TYPE | <input type="checkbox"/> ALM/VYNL | | | | |
| <input type="checkbox"/> MOBILE HOME | <input type="checkbox"/> CONC BLK | | | | |
| <input type="checkbox"/> BI/TR LEVEL | <input type="checkbox"/> METAL | | | | |
| <input type="checkbox"/> MOD/MAN | <input type="checkbox"/> BRICK | | | | |
| <input type="checkbox"/> | <input type="checkbox"/> STONE | | | | |

| ROOFING | ROOF TYPE |
|------------------------------------|----------------------------------|
| <input type="checkbox"/> METAL | <input type="checkbox"/> GABLE |
| <input type="checkbox"/> SLT/TLE | <input type="checkbox"/> HIP |
| <input type="checkbox"/> SHINGLES | <input type="checkbox"/> GAMBREL |
| <input type="checkbox"/> SHAKES | <input type="checkbox"/> MANSARD |
| <input type="checkbox"/> COMPOSITE | <input type="checkbox"/> FLAT |

| FLOORS | B | 1 | 2 | 3 | U |
|----------------|--------------------------|--------------------------|--------------------------|--------------------------|-------------------------------|
| CONCRETE | <input type="checkbox"/> | <input type="checkbox"/> | <input type="checkbox"/> | <input type="checkbox"/> | <input type="checkbox"/> |
| WOOD | <input type="checkbox"/> | <input type="checkbox"/> | <input type="checkbox"/> | <input type="checkbox"/> | <input type="checkbox"/> |
| TILE/COMPO | <input type="checkbox"/> | <input type="checkbox"/> | <input type="checkbox"/> | <input type="checkbox"/> | <input type="checkbox"/> |
| CARPET | <input type="checkbox"/> | <input type="checkbox"/> | <input type="checkbox"/> | <input type="checkbox"/> | <input type="checkbox"/> |
| INT. FINISH | B | 1 | 2 | 3 | U |
| PLASTER/DW | <input type="checkbox"/> | <input type="checkbox"/> | <input type="checkbox"/> | <input type="checkbox"/> | <input type="checkbox"/> |
| PANELING | <input type="checkbox"/> | <input type="checkbox"/> | <input type="checkbox"/> | <input type="checkbox"/> | <input type="checkbox"/> |
| UNFINISHED | <input type="checkbox"/> | <input type="checkbox"/> | <input type="checkbox"/> | <input type="checkbox"/> | <input type="checkbox"/> |
| ACCOMMODATIONS | | | | | |
| # OF ROOMS | | | | | |
| BEDROOMS | | | | | |
| FIREPLACES | | | | | |
| HEAT & AC | B | 1 | 2 | 3 | U |
| NO HEAT | <input type="checkbox"/> | <input type="checkbox"/> | <input type="checkbox"/> | <input type="checkbox"/> | <input type="checkbox"/> |
| CTRL HEAT | <input type="checkbox"/> | <input type="checkbox"/> | <input type="checkbox"/> | <input type="checkbox"/> | <input type="checkbox"/> |
| HW/STEAM | <input type="checkbox"/> | <input type="checkbox"/> | <input type="checkbox"/> | <input type="checkbox"/> | <input type="checkbox"/> |
| ELECTRIC | <input type="checkbox"/> | <input type="checkbox"/> | <input type="checkbox"/> | <input type="checkbox"/> | <input type="checkbox"/> |
| HEAT PUMP | <input type="checkbox"/> | <input type="checkbox"/> | <input type="checkbox"/> | <input type="checkbox"/> | <input type="checkbox"/> |
| FLR/WALL | <input type="checkbox"/> | <input type="checkbox"/> | <input type="checkbox"/> | <input type="checkbox"/> | <input type="checkbox"/> |
| STVE/SPCE | <input type="checkbox"/> | <input type="checkbox"/> | <input type="checkbox"/> | <input type="checkbox"/> | <input type="checkbox"/> |
| GEO THERMAL | <input type="checkbox"/> | <input type="checkbox"/> | <input type="checkbox"/> | <input type="checkbox"/> | <input type="checkbox"/> |
| OUTSIDE | <input type="checkbox"/> | <input type="checkbox"/> | <input type="checkbox"/> | <input type="checkbox"/> | <input type="checkbox"/> |
| CTRL A/C | <input type="checkbox"/> | <input type="checkbox"/> | <input type="checkbox"/> | <input type="checkbox"/> | <input type="checkbox"/> |
| PLUMBING | | | | | BASE <input type="checkbox"/> |
| X FULL BATH | | | | | |
| X HALF BATH | | | | | |
| X FIXTURES | | | | | |

| | | |
|-------------------------|--------|---|
| SUBTOTAL | | 0 |
| MULTI-FAMILY # | 0 | 0 |
| BUILDING TYPE | 000% | 0 |
| BSMT FINISH | 0 S.F. | 0 |
| FIREPLACE # | 0 | 0 |
| HEATING | 0 S.F. | 0 |
| AIR COND | 0 S.F. | 0 |
| PLUMBING # | 0 | 0 |
| GARAGES & CARPORTS | | 0 |
| EXTRA FEATURES | | 0 |
| SUBTOTAL | | 0 |
| GRADE FACTOR | | % |
| UNADJUSTED VALUE | | 0 |
| FACTOR | | % |

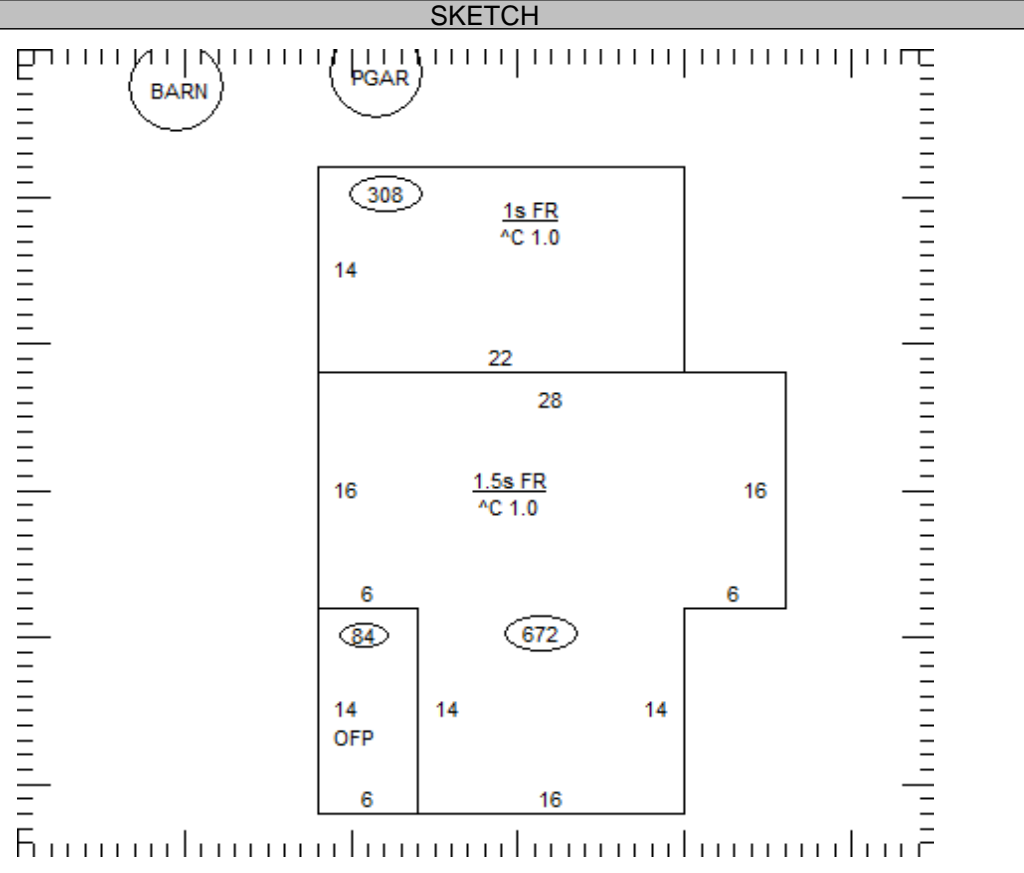

| OCCUPANCY | ST.HT | SIZE | AREA | GRADE | PRICE | AGE | REMD | CND | UNADJ VAL | PHYS | PHYS VAL | FUNC | TRUE VAL |
|-----------|-------|------|------|-------|-------|-----|------|-----|-----------|------|----------|------|----------|
| DWELLING | | SK | | | | | | | | | | | |
| 1 | | | | | | | | | | | | | |
| 2 | | | | | | | | | | | | | |
| 3 | | | | | | | | | | | | | |
| 4 | | | | | | | | | | | | | |
| 5 | | | | | | | | | | | | | |
| 6 | | | | | | | | | | | | | |
| 7 | | | | | | | | | | | | | |
| 8 | | | | | | | | | | | | | |
| 9 | | | | | | | | | | | | | |
| 10 | | | | | | | | | | | | | |
| 11 | | | | | | | | | | | | | |

30-032600.0000

TOTAL 0

COMMENTS

LIBERTY TWP / PARKWAY SD

04-20-100-002

Property Class: 111

Neighborhood

009301-A100



30-032600.0000

Map:

Block:

Card:

Bk:

Pg:

LEGAL INFORMATION

S1/2 NW

RTS: 001-05-20

Acres:4.0000

QUALIFIED CREDITS: CAUV:

06809: 2021

| | OWNERSHIP | ADDRESS | CITY | STATE | ZIP | DATE | AMOUNT | DEED:CONV# | JS | VALID |
|---|--------------------|---------------|--------|-------|-------|------------|---------|------------|--------------------------|-------------------------------------|
| 1 | EISCHEN TREVOR | 8328 ST RT 49 | CELINA | OH | 45822 | 05/07/2020 | 120,000 | FDC : 287 | <input type="checkbox"/> | <input checked="" type="checkbox"/> |
| 2 | MUHLENKAMP WILLIAM | 7911 ST RT 49 | CELINA | OH | 45822 | 10/05/1984 | 104,000 | : A : 0 | <input type="checkbox"/> | <input type="checkbox"/> |
| 3 | | | | | | | 0 | 0 | <input type="checkbox"/> | <input type="checkbox"/> |

X: TTO LISTER: HK DATE: 07/03/2023 TIME: 12:00:00 AM LETTER LETTER REC'D GIS CODE

| STREET/ROAD | | TOPOGRAPHY | | PU-UTILITIES-PR | | NEIGHBORHOOD | | INFLUENCE FACTORS | | | | PROPERTY LOCATION | |
|---|---|--|------------------------------------|--------------------------------------|---|-------------------|--|-------------------|--|--|--|-------------------|--|
| <input checked="" type="checkbox"/> PAVED | <input checked="" type="checkbox"/> LEVEL | <input type="checkbox"/> WATER | <input type="checkbox"/> IMPROVING | <input type="checkbox"/> A. NO ROAD | <input type="checkbox"/> F. RESTRICT | ST RTE 49, CELINA | | | | | | | |
| <input type="checkbox"/> GRAVEL | <input type="checkbox"/> HIGH | <input type="checkbox"/> SEWER | <input type="checkbox"/> STATIC | <input type="checkbox"/> B. TOPGRHY | <input type="checkbox"/> G. WOOD LT | COMMENT | | | | | | | |
| <input type="checkbox"/> DIRT | <input type="checkbox"/> LOW | <input type="checkbox"/> GAS | <input type="checkbox"/> DECLINING | <input type="checkbox"/> C. Ex Front | <input type="checkbox"/> H. VACANCY | | | | | | | | |
| <input type="checkbox"/> SIDEWALKS | <input type="checkbox"/> ROLLING | <input type="checkbox"/> ELECTRIC | <input type="checkbox"/> OLD | <input type="checkbox"/> D. QUANTITY | <input type="checkbox"/> I. WATER FRONT | | | | | | | | |
| <input type="checkbox"/> CURBS | <input type="checkbox"/> STANDARD | <input checked="" type="checkbox"/> STANDARD | <input type="checkbox"/> STANDARD | <input type="checkbox"/> E. SZ/SHAPE | <input type="checkbox"/> J. OTHER/CDU | | | | | | | | |

LAND COMPUTATIONS

| LAND TYPE | SIZE | M | RATE | C | INF | M | VALUE | C |
|---------------------|-------|--------|--------|---|-----|---|-------|---|
| | | | | | | | | |
| | | | | | | | | |
| | | | | | | | | |
| | | | | | | | | |
| | | | | | | | | |
| | | | | | | | | |
| | | | | | | | | |
| Total Acres: 4.0000 | TOTAL | 57,250 | 32,660 | | | | | |

VALUATION SUMMARY

| VALUE YEAR | 2018 | 2018 | 2017 | 2017 | | | |
|-------------------|---|---------|---------|---------|---------|--|--|
| REASON FOR CHANGE | CAUV | MISC | CAUV | RAPP | | | |
| APPRAISED VALUE | LAND | 197,540 | 672,920 | 198,500 | 675,760 | | |
| | IMPR | 48,200 | 48,200 | 48,200 | 48,200 | | |
| | TOTAL | 245,740 | 721,120 | 246,700 | 723,960 | | |
| ASSESSED VALUE | LAND | 69,140 | 235,520 | 69,480 | 236,520 | | |
| | IMPR | 16,870 | 16,870 | 16,870 | 16,870 | | |
| | TOTAL | 86,010 | 252,390 | 86,350 | 253,390 | | |
| POTENTIAL RECOUP | 2022=320.74, 2021=315.89, 2020=320.25: Total=956.88 | | | | | | |

| OCCUPANCY | EXTERIOR | FLOOR | AREA | CONST | VALUE |
|---|-----------------------------------|-------|------|-------|-------|
| <input type="checkbox"/> SF <input type="checkbox"/> DU <input type="checkbox"/> TR | <input type="checkbox"/> WOOD | | | | |
| <input type="checkbox"/> CONVERSION | <input type="checkbox"/> STUCCO | | | | |
| BUILDING TYPE | <input type="checkbox"/> ALM/VYNL | | | | |
| <input type="checkbox"/> MOBILE HOME | <input type="checkbox"/> CONC BLK | | | | |
| <input type="checkbox"/> BI/TR LEVEL | <input type="checkbox"/> METAL | | | | |
| <input type="checkbox"/> MOD/MAN | <input type="checkbox"/> BRICK | | | | |
| <input type="checkbox"/> | <input type="checkbox"/> STONE | | | | |

| ROOFING | ROOF TYPE |
|------------------------------------|----------------------------------|
| <input type="checkbox"/> METAL | <input type="checkbox"/> GABLE |
| <input type="checkbox"/> SLT/TLE | <input type="checkbox"/> HIP |
| <input type="checkbox"/> SHINGLES | <input type="checkbox"/> GAMBREL |
| <input type="checkbox"/> SHAKES | <input type="checkbox"/> MANSARD |
| <input type="checkbox"/> COMPOSITE | <input type="checkbox"/> FLAT |

| FLOORS | B | 1 | 2 | 3 | U |
|----------------|--------------------------|--------------------------|--------------------------|--------------------------|-------------------------------|
| CONCRETE | <input type="checkbox"/> | <input type="checkbox"/> | <input type="checkbox"/> | <input type="checkbox"/> | <input type="checkbox"/> |
| WOOD | <input type="checkbox"/> | <input type="checkbox"/> | <input type="checkbox"/> | <input type="checkbox"/> | <input type="checkbox"/> |
| TILE/COMPO | <input type="checkbox"/> | <input type="checkbox"/> | <input type="checkbox"/> | <input type="checkbox"/> | <input type="checkbox"/> |
| CARPET | <input type="checkbox"/> | <input type="checkbox"/> | <input type="checkbox"/> | <input type="checkbox"/> | <input type="checkbox"/> |
| INT. FINISH | B | 1 | 2 | 3 | U |
| PLASTER/DW | <input type="checkbox"/> | <input type="checkbox"/> | <input type="checkbox"/> | <input type="checkbox"/> | <input type="checkbox"/> |
| PANELING | <input type="checkbox"/> | <input type="checkbox"/> | <input type="checkbox"/> | <input type="checkbox"/> | <input type="checkbox"/> |
| UNFINISHED | <input type="checkbox"/> | <input type="checkbox"/> | <input type="checkbox"/> | <input type="checkbox"/> | <input type="checkbox"/> |
| ACCOMMODATIONS | | | | | |
| # OF ROOMS | | | | | |
| BEDROOMS | | | | | |
| FIREPLACES | | | | | |
| HEAT & AC | B | 1 | 2 | 3 | U |
| NO HEAT | <input type="checkbox"/> | <input type="checkbox"/> | <input type="checkbox"/> | <input type="checkbox"/> | <input type="checkbox"/> |
| CTRL HEAT | <input type="checkbox"/> | <input type="checkbox"/> | <input type="checkbox"/> | <input type="checkbox"/> | <input type="checkbox"/> |
| HW/STEAM | <input type="checkbox"/> | <input type="checkbox"/> | <input type="checkbox"/> | <input type="checkbox"/> | <input type="checkbox"/> |
| ELECTRIC | <input type="checkbox"/> | <input type="checkbox"/> | <input type="checkbox"/> | <input type="checkbox"/> | <input type="checkbox"/> |
| HEAT PUMP | <input type="checkbox"/> | <input type="checkbox"/> | <input type="checkbox"/> | <input type="checkbox"/> | <input type="checkbox"/> |
| FLR/WALL | <input type="checkbox"/> | <input type="checkbox"/> | <input type="checkbox"/> | <input type="checkbox"/> | <input type="checkbox"/> |
| STVE/SPCE | <input type="checkbox"/> | <input type="checkbox"/> | <input type="checkbox"/> | <input type="checkbox"/> | <input type="checkbox"/> |
| GEO THERMAL | <input type="checkbox"/> | <input type="checkbox"/> | <input type="checkbox"/> | <input type="checkbox"/> | <input type="checkbox"/> |
| OUTSIDE | <input type="checkbox"/> | <input type="checkbox"/> | <input type="checkbox"/> | <input type="checkbox"/> | <input type="checkbox"/> |
| CTRL A/C | <input type="checkbox"/> | <input type="checkbox"/> | <input type="checkbox"/> | <input type="checkbox"/> | <input type="checkbox"/> |
| PLUMBING | | | | | BASE <input type="checkbox"/> |
| X FULL BATH | | | | | |
| X HALF BATH | | | | | |
| X FIXTURES | | | | | |

| | | |
|-------------------------|--------|---|
| SUBTOTAL | | 0 |
| MULTI-FAMILY # | 0 | 0 |
| BUILDING TYPE | 000% | 0 |
| BSMT FINISH | 0 S.F. | 0 |
| FIREPLACE # | 0 | 0 |
| HEATING | 0 S.F. | 0 |
| AIR COND | 0 S.F. | 0 |
| PLUMBING # | 0 | 0 |
| GARAGES & CARPORTS | | 0 |
| EXTRA FEATURES | | 0 |
| SUBTOTAL | | 0 |
| GRADE FACTOR | | % |
| UNADJUSTED VALUE | | 0 |
| FACTOR | | % |

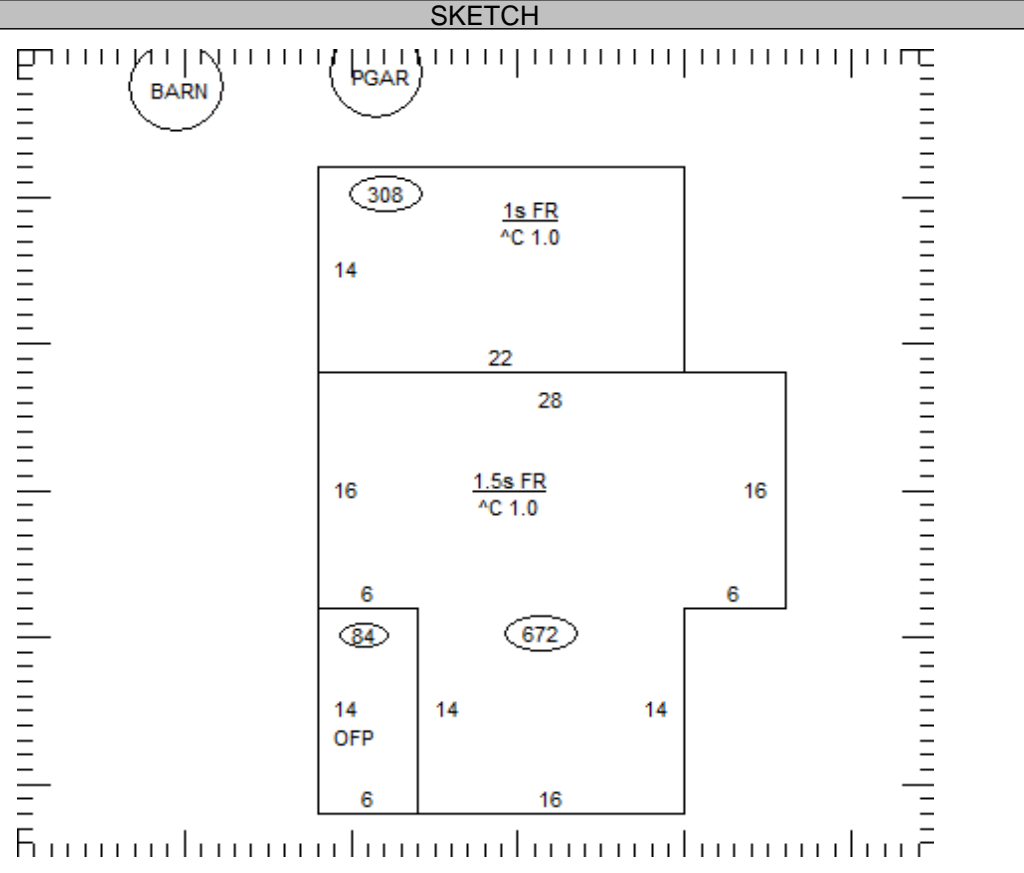

| OCCUPANCY | ST.HT | SIZE | AREA | GRADE | PRICE | AGE | REMD | CND | UNADJ VAL | PHYS | PHYS VAL | FUNC | TRUE VAL |
|-----------|-------|------|------|-------|-------|-----|------|-----|-----------|------|----------|------|----------|
| DWELLING | | SK | | | | | | | | | | | |
| 1 | | | | | | | | | | | | | |
| 2 | | | | | | | | | | | | | |
| 3 | | | | | | | | | | | | | |
| 4 | | | | | | | | | | | | | |
| 5 | | | | | | | | | | | | | |
| 6 | | | | | | | | | | | | | |
| 7 | | | | | | | | | | | | | |
| 8 | | | | | | | | | | | | | |
| 9 | | | | | | | | | | | | | |
| 10 | | | | | | | | | | | | | |
| 11 | | | | | | | | | | | | | |

30-032600.0000

TOTAL 0

COMMENTS