

OCCUPANCY SF DU TR
 CONVERSION
BUILDING TYPE
 MOBILE HOME
 BI/TR LEVEL
 MOD/MAN

FLOOR	AREA	CONST	VALUE
1	1566	FR	205,940

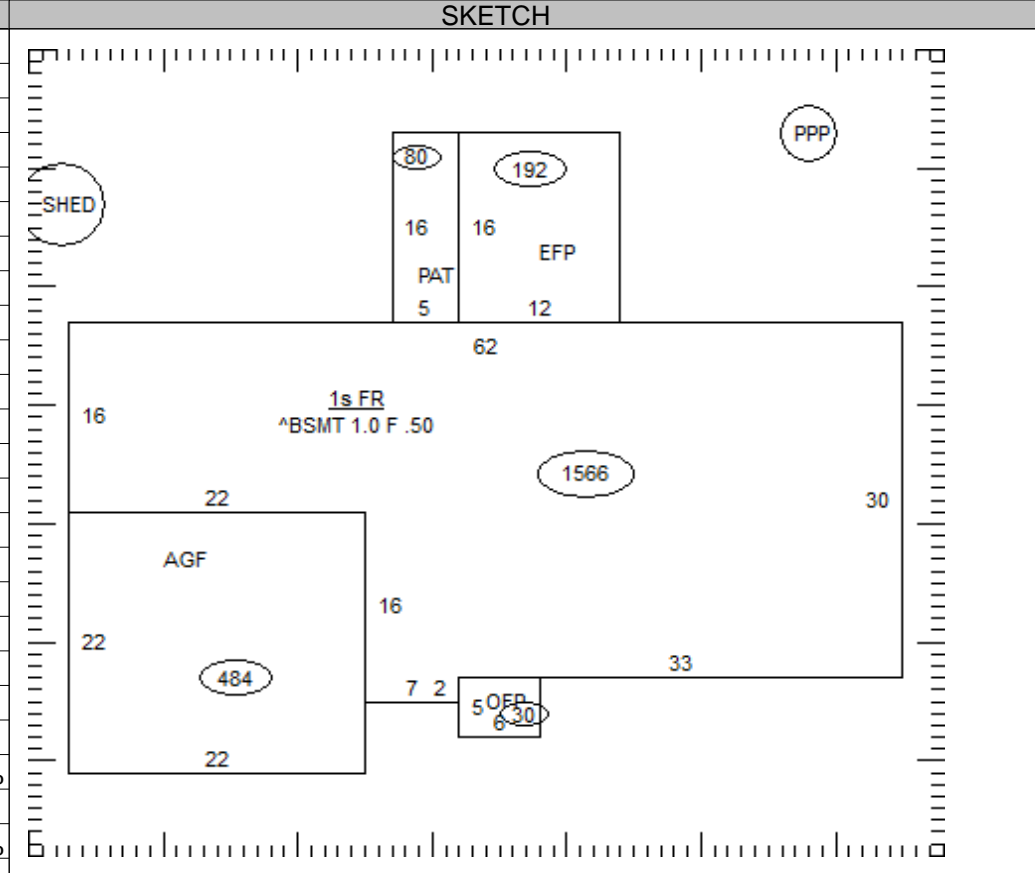

ROOFING
 METAL
 SLT/TLE
 SHINGLES
 SHAKES
 COMPOSITE

ROOF TYPE
 WOOD
 STUCCO
 ALM/VYNL
 CONC BLK
 METAL
 BRICK
 STONE

FLOOR	AREA	CONST	VALUE
BSMT	1566		22,390
SUBTOTAL			228,330

FLOORS B 1 2 3 U
 CONCRETE
 WOOD
 TILE/COMPO
 CARPET

MULTI-FAMILY #	0	0	
BUILDING TYPE	100%	0	
BSMT FINISH	783 S.F.	11,200	
FIREPLACE #	0	0	
HEATING	0 S.F.	0	
AIR COND	1,566 S.F.	2,580	
PLUMBING #	4	4,840	
GARAGES & CARPORTS		12,000	
EXTRA FEATURES		6,400	
SUBTOTAL			265,350

INT. FINISH B 1 2 3 U
 PLASTER/DW
 PANELING
 UNFINISHED

GRADE FACTOR		105 %
UNADJUSTED VALUE		278,620
FACTOR		100 %

ACCOMMODATIONS
 # OF ROOMS 1 7
 BEDROOMS 3
 FIREPLACES
 HEAT & AC B 1 2 3 U

OCCUPANCY	ST.HT	SIZE	AREA	GRADE	PRICE	AGE	REMD	CND	UNADJ VAL	PHYS	PHYS VAL	FUNC	TRUE VAL
DWELLING	1	SK	1,566	C+		1990		A	278,620	26	206,180		195,900
1 Pool - PP		15x15	225	C		2000		A		37			0
2 Shed		10x16	160	C	9.90	2018		A	1,580	5	1,500		1,500
3													
4													
5													
6													
7													
8													
9													
10													
11													

NO HEAT
 CTRL HEAT
 HW/STEAM
 ELECTRIC
 HEAT PUMP
 FLR/WALL
 STVE/SPCE
 GEOTHERMAL
 OUTSIDE
 CTRL A/C

OCCUPANCY	ST.HT	SIZE	AREA	GRADE	PRICE	AGE	REMD	CND	UNADJ VAL	PHYS	PHYS VAL	FUNC	TRUE VAL
DWELLING	1	SK	1,566	C+		1990		A	278,620	26	206,180		195,900
1 Pool - PP		15x15	225	C		2000		A		37			0
2 Shed		10x16	160	C	9.90	2018		A	1,580	5	1,500		1,500
3													
4													
5													
6													
7													
8													
9													
10													
11													

PLUMBING BASE
 X FULL BATH 1
 X HALF BATH
 X FIXTURES 1

27-469600.0000	TOTAL	197,400
----------------	--------------	---------

COMMENTS

40 L/F BRICK TRIM 8' HIGH
 Dwelling has an Economic Factor of 95% (Rollback Basis=\$238,000)