



**OCCUPANCY**  
 SF  DU  TR  
 CONVERSION  
**BUILDING TYPE**  
 MOBILE HOME  
 BI/TR LEVEL  
 MOD/MAN  
 \_\_\_\_\_

**EXTERIOR**  
 WOOD  
 STUCCO  
 ALM/VYNL  
 CONC BLK  
 METAL  
 BRICK  
 STONE

**ROOFING**  
 METAL  
 SLT/TLE  
 SHINGLES  
 SHAKES  
 COMPOSITE

**ROOF TYPE**  
 GABLE  
 HIP  
 GAMBREL  
 MANSARD  
 FLAT

**FLOORS** B 1 2 3 U  
 CONCRETE       
 WOOD       
 TILE/COMPO       
 CARPET

**INT. FINISH** B 1 2 3 U  
 PLASTER/DW       
 PANELING       
 UNFINISHED

**ACCOMMODATIONS**  
 # OF ROOMS 5  
 BEDROOMS 3  
 FIREPLACES  
 HEAT & AC B 1 2 3 U

NO HEAT       
 CTRL HEAT       
 HW/STEAM       
 ELECTRIC       
 HEAT PUMP       
 FLR/WALL       
 STVE/SPCE       
 GEOTHERMAL       
 OUTSIDE       
 CTRL A/C

**PLUMBING** BASE   
 X FULL BATH 1  
 X HALF BATH  
 X FIXTURES

FLOOR	AREA	CONST	VALUE
1	1166	FR	175,680
<b>SUBTOTAL</b>			175,680
MULTI-FAMILY #	0		0
BUILDING TYPE	100%		0
BSMT FINISH	0 S.F.		0
FIREPLACE #	0		0
HEATING	0 S.F.		0
AIR COND	1,166 S.F.		1,920
PLUMBING #	3		3,630
GARAGES & CARPORTS			9,700
EXTRA FEATURES			3,900
<b>SUBTOTAL</b>			194,830
<b>GRADE FACTOR</b>			105 %
<b>UNADJUSTED VALUE</b>			204,570
<b>FACTOR</b>			100 %

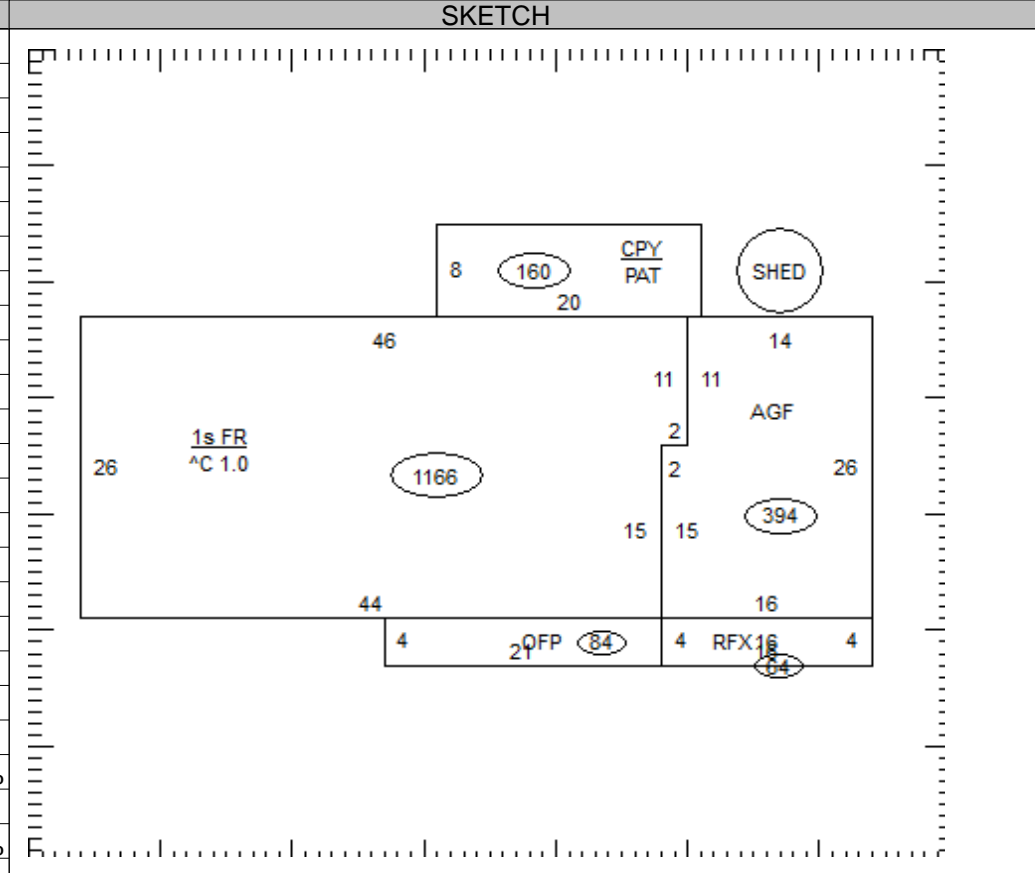

OCCUPANCY	ST.HT	SIZE	AREA	GRADE	PRICE	AGE	REMD	CND	UNADJ VAL	PHYS	PHYS VAL	FUNC	TRUE VAL
DWELLING	1	SK	1,166	C+		1962		A	204,570	42	118,650		112,700
1 Shed		6x6	36	C		2020		A		3			0
2													
3													
4													
5													
6													
7													
8													
9													
10													
11													

27-451800.0000

TOTAL 112,700

**COMMENTS**  
 11 L/F OF BRICK TRIM-6' HIGH  
 Dwelling has an Economic Factor of 95%