

OCCUPANCY
 SF DU TR
 CONVERSION

BUILDING TYPE
 MOBILE HOME
 BI/TR LEVEL
 MOD/MAN

FLOOR	AREA	CONST	VALUE
1	832	FR	140,470
BSMT	832		11,900
SUBTOTAL			152,370

ROOFING
 METAL
 SLT/TLE
 SHINGLES
 SHAKES
 COMPOSITE

ROOF TYPE
 GABLE
 HIP
 GAMBREL
 MANSARD
 FLAT

FLOORS B 1 2 3 U
 CONCRETE
 WOOD
 TILE/COMPO
 CARPET

INT. FINISH B 1 2 3 U
 PLASTER/DW
 PANELING
 UNFINISHED

ACCOMMODATIONS
 # OF ROOMS 2 5
 BEDROOMS 3
 FIREPLACES
 HEAT & AC B 1 2 3 U

NO HEAT
 CTRL HEAT
 HW/STEAM
 ELECTRIC
 HEAT PUMP
 FLR/WALL
 STVE/SPCE
 GEOTHERMAL
 OUTSIDE
 CTRL A/C

PLUMBING BASE
 X FULL BATH
 X HALF BATH 1
 X FIXTURES 1

OCCUPANCY	ST.HT	SIZE	AREA	GRADE	PRICE	AGE	REMD	CND	UNADJ VAL	PHYS	PHYS VAL	FUNC	TRUE VAL
DWELLING	1	SK	832	C		1965		A	172,810	40	103,690		103,700
1 Shed	PP	6x8	48	C		2000		A		37			0
2													
3													
4													
5													
6													
7													
8													
9													
10													
11													

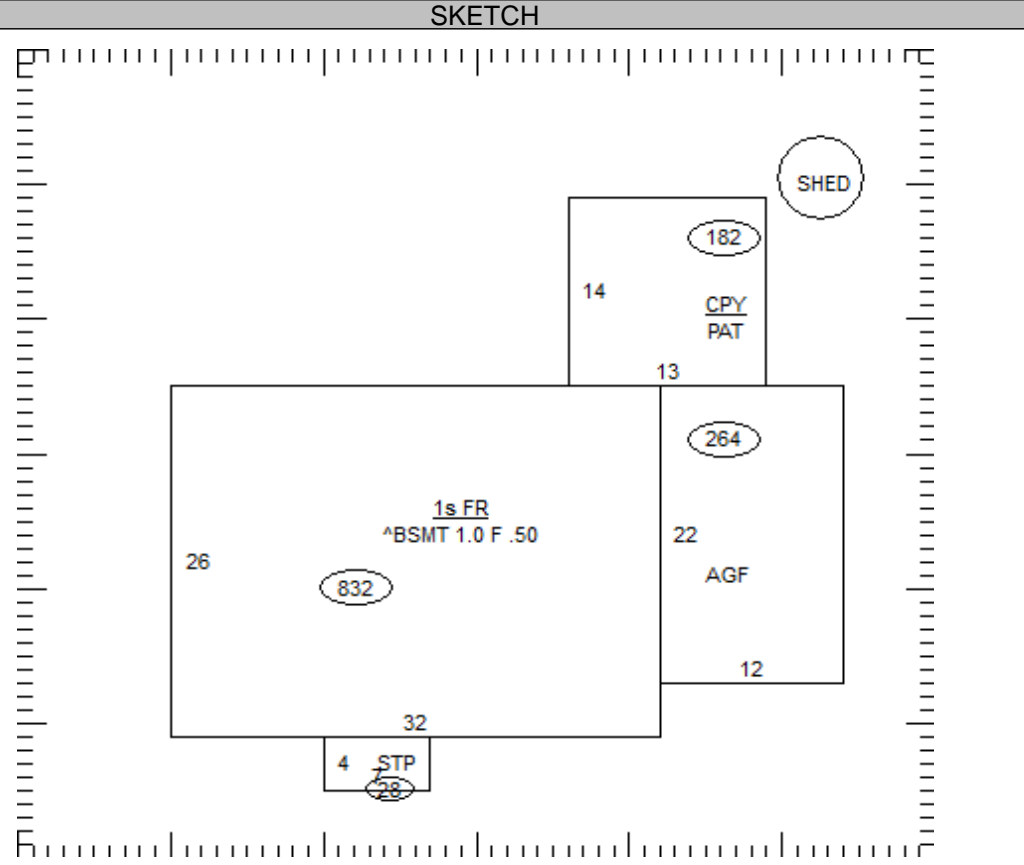

27-416700.0000

TOTAL 103,700

COMMENTS

Dwelling has an Economic Factor of 100%