

27-376400.0000

BROOKMAN TREVOR A
 BROOKMAN TREVOR A
 220 LINCOLN DR
 CELINA, OH 45822

LEGAL INFORMATION
 FAIRLAWN HEIGHTS SUBD
 ALSO N SD LOT 50
 LOT#: 51

| | OWNERSHIP | ADDRESS | CITY | STATE | ZIP | DATE | AMOUNT | DEED:CONV# | JS | VALID |
|---|-------------------------|----------------|--------|-------|-------|------------|---------|-------------|--------------------------|-------------------------------------|
| 1 | BROOKMAN TREVOR A | 220 LINCOLN DR | CELINA | OH | 45822 | 06/22/2020 | 143,000 | WDC : 382 | <input type="checkbox"/> | <input checked="" type="checkbox"/> |
| 2 | WALE THOMAS M & CANDY K | 8261 WEITZ RD | CELINA | OH | 45822 | 09/27/2019 | 70,500 | WDC : 650 | <input type="checkbox"/> | <input checked="" type="checkbox"/> |
| 3 | JOHNSON MARTHA J | 220 LINCOLN DR | CELINA | OH | 45822 | 04/19/2012 | 0 | QCE : X : 0 | <input type="checkbox"/> | <input type="checkbox"/> |

X: TTO LISTER: DF DATE: 05/10/2005 TIME: 12:00:00 AM LETTER LETTER REC'D GIS CODE

| STREET/ROAD | TOPOGRAPHY | PU-UTILITIES-PR | NEIGHBORHOOD | INFLUENCE FACTORS | PROPERTY LOCATION |
|---|---|--|--|--------------------------------------|--|
| <input checked="" type="checkbox"/> PAVED | <input checked="" type="checkbox"/> LEVEL | <input type="checkbox"/> WATER | <input type="checkbox"/> IMPROVING | <input type="checkbox"/> A. NO ROAD | 220 LINCOLN DR, CELINA |
| <input type="checkbox"/> GRAVEL | <input type="checkbox"/> HIGH | <input type="checkbox"/> SEWER | <input checked="" type="checkbox"/> STATIC | <input type="checkbox"/> F. RESTRICT | COMMENT TY2022:Net Gen=\$1,933.66, Other Assessment=\$0.00 |
| <input type="checkbox"/> DIRT | <input type="checkbox"/> LOW | <input type="checkbox"/> GAS | <input type="checkbox"/> DECLINING | <input type="checkbox"/> B. TOPGRHY | |
| <input type="checkbox"/> SIDEWALKS | <input type="checkbox"/> ROLLING | <input type="checkbox"/> ELECTRIC | <input type="checkbox"/> OLD | <input type="checkbox"/> C. Ex Front | |
| <input type="checkbox"/> CURBS | <input type="checkbox"/> STANDARD | <input checked="" type="checkbox"/> STANDARD | <input type="checkbox"/> STANDARD | <input type="checkbox"/> D. QUANTITY | |
| | | | | <input type="checkbox"/> E. SZ/SHAPE | |

| LAND COMPUTATIONS | | | | | | |
|-------------------|-----------|-------|------|--------|-----|-----------|
| LAND TYPE | SIZE | M | RATE | C | INF | M VALUE C |
| F:Front | F120 D110 | ST290 | DP85 | ADJ247 | | 29,600 0 |
| | | | | | | |
| | | | | | | |
| | | | | | | |
| | | | | | | |
| | | | | | | |
| | | | | | | |
| TOTAL | | | | | | 29,600 0 |

VALUATION SUMMARY

| VALUE YEAR | 2023 | 2020 | 2017 | | | | |
|-------------------|-------|---------|---------|---------|--|--|--|
| REASON FOR CHANGE | RAPP | RAPP | RAPP | | | | |
| APPRAISED | LAND | 29,600 | 28,700 | 25,600 | | | |
| VALUE | IMPR | 137,600 | 93,600 | 79,800 | | | |
| | TOTAL | 167,200 | 122,300 | 105,400 | | | |
| ASSESSED | LAND | 10,360 | 10,050 | 8,960 | | | |
| VALUE | IMPR | 48,160 | 32,760 | 27,930 | | | |
| | TOTAL | 58,520 | 42,810 | 36,890 | | | |

OCCUPANCY
 SF DU TR
 CONVERSION
BUILDING TYPE
 MOBILE HOME
 BI/TR LEVEL
 MOD/MAN

EXTERIOR
 WOOD
 STUCCO
 ALM/VYNL
 CONC BLK
 METAL
 BRICK
 STONE

ROOFING
 METAL
 SLT/TLE
 SHINGLES
 SHAKES
 COMPOSITE

ROOF TYPE
 GABLE
 HIP
 GAMBREL
 MANSARD
 FLAT

FLOORS B 1 2 3 U
 CONCRETE
 WOOD
 TILE/COMPO
 CARPET

INT. FINISH B 1 2 3 U
 PLASTER/DW
 PANELING
 UNFINISHED

ACCOMMODATIONS
 # OF ROOMS 6
 BEDROOMS 3
 FIREPLACES 1

HEAT & AC B 1 2 3 U
 NO HEAT
 CTRL HEAT
 HW/STEAM
 ELECTRIC
 HEAT PUMP
 FLR/WALL
 STVE/SPCE
 GEOTHERMAL
 OUTSIDE
 CTRL A/C

PLUMBING BASE
 X FULL BATH 1
 X HALF BATH
 X FIXTURES

| FLOOR | AREA | CONST | VALUE |
|-------------------------|--------|-------|---------|
| 1 | 1260 | BRK | 196,130 |
| SUBTOTAL | | | 196,130 |
| MULTI-FAMILY # | 0 | | 0 |
| BUILDING TYPE | 100% | | 0 |
| BSMT FINISH | 0 S.F. | | 0 |
| FIREPLACE # | 1 | | 4,400 |
| HEATING | 0 S.F. | | 0 |
| AIR COND | 0 S.F. | | 0 |
| PLUMBING # | 3 | | 3,630 |
| GARAGES & CARPORTS | | | 11,200 |
| EXTRA FEATURES | | | 1,100 |
| SUBTOTAL | | | 216,460 |
| GRADE FACTOR | | | 105 % |
| UNADJUSTED VALUE | | | 227,280 |
| FACTOR | | | 100 % |

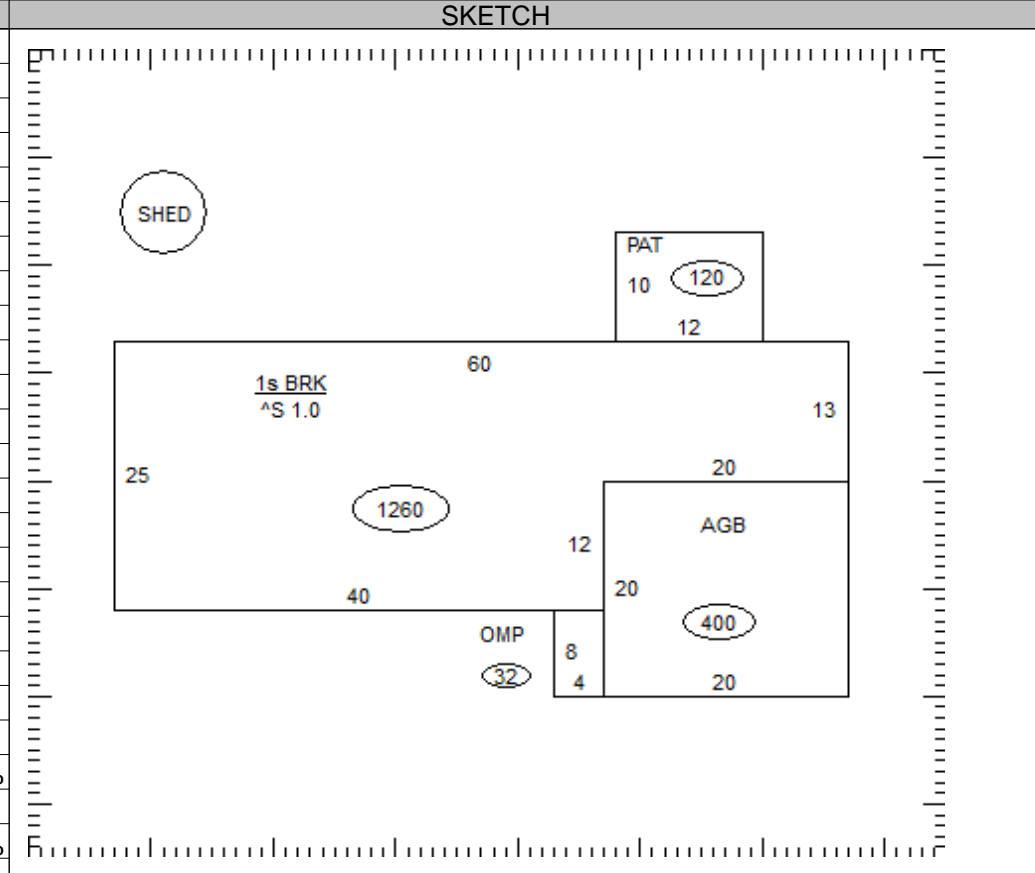

| OCCUPANCY | ST.HT | SIZE | AREA | GRADE | PRICE | AGE | REMD | CND | UNADJ VAL | PHYS | PHYS VAL | FUNC | TRUE VAL |
|-----------|-------|-------|-------|-------|-------|------|------|-----|-----------|------|----------|------|----------|
| DWELLING | 1 | SK | 1,260 | C+ | | 1980 | | A | 227,280 | 30 | 159,100 | | 136,800 |
| 1 Shed | 10 | 12x16 | 192 | D | 7.92 | 1995 | | A | 1,520 | 48 | 790 | | 800 |
| 2 | | | | | | | | | | | | | |
| 3 | | | | | | | | | | | | | |
| 4 | | | | | | | | | | | | | |
| 5 | | | | | | | | | | | | | |
| 6 | | | | | | | | | | | | | |
| 7 | | | | | | | | | | | | | |
| 8 | | | | | | | | | | | | | |
| 9 | | | | | | | | | | | | | |
| 10 | | | | | | | | | | | | | |
| 11 | | | | | | | | | | | | | |

27-376400.0000 TOTAL 137,600

COMMENTS

Dwelling has an Economic Factor of 86% (Rollback Basis=\$166,400)

JEFFERSON TWP-CELINA CORP / CELINA SD

05-36-327-006

Property Class: 510

Neighborhood

27502701-03 -

Map: 01 D

Block:

Card: 07

Bk: Pg:

27-376400.0000

BROOKMAN TREVOR A
 BROOKMAN TREVOR A
 220 LINCOLN DR
 CELINA, OH 45822

LEGAL INFORMATION
 FAIRLAWN HEIGHTS SUBD
 ALSO N SD LOT 50
 LOT#: 51

| | OWNERSHIP | ADDRESS | CITY | STATE | ZIP | DATE | AMOUNT | DEED:CONV# | JS | VALID |
|---|--------------------|----------------|--------|-------|-------|------|--------|------------|--------------------------|--------------------------|
| 1 | JOHNSON LESTER L & | 220 LINCOLN DR | CELINA | OH | 45822 | | 0 | :0 | <input type="checkbox"/> | <input type="checkbox"/> |
| 2 | | | | | | | 0 | 0 | <input type="checkbox"/> | <input type="checkbox"/> |
| 3 | | | | | | | 0 | 0 | <input type="checkbox"/> | <input type="checkbox"/> |

X: TTO LISTER: DF DATE: 05/10/2005 TIME: 12:00:00 AM LETTER LETTER REC'D GIS CODE

| STREET/ROAD | TOPOGRAPHY | PU-UTILITIES-PR | NEIGHBORHOOD | INFLUENCE FACTORS | PROPERTY LOCATION |
|---|---|--|--|--|------------------------|
| <input checked="" type="checkbox"/> PAVED | <input checked="" type="checkbox"/> LEVEL | <input type="checkbox"/> WATER <input type="checkbox"/> | <input type="checkbox"/> IMPROVING | <input type="checkbox"/> A. NO ROAD <input type="checkbox"/> F. RESTRICT | 220 LINCOLN DR, CELINA |
| <input type="checkbox"/> GRAVEL | <input type="checkbox"/> HIGH | <input type="checkbox"/> SEWER <input type="checkbox"/> | <input checked="" type="checkbox"/> STATIC | <input type="checkbox"/> B. TOPGRHY <input type="checkbox"/> G. WOOD LT | COMMENT |
| <input type="checkbox"/> DIRT | <input type="checkbox"/> LOW | <input type="checkbox"/> GAS <input type="checkbox"/> | <input type="checkbox"/> DECLINING | <input type="checkbox"/> C. Ex Front <input type="checkbox"/> H. VACANCY | |
| <input type="checkbox"/> SIDEWALKS | <input type="checkbox"/> ROLLING | <input type="checkbox"/> ELECTRIC <input type="checkbox"/> | <input type="checkbox"/> OLD | <input type="checkbox"/> D. QUANTITY <input type="checkbox"/> I. WATER FRONT | |
| <input type="checkbox"/> CURBS | <input type="checkbox"/> STANDARD | <input checked="" type="checkbox"/> STANDARD | <input type="checkbox"/> STANDARD | <input type="checkbox"/> E. SZ/SHAPE <input type="checkbox"/> J. OTHER/CDU | |

| LAND COMPUTATIONS | | | | | | | |
|-------------------|------|---|------|---|-------|---|----------|
| LAND TYPE | SIZE | M | RATE | C | INF | M | VALUE C |
| | | | | | | | |
| | | | | | | | |
| | | | | | | | |
| | | | | | | | |
| | | | | | | | |
| | | | | | | | |
| | | | | | | | |
| | | | | | | | |
| | | | | | | | |
| | | | | | TOTAL | | 29,600 0 |

VALUATION SUMMARY

| VALUE YEAR | | | | | | | |
|-------------------|--------------|--|--|--|--|--|--|
| REASON FOR CHANGE | | | | | | | |
| APPRAISED VALUE | <u>LAND</u> | | | | | | |
| | <u>IMPR</u> | | | | | | |
| | <u>TOTAL</u> | | | | | | |
| ASSESSED VALUE | <u>LAND</u> | | | | | | |
| | <u>IMPR</u> | | | | | | |
| | <u>TOTAL</u> | | | | | | |

