



27-361800.0000

PIPER SCOTT R & JOAN M
PIPER SCOTT R & JOAN M
7745 ST RTE 197
CELINA, OH 45822

JEFFERSON TWP-CELINA CORP / CELINA SD

05-36-452-021

Page 1 of 1
Property Class: 510
Neighborhood
27502703-01 -
Map: 01F
Block:
Card: 39
Bk: Pg:

LEGAL INFORMATION
CITIZENS ADD BLOCK 7

LOT#: 18

Table with columns: OWNERSHIP, ADDRESS, CITY, STATE, ZIP, DATE, AMOUNT, DEED:CONV#, JS, VALID. Contains 3 rows of property records.

X: [] TTO LISTER: DF DATE: 05/13/2005 TIME: 12:00:00 AM [] LETTER [] LETTER REC'D GIS CODE

Table with columns: STREET/ROAD, TOPOGRAPHY, PU-UTILITIES-PR, NEIGHBORHOOD, INFLUENCE FACTORS, PROPERTY LOCATION. Includes checkboxes for various features like PAVED, LEVEL, WATER, etc.

Table with columns: LAND TYPE, SIZE, M, RATE, C, INF, M, VALUE, C. Includes a row for 'F:Front' and a 'TOTAL' row.

511 HOYING ST, CELINA
COMMENT
TY2022:Net Gen=\$1,238.26, Other
Assessment=\$0.00
DE20 RMV OWN OCC; DID NOT RETURN APP
DE22 RMV BSMNT FIN PER DATA MAILER

VALUATION SUMMARY

Table with columns: VALUE YEAR, REASON FOR CHANGE, APPRAISED VALUE, ASSESSED VALUE. Includes sub-columns for LAND, IMPR, and TOTAL for years 2023, 2022, 2020, and 2017.

OCCUPANCY	EXTERIOR	FLOOR	AREA	CONST	VALUE
<input checked="" type="checkbox"/> SF <input type="checkbox"/> DU <input type="checkbox"/> TR	<input type="checkbox"/> WOOD	1	928	FR	152,070
<input type="checkbox"/> CONVERSION	<input type="checkbox"/> STUCCO	.25	108	FR	16,210
BUILDING TYPE	<input checked="" type="checkbox"/> ALM/VYNL				
<input type="checkbox"/> MOBILE HOME	<input type="checkbox"/> CONC BLK				
<input type="checkbox"/> BI/TR LEVEL	<input type="checkbox"/> METAL				
<input type="checkbox"/> MOD/MAN	<input type="checkbox"/> BRICK				
<input type="checkbox"/>	<input type="checkbox"/> STONE				

ROOFING	ROOF TYPE
<input type="checkbox"/> METAL	<input checked="" type="checkbox"/> GABLE
<input type="checkbox"/> SLT/TLE	<input type="checkbox"/> HIP
<input checked="" type="checkbox"/> SHINGLES	<input type="checkbox"/> GAMBREL
<input type="checkbox"/> SHAKES	<input type="checkbox"/> MANSARD
<input type="checkbox"/> COMPOSITE	<input type="checkbox"/> FLAT

FLOORS	B	1	2	3	U
CONCRETE	<input type="checkbox"/>	<input type="checkbox"/>	<input type="checkbox"/>	<input type="checkbox"/>	<input type="checkbox"/>
WOOD	<input type="checkbox"/>	<input checked="" type="checkbox"/>	<input checked="" type="checkbox"/>	<input type="checkbox"/>	<input type="checkbox"/>
TILE/COMPO	<input type="checkbox"/>	<input type="checkbox"/>	<input type="checkbox"/>	<input type="checkbox"/>	<input type="checkbox"/>
CARPET	<input checked="" type="checkbox"/>	<input checked="" type="checkbox"/>	<input checked="" type="checkbox"/>	<input type="checkbox"/>	<input type="checkbox"/>
INT. FINISH	B	1	2	3	U
PLASTER/DW	<input type="checkbox"/>	<input checked="" type="checkbox"/>	<input checked="" type="checkbox"/>	<input type="checkbox"/>	<input type="checkbox"/>
PANELING	<input checked="" type="checkbox"/>	<input checked="" type="checkbox"/>	<input type="checkbox"/>	<input type="checkbox"/>	<input type="checkbox"/>
UNFINISHED	<input type="checkbox"/>	<input type="checkbox"/>	<input type="checkbox"/>	<input type="checkbox"/>	<input type="checkbox"/>
ACCOMMODATIONS	# OF ROOMS	5	1		
BEDROOMS		2	1		
FIREPLACES					
HEAT & AC	B	1	2	3	U
NO HEAT	<input type="checkbox"/>	<input type="checkbox"/>	<input type="checkbox"/>	<input type="checkbox"/>	<input type="checkbox"/>
CTRL HEAT	<input checked="" type="checkbox"/>	<input checked="" type="checkbox"/>	<input checked="" type="checkbox"/>	<input type="checkbox"/>	<input type="checkbox"/>
HW/STEAM	<input type="checkbox"/>	<input type="checkbox"/>	<input type="checkbox"/>	<input type="checkbox"/>	<input type="checkbox"/>
ELECTRIC	<input type="checkbox"/>	<input type="checkbox"/>	<input type="checkbox"/>	<input type="checkbox"/>	<input type="checkbox"/>
HEAT PUMP	<input type="checkbox"/>	<input type="checkbox"/>	<input type="checkbox"/>	<input type="checkbox"/>	<input type="checkbox"/>
FLR/WALL	<input type="checkbox"/>	<input type="checkbox"/>	<input type="checkbox"/>	<input type="checkbox"/>	<input type="checkbox"/>
STVE/SPCE	<input type="checkbox"/>	<input type="checkbox"/>	<input type="checkbox"/>	<input type="checkbox"/>	<input type="checkbox"/>
GEO THERMAL	<input type="checkbox"/>	<input type="checkbox"/>	<input type="checkbox"/>	<input type="checkbox"/>	<input type="checkbox"/>
OUTSIDE	<input type="checkbox"/>	<input type="checkbox"/>	<input type="checkbox"/>	<input type="checkbox"/>	<input type="checkbox"/>
CTRL A/C	<input type="checkbox"/>	<input checked="" type="checkbox"/>	<input type="checkbox"/>	<input type="checkbox"/>	<input type="checkbox"/>
PLUMBING	BASE	<input checked="" type="checkbox"/>			
X FULL BATH					
X HALF BATH					
X FIXTURES					

BSMT	928		13,270
SUBTOTAL			181,550
MULTI-FAMILY #	0		0
BUILDING TYPE	100%		0
BSMT FINISH	0 S.F.		0
FIREPLACE #	0		0
HEATING	0 S.F.		0
AIR COND	928 S.F.		1,530
PLUMBING #	0		0
GARAGES & CARPORTS			5,400
EXTRA FEATURES			2,200
SUBTOTAL			190,680
GRADE FACTOR			100 %
UNADJUSTED VALUE			190,680
FACTOR			100 %

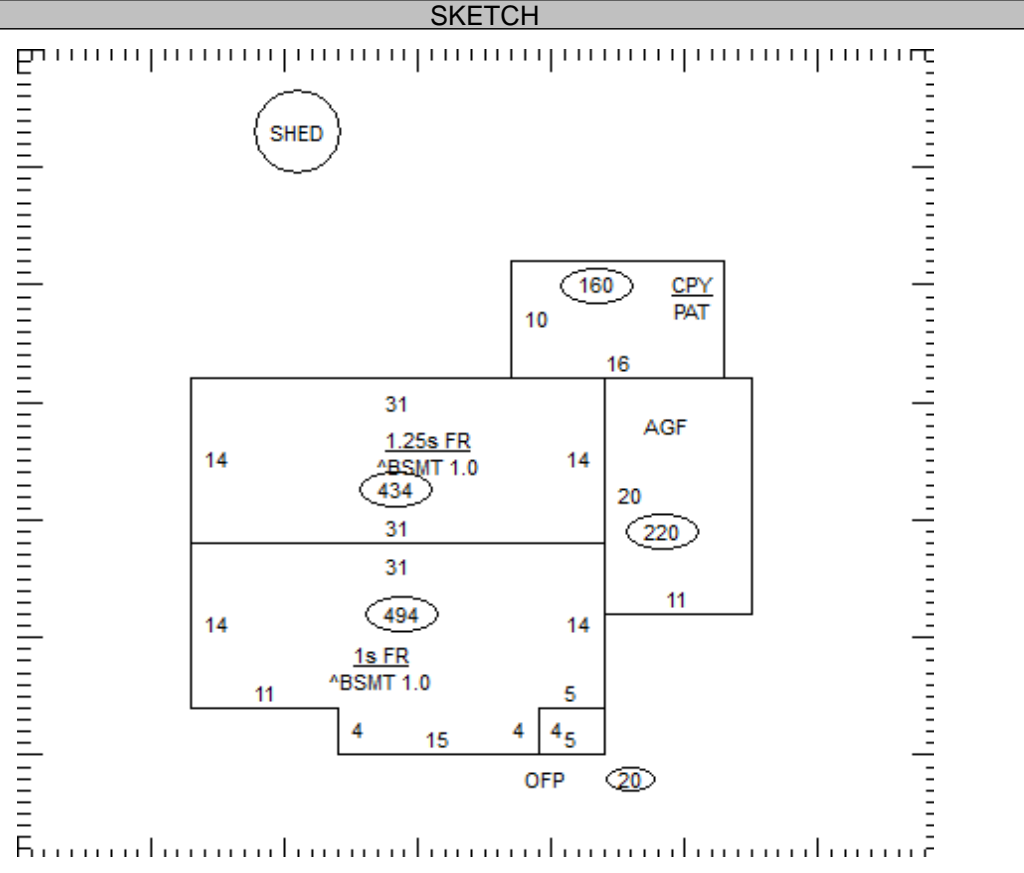

OCCUPANCY	ST.HT	SIZE	AREA	GRADE	PRICE	AGE	REMD	CND	UNADJ VAL	PHYS	PHYS VAL	FUNC	TRUE VAL
DWELLING	1.25	SK	1,036	C		1950		A	190,680	45	104,870		99,600
1 Shed	PP	8x10	80	C		2000		A		37			0
2													
3													
4													
5													
6													
7													
8													
9													
10													
11													

27-361800.0000

TOTAL 99,600

COMMENTS

VINYL SIDING 1982
Dwelling has an Economic Factor of 95%