

27-321400.0000

**HARTINGS NANCY J**

HARTINGS NANCY J

611 N SUGAR ST

CELINA, OH 45822

**LEGAL INFORMATION**

RILEY & CONKLIN ADD

LOT#: 6

OWNERSHIP	ADDRESS	CITY	STATE	ZIP	DATE	AMOUNT	DEED:CONV#	JS	VALID
1 HARTINGS NANCY J	611 N SUGAR ST	CELINA	OH	45822	06/07/2021	0	QCE : X : 0	<input type="checkbox"/>	<input type="checkbox"/>
2 HARTINGS JOSEPH J & NANCY	611 N SUGAR ST	CELINA	OH	45822	06/09/1993	21,200	: A : 0	<input type="checkbox"/>	<input type="checkbox"/>
3						0	0	<input type="checkbox"/>	<input type="checkbox"/>

X:  TTO LISTER: DATE: 08/18/2009 TIME: 12:00:00 AM  LETTER  LETTER REC'D GIS CODE

**STREET/ROAD TOPOGRAPHY PU-UTILITIES-PR NEIGHBORHOOD INFLUENCE FACTORS PROPERTY LOCATION**

PAVED  LEVEL  WATER  IMPROVING  A. NO ROAD  F. RESTRICT  
 GRAVEL  HIGH  SEWER  STATIC  B. TOPGRHY  G. WOOD LT  
 DIRT  LOW  GAS  DECLINING  C. Ex Front  H. VACANCY  
 SIDEWALKS  ROLLING  ELECTRIC  OLD  D. QUANTITY  I. WATER FRONT  
 CURBS  STANDARD  STANDARD  STANDARD  E. SZ/SHAPE  J. OTHER/CDU

611 N SUGAR ST, CELINA  
**COMMENT**

Tax Incentive Exempt Parcel: 27-321400.000A  
 (TY2022 L=0; B=0; T=0)  
 TY2022:Net Gen=\$1,445.12, Other  
 Assessment=\$0.00  
 DE09 CORR GAR-DATA MAILER

**LAND COMPUTATIONS**

LAND TYPE	SIZE	M	RATE	C	INF	M	VALUE	C
F:Front	F50 D132	ST350	DP94	ADJ329			16,500	0
TOTAL							16,500	0

**VALUATION SUMMARY**

VALUE YEAR	2023	2020	2017
REASON FOR CHANGE	RAPP	RAPP	RAPP
APPRAISED VALUE	LAND 16,500	9,700	9,000
	IMPR 128,200	81,700	70,700
	TOTAL 144,700	91,400	79,700
ASSESSED VALUE	LAND 5,780	3,400	3,150
	IMPR 44,870	28,600	24,750
	TOTAL 50,650	32,000	27,900

<b>OCCUPANCY</b>	<b>EXTERIOR</b>	<b>FLOOR</b>	<b>AREA</b>	<b>CONST</b>	<b>VALUE</b>
<input checked="" type="checkbox"/> SF <input type="checkbox"/> DU <input type="checkbox"/> TR	<input type="checkbox"/> WOOD	1	1224	FR	181,210
<input type="checkbox"/> CONVERSION	<input type="checkbox"/> STUCCO	.5	376	FR	34,520
<b>BUILDING TYPE</b>	<input checked="" type="checkbox"/> ALM/VYNL				
<input type="checkbox"/> MOBILE HOME	<input type="checkbox"/> CONC BLK				
<input type="checkbox"/> BI/TR LEVEL	<input type="checkbox"/> METAL				
<input type="checkbox"/> MOD/MAN	<input type="checkbox"/> BRICK				
<input type="checkbox"/>	<input type="checkbox"/> STONE				

<b>ROOFING</b>	<b>ROOF TYPE</b>				
<input type="checkbox"/> METAL	<input checked="" type="checkbox"/> GABLE				
<input type="checkbox"/> SLT/TLE	<input type="checkbox"/> HIP				
<input checked="" type="checkbox"/> SHINGLES	<input type="checkbox"/> GAMBREL				
<input type="checkbox"/> SHAKES	<input type="checkbox"/> MANSARD				
<input type="checkbox"/> COMPOSITE	<input type="checkbox"/> FLAT				

<b>FLOORS</b>	<b>B</b>	<b>1</b>	<b>2</b>	<b>3</b>	<b>U</b>			
CONCRETE	<input type="checkbox"/>	<input type="checkbox"/>	<input type="checkbox"/>	<input type="checkbox"/>	<input type="checkbox"/>			
WOOD	<input type="checkbox"/>	<input checked="" type="checkbox"/>	<input checked="" type="checkbox"/>	<input type="checkbox"/>	<input type="checkbox"/>			
TILE/COMPO	<input type="checkbox"/>	<input type="checkbox"/>	<input type="checkbox"/>	<input type="checkbox"/>	<input type="checkbox"/>			
CARPET	<input type="checkbox"/>	<input checked="" type="checkbox"/>	<input checked="" type="checkbox"/>	<input type="checkbox"/>	<input type="checkbox"/>			
<b>INT. FINISH</b>	<b>B</b>	<b>1</b>	<b>2</b>	<b>3</b>	<b>U</b>			
PLASTER/DW	<input type="checkbox"/>	<input checked="" type="checkbox"/>	<input checked="" type="checkbox"/>	<input type="checkbox"/>	<input type="checkbox"/>			
PANELING	<input type="checkbox"/>	<input type="checkbox"/>	<input type="checkbox"/>	<input type="checkbox"/>	<input type="checkbox"/>			
UNFINISHED	<input checked="" type="checkbox"/>	<input type="checkbox"/>	<input type="checkbox"/>	<input type="checkbox"/>	<input type="checkbox"/>			
<b>ACCOMMODATIONS</b>								
# OF ROOMS		6	3					
BEDROOMS		1	3					
<b>FIREPLACES</b>								
<b>HEAT &amp; AC</b>	<b>B</b>	<b>1</b>	<b>2</b>	<b>3</b>	<b>U</b>			
NO HEAT	<input type="checkbox"/>	<input type="checkbox"/>	<input type="checkbox"/>	<input type="checkbox"/>	<input type="checkbox"/>			
CTRL HEAT	<input type="checkbox"/>	<input checked="" type="checkbox"/>	<input checked="" type="checkbox"/>	<input type="checkbox"/>	<input type="checkbox"/>			
HW/STEAM	<input type="checkbox"/>	<input type="checkbox"/>	<input type="checkbox"/>	<input type="checkbox"/>	<input type="checkbox"/>			
ELECTRIC	<input type="checkbox"/>	<input type="checkbox"/>	<input type="checkbox"/>	<input type="checkbox"/>	<input type="checkbox"/>			
HEAT PUMP	<input type="checkbox"/>	<input type="checkbox"/>	<input type="checkbox"/>	<input type="checkbox"/>	<input type="checkbox"/>			
FLR/WALL	<input type="checkbox"/>	<input type="checkbox"/>	<input type="checkbox"/>	<input type="checkbox"/>	<input type="checkbox"/>			
STVE/SPCE	<input type="checkbox"/>	<input type="checkbox"/>	<input type="checkbox"/>	<input type="checkbox"/>	<input type="checkbox"/>			
GEOHERMAL	<input type="checkbox"/>	<input type="checkbox"/>	<input type="checkbox"/>	<input type="checkbox"/>	<input type="checkbox"/>			
OUTSIDE	<input type="checkbox"/>	<input type="checkbox"/>	<input type="checkbox"/>	<input type="checkbox"/>	<input type="checkbox"/>			
CTRL A/C	<input type="checkbox"/>	<input checked="" type="checkbox"/>	<input checked="" type="checkbox"/>	<input type="checkbox"/>	<input type="checkbox"/>			
<b>PLUMBING</b>						<b>BASE</b>	<input checked="" type="checkbox"/>	
X FULL BATH			1					
X HALF BATH								
X FIXTURES								

BSMT	104		1,490
<b>SUBTOTAL</b>			217,220
MULTI-FAMILY #	0		0
BUILDING TYPE	100%		0
BSMT FINISH	0 S.F.		0
FIREPLACE #	0		0
HEATING	0 S.F.		0
AIR COND	1,600 S.F.		2,640
PLUMBING #	3		3,630
GARAGES & CARPORTS			7,100
EXTRA FEATURES			14,800
<b>SUBTOTAL</b>			245,390
GRADE FACTOR			100 %
<b>UNADJUSTED VALUE</b>			245,390
FACTOR			100 %

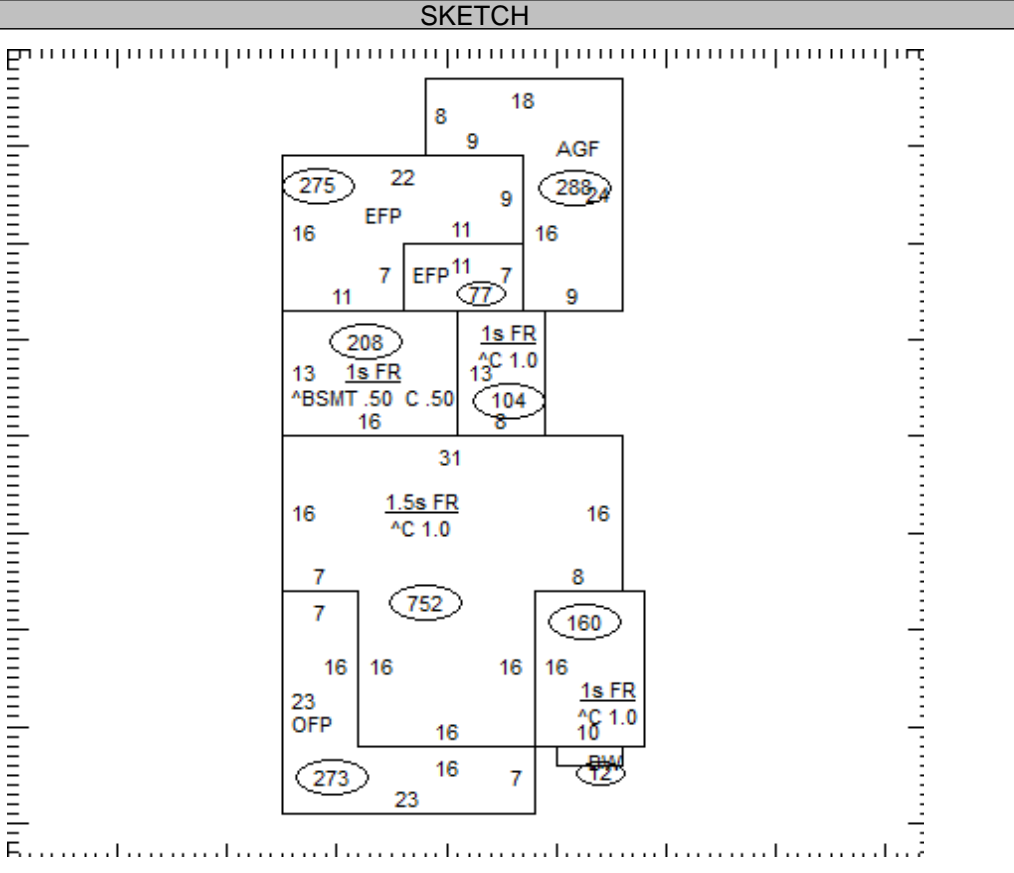

OCCUPANCY	ST.HT	SIZE	AREA	GRADE	PRICE	AGE	REMD	CND	UNADJ VAL	PHYS	PHYS VAL	FUNC	TRUE VAL
DWELLING	1.5	SK	1,600	C		1903		A	245,390	45	134,960		128,200
1													
2													
3													
4													
5													
6													
7													
8													
9													
10													
11													

27-321400.0000 TOTAL 128,200

**COMMENTS**

2005 Dupl. Removed Abmnt - Expired  
 Dwelling has an Economic Factor of 95%