

OCCUPANCY
 SF DU TR
 CONVERSION
BUILDING TYPE
 MOBILE HOME
 BI/TR LEVEL
 MOD/MAN

FLOOR	AREA	CONST	VALUE
1	886	FR	147,430
BSMT	886		12,670
SUBTOTAL			160,100

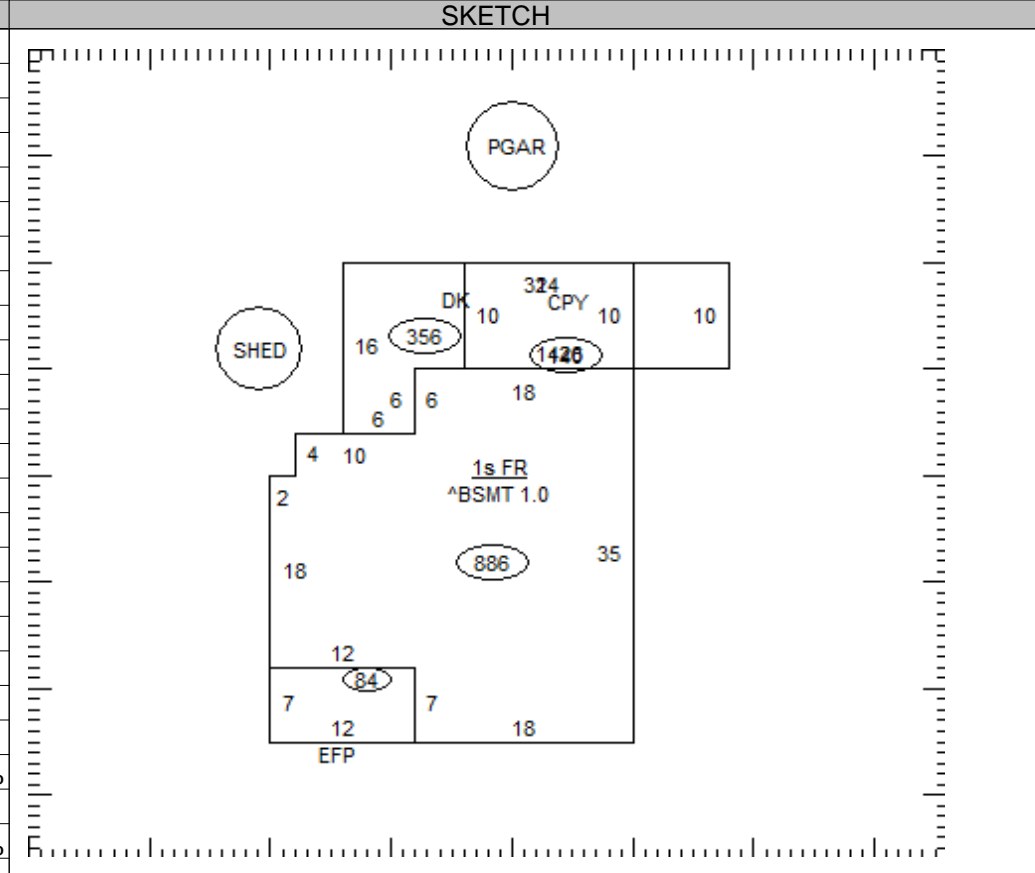

ROOFING
 METAL
 SLT/TLE
 SHINGLES
 SHAKES
 COMPOSITE

ROOF TYPE
 GABLE
 HIP
 GAMBREL
 MANSARD
 FLAT

SUBTOTAL			160,100
MULTI-FAMILY #	0		0
BUILDING TYPE	100%		0
BSMT FINISH	0 S.F.		0
FIREPLACE #	0		0
HEATING	0 S.F.		0
AIR COND	886 S.F.		1,460
PLUMBING #	0		0
GARAGES & CARPORTS			0
EXTRA FEATURES			7,100
SUBTOTAL			168,660
GRADE FACTOR			95 %
UNADJUSTED VALUE			160,230
FACTOR			100 %

FLOORS B 1 2 3 U
 CONCRETE
 WOOD
 TILE/COMPO
 CARPET

BSMT	886		12,670
SUBTOTAL			160,100
MULTI-FAMILY #	0		0
BUILDING TYPE	100%		0
BSMT FINISH	0 S.F.		0
FIREPLACE #	0		0
HEATING	0 S.F.		0
AIR COND	886 S.F.		1,460
PLUMBING #	0		0
GARAGES & CARPORTS			0
EXTRA FEATURES			7,100
SUBTOTAL			168,660
GRADE FACTOR			95 %
UNADJUSTED VALUE			160,230
FACTOR			100 %

INT. FINISH B 1 2 3 U
 PLASTER/DW
 PANELING
 UNFINISHED

SUBTOTAL			168,660
GRADE FACTOR			95 %
UNADJUSTED VALUE			160,230
FACTOR			100 %

ACCOMMODATIONS
 # OF ROOMS 5
 BEDROOMS 2
 FIREPLACES
 HEAT & AC B 1 2 3 U

SUBTOTAL			168,660
GRADE FACTOR			95 %
UNADJUSTED VALUE			160,230
FACTOR			100 %

NO HEAT
 CTRL HEAT
 HW/STEAM
 ELECTRIC
 HEAT PUMP
 FLR/WALL
 STVE/SPCE
 GEOTHERMAL
 OUTSIDE
 CTRL A/C

OCCUPANCY	ST.HT	SIZE	AREA	GRADE	PRICE	AGE	REMD	CND	UNADJ VAL	PHYS	PHYS VAL	FUNC	TRUE VAL
DWELLING	1	SK	886	C-		1920		A	160,230	45	88,130		76,700
1 Shed	PP	8x14	112	C		1997		A		47			0
2 Gar - Pole		30x30	900	C	12.00	2014		G	10,800	7	10,040	ABT75	2,500
3													
4													
5													
6													
7													
8													
9													
10													
11													

PLUMBING BASE
 X FULL BATH
 X HALF BATH
 X FIXTURES

27-180400.0000

TOTAL *37,110

COMMENTS

Dwelling has an Economic Factor of 87%

