

OCCUPANCY
 SF DU TR
 CONVERSION
BUILDING TYPE
 MOBILE HOME
 BI/TR LEVEL
 MOD/MAN

FLOOR	AREA	CONST	VALUE
1	936	FR	153,380

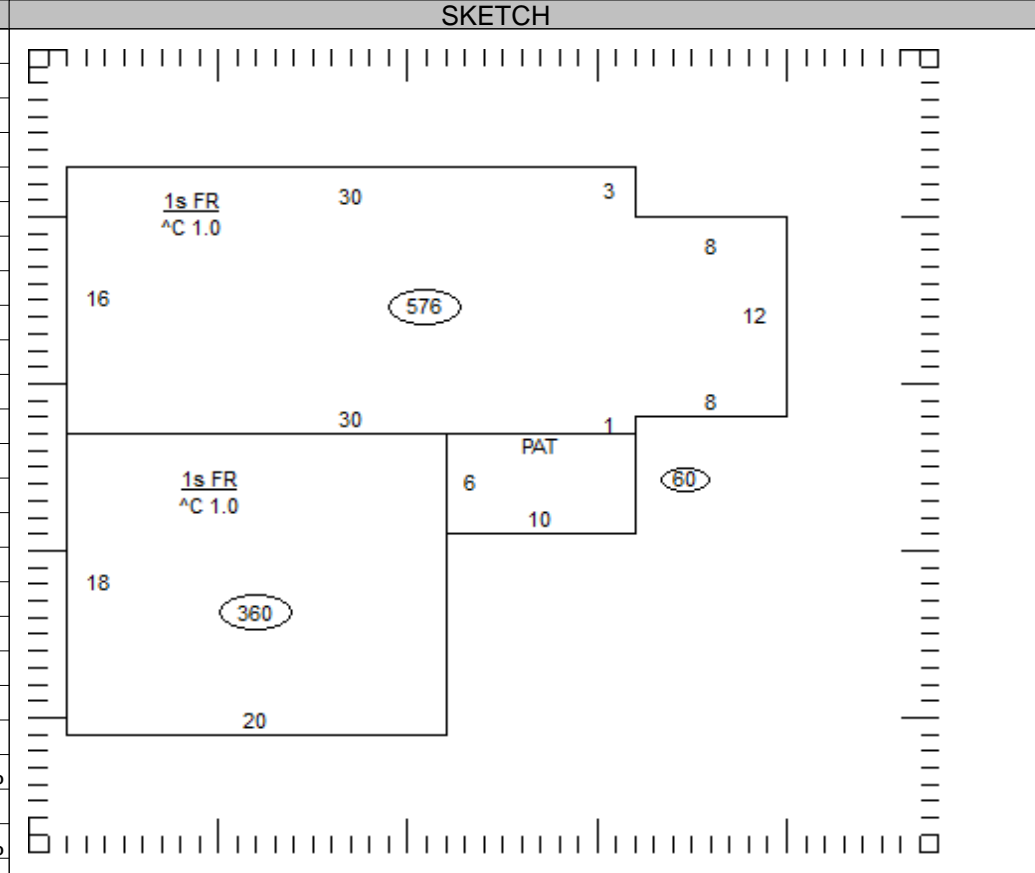

ROOFING
 METAL
 SLT/TLE
 SHINGLES
 SHAKES
 COMPOSITE

ROOF TYPE
 WOOD
 STUCCO
 ALM/VYNL
 CONC BLK
 METAL
 BRICK
 STONE

SUBTOTAL			153,380
MULTI-FAMILY #	0		0
BUILDING TYPE	100%		0
BSMT FINISH	0 S.F.		0
FIREPLACE #	0		0
HEATING	0 S.F.		0
AIR COND	0 S.F.		0
PLUMBING #	0		0
GARAGES & CARPORTS			0
EXTRA FEATURES			200
SUBTOTAL			153,580
GRADE FACTOR			70 %
UNADJUSTED VALUE			107,510
FACTOR			100 %

FLOORS
 CONCRETE
 WOOD
 TILE/COMPO
 CARPET

INT. FINISH
 PLASTER/DW
 PANELING
 UNFINISHED

B	1	2	3	U
<input type="checkbox"/>	<input type="checkbox"/>	<input type="checkbox"/>	<input type="checkbox"/>	<input type="checkbox"/>
<input type="checkbox"/>	<input type="checkbox"/>	<input type="checkbox"/>	<input type="checkbox"/>	<input type="checkbox"/>
<input type="checkbox"/>	<input checked="" type="checkbox"/>	<input type="checkbox"/>	<input type="checkbox"/>	<input type="checkbox"/>
<input type="checkbox"/>	<input checked="" type="checkbox"/>	<input type="checkbox"/>	<input type="checkbox"/>	<input type="checkbox"/>

ACCOMMODATIONS
 # OF ROOMS: 6
 BEDROOMS: 3
 FIREPLACES: 0
 HEAT & AC: NO HEAT, CTRL HEAT, HW/STEAM, ELECTRIC, HEAT PUMP, FLR/WALL, STVE/SPCE, GEOTHERMAL, OUTSIDE, CTRL A/C

OCCUPANCY	ST.HT	SIZE	AREA	GRADE	PRICE	AGE	REMD	CND	UNADJ VAL	PHYS	PHYS VAL	FUNC	TRUE VAL
DWELLING	1	SK	936	D-		1947		A	107,510	50	53,760		48,400
1													
2													
3													
4													
5													
6													
7													
8													
9													
10													
11													

PLUMBING
 X FULL BATH
 X HALF BATH
 X FIXTURES

SUBTOTAL			153,580
GRADE FACTOR			70 %
UNADJUSTED VALUE			107,510
FACTOR			100 %

27-086900.0000

TOTAL													*21,200
COMMENTS													
Dwelling has an Economic Factor of 90%													