

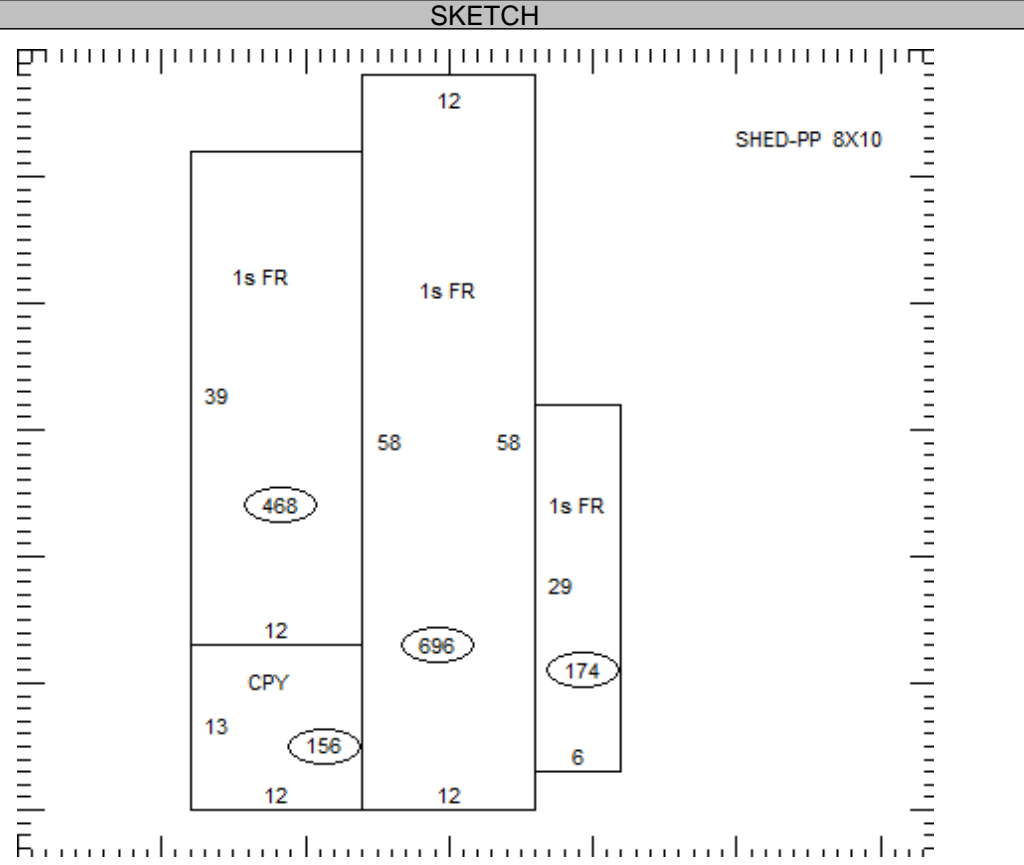

|   |                             |  |                               |                                     |                          |                          |              |            |                  |             |                 |             |                 |
|---|-----------------------------|--|-------------------------------|-------------------------------------|--------------------------|--------------------------|--------------|------------|------------------|-------------|-----------------|-------------|-----------------|
| <b>OCCUPANCY</b>                                |                             | <b>EXTERIOR</b>                              |                               | <b>FLOOR</b>                        | <b>AREA</b>              | <b>CONST</b>             | <b>VALUE</b> |            |                  |             |                 |             |                 |
| <input checked="" type="checkbox"/> SF          | <input type="checkbox"/> DU | <input type="checkbox"/> TR                  | <input type="checkbox"/> WOOD | 1                                   | 1338                     | FR                       | 40,810       |            |                  |             |                 |             |                 |
| <input type="checkbox"/> CONVERSION             |                             | <input type="checkbox"/> STUCCO              |                               |                                     |                          |                          |              |            |                  |             |                 |             |                 |
| <b>BUILDING TYPE</b>                            |                             | <input checked="" type="checkbox"/> ALM/VYNL |                               |                                     |                          |                          |              |            |                  |             |                 |             |                 |
| <input checked="" type="checkbox"/> MOBILE HOME |                             | <input type="checkbox"/> CONC BLK            |                               |                                     |                          |                          |              |            |                  |             |                 |             |                 |
| <input type="checkbox"/> BI/TR LEVEL            |                             | <input type="checkbox"/> METAL               |                               |                                     |                          |                          |              |            |                  |             |                 |             |                 |
| <input type="checkbox"/> MOD/MAN                |                             | <input type="checkbox"/> BRICK               |                               |                                     |                          |                          |              |            |                  |             |                 |             |                 |
| <input type="checkbox"/>                        |                             | <input type="checkbox"/> STONE               |                               |                                     |                          |                          |              |            |                  |             |                 |             |                 |
| <b>ROOFING</b>                                  |                             | <b>ROOF TYPE</b>                             |                               |                                     |                          |                          |              |            |                  |             |                 |             |                 |
| <input type="checkbox"/> METAL                  |                             | <input checked="" type="checkbox"/> GABLE    |                               |                                     |                          |                          |              |            |                  |             |                 |             |                 |
| <input type="checkbox"/> SLT/TLE                |                             | <input type="checkbox"/> HIP                 |                               |                                     |                          |                          |              |            |                  |             |                 |             |                 |
| <input type="checkbox"/> SHINGLES               |                             | <input type="checkbox"/> GAMBREL             |                               |                                     |                          |                          |              |            |                  |             |                 |             |                 |
| <input type="checkbox"/> SHAKES                 |                             | <input type="checkbox"/> MANSARD             |                               |                                     |                          |                          |              |            |                  |             |                 |             |                 |
| <input checked="" type="checkbox"/> COMPOSITE   |                             | <input type="checkbox"/> FLAT                |                               |                                     |                          |                          |              |            |                  |             |                 |             |                 |
| <b>FLOORS</b>                                   |                             | <b>B</b>                                     | <b>1</b>                      | <b>2</b>                            | <b>3</b>                 | <b>U</b>                 |              |            |                  |             |                 |             |                 |
| CONCRETE  | <input type="checkbox"/>    | <input type="checkbox"/>                     | <input type="checkbox"/>      | <input type="checkbox"/>            | <input type="checkbox"/> | <input type="checkbox"/> |              |            |                  |             |                 |             |                 |
| WOOD  | <input type="checkbox"/>    | <input type="checkbox"/>                     | <input type="checkbox"/>      | <input type="checkbox"/>            | <input type="checkbox"/> | <input type="checkbox"/> |              |            |                  |             |                 |             |                 |
| TILE/COMPO                                      | <input type="checkbox"/>    | <input checked="" type="checkbox"/>          | <input type="checkbox"/>      | <input type="checkbox"/>            | <input type="checkbox"/> | <input type="checkbox"/> |              |            |                  |             |                 |             |                 |
| CARPET  | <input type="checkbox"/>    | <input checked="" type="checkbox"/>          | <input type="checkbox"/>      | <input type="checkbox"/>            | <input type="checkbox"/> | <input type="checkbox"/> |              |            |                  |             |                 |             |                 |
| <b>INT. FINISH</b>                              |                             | <b>B</b>                                     | <b>1</b>                      | <b>2</b>                            | <b>3</b>                 | <b>U</b>                 |              |            |                  |             |                 |             |                 |
| PLASTER/DW                                      | <input type="checkbox"/>    | <input type="checkbox"/>                     | <input type="checkbox"/>      | <input type="checkbox"/>            | <input type="checkbox"/> | <input type="checkbox"/> |              |            |                  |             |                 |             |                 |
| PANELING  | <input type="checkbox"/>    | <input checked="" type="checkbox"/>          | <input type="checkbox"/>      | <input type="checkbox"/>            | <input type="checkbox"/> | <input type="checkbox"/> |              |            |                  |             |                 |             |                 |
| UNFINISHED                                      | <input type="checkbox"/>    | <input type="checkbox"/>                     | <input type="checkbox"/>      | <input type="checkbox"/>            | <input type="checkbox"/> | <input type="checkbox"/> |              |            |                  |             |                 |             |                 |
| <b>ACCOMMODATIONS</b>                           |                             |  |                               |                                     |                          |                          |              |            |                  |             |                 |             |                 |
| # OF ROOMS                                      |                             | 5  |                               |                                     |                          |                          |              |            |                  |             |                 |             |                 |
| BEDROOMS  |                             | 3  |                               |                                     |                          |                          |              |            |                  |             |                 |             |                 |
| <b>FIREPLACES</b>                               |                             |  |                               |                                     |                          |                          |              |            |                  |             |                 |             |                 |
| <b>HEAT &amp; AC</b>                            |                             | <b>B</b>                                     | <b>1</b>                      | <b>2</b>                            | <b>3</b>                 | <b>U</b>                 |              |            |                  |             |                 |             |                 |
| NO HEAT   | <input type="checkbox"/>    | <input type="checkbox"/>                     | <input type="checkbox"/>      | <input type="checkbox"/>            | <input type="checkbox"/> | <input type="checkbox"/> |              |            |                  |             |                 |             |                 |
| CTRL HEAT                                       | <input type="checkbox"/>    | <input checked="" type="checkbox"/>          | <input type="checkbox"/>      | <input type="checkbox"/>            | <input type="checkbox"/> | <input type="checkbox"/> |              |            |                  |             |                 |             |                 |
| HW/STEAM  | <input type="checkbox"/>    | <input type="checkbox"/>                     | <input type="checkbox"/>      | <input type="checkbox"/>            | <input type="checkbox"/> | <input type="checkbox"/> |              |            |                  |             |                 |             |                 |
| ELECTRIC  | <input type="checkbox"/>    | <input type="checkbox"/>                     | <input type="checkbox"/>      | <input type="checkbox"/>            | <input type="checkbox"/> | <input type="checkbox"/> |              |            |                  |             |                 |             |                 |
| HEAT PUMP                                       | <input type="checkbox"/>    | <input type="checkbox"/>                     | <input type="checkbox"/>      | <input type="checkbox"/>            | <input type="checkbox"/> | <input type="checkbox"/> |              |            |                  |             |                 |             |                 |
| FLR/WALL  | <input type="checkbox"/>    | <input type="checkbox"/>                     | <input type="checkbox"/>      | <input type="checkbox"/>            | <input type="checkbox"/> | <input type="checkbox"/> |              |            |                  |             |                 |             |                 |
| STVE/SPCE                                       | <input type="checkbox"/>    | <input type="checkbox"/>                     | <input type="checkbox"/>      | <input type="checkbox"/>            | <input type="checkbox"/> | <input type="checkbox"/> |              |            |                  |             |                 |             |                 |
| GEO THERMAL                                     | <input type="checkbox"/>    | <input type="checkbox"/>                     | <input type="checkbox"/>      | <input type="checkbox"/>            | <input type="checkbox"/> | <input type="checkbox"/> |              |            |                  |             |                 |             |                 |
| OUTSIDE   | <input type="checkbox"/>    | <input type="checkbox"/>                     | <input type="checkbox"/>      | <input type="checkbox"/>            | <input type="checkbox"/> | <input type="checkbox"/> |              |            |                  |             |                 |             |                 |
| CTRL A/C  | <input type="checkbox"/>    | <input checked="" type="checkbox"/>          | <input type="checkbox"/>      | <input type="checkbox"/>            | <input type="checkbox"/> | <input type="checkbox"/> |              |            |                  |             |                 |             |                 |
| <b>PLUMBING</b>                                 |                             | <b>BASE</b>                                  |                               | <input checked="" type="checkbox"/> |                          |                          |              |            |                  |             |                 |             |                 |
| X FULL BATH                                     |                             | 1  |                               |                                     |                          |                          |              |            |                  |             |                 |             |                 |
| X HALF BATH                                     |                             |  |                               |                                     |                          |                          |              |            |                  |             |                 |             |                 |
| X FIXTURES                                      |                             |  |                               |                                     |                          |                          |              |            |                  |             |                 |             |                 |
| <b>SUBTOTAL</b>                                 |                             |  |                               |                                     |                          |                          | 40,810       |            |                  |             |                 |             |                 |
| MULTI-FAMILY #                                  | 0                           |  |                               |                                     |                          |                          | 0            |            |                  |             |                 |             |                 |
| BUILDING TYPE                                   | 100%                        |  |                               |                                     |                          |                          | 0            |            |                  |             |                 |             |                 |
| BSMT FINISH                                     | 0 S.F.                      |  |                               |                                     |                          |                          | 0            |            |                  |             |                 |             |                 |
| FIREPLACE #                                     | 0                           |  |                               |                                     |                          |                          | 0            |            |                  |             |                 |             |                 |
| HEATING   | 0 S.F.                      |  |                               |                                     |                          |                          | 0            |            |                  |             |                 |             |                 |
| AIR COND  | 1,338 S.F.                  |  |                               |                                     |                          |                          | 2,210        |            |                  |             |                 |             |                 |
| PLUMBING #                                      | 3                           |  |                               |                                     |                          |                          | 3,630        |            |                  |             |                 |             |                 |
| GARAGES & CARPORTS                              |                             |  |                               |                                     |                          |                          | 0            |            |                  |             |                 |             |                 |
| EXTRA FEATURES                                  |                             |  |                               |                                     |                          |                          | 1,200        |            |                  |             |                 |             |                 |
| <b>SUBTOTAL</b>                                 |                             |  |                               |                                     |                          |                          | 47,850       |            |                  |             |                 |             |                 |
| GRADE FACTOR                                    |                             |  |                               |                                     |                          |                          | 90 %         |            |                  |             |                 |             |                 |
| <b>UNADJUSTED VALUE</b>                         |                             |  |                               |                                     |                          |                          | 43,070       |            |                  |             |                 |             |                 |
| FACTOR  |                             |  |                               |                                     |                          |                          | 100 %        |            |                  |             |                 |             |                 |
| <b>OCCUPANCY</b>                                | <b>ST.HT</b>                | <b>SIZE</b>                                  | <b>AREA</b>                   | <b>GRADE</b>                        | <b>PRICE</b>             | <b>AGE</b>               | <b>REMD</b>  | <b>CND</b> | <b>UNADJ VAL</b> | <b>PHYS</b> | <b>PHYS VAL</b> | <b>FUNC</b> | <b>TRUE VAL</b> |
| MOBILE HOME                                     | 1                           | SK58X12                                      | 1,338                         | D                                   |                          | 1970                     |              | G          | 43,070           | 95          | 2,150           |             | 2,200           |
| 1   |                             |  |                               |                                     |                          |                          |              |            |                  |             |                 |             |                 |
| 2   |                             |  |                               |                                     |                          |                          |              |            |                  |             |                 |             |                 |
| 3   |                             |  |                               |                                     |                          |                          |              |            |                  |             |                 |             |                 |
| 4   |                             |  |                               |                                     |                          |                          |              |            |                  |             |                 |             |                 |
| 5   |                             |  |                               |                                     |                          |                          |              |            |                  |             |                 |             |                 |
| 6   |                             |  |                               |                                     |                          |                          |              |            |                  |             |                 |             |                 |
| 7   |                             |  |                               |                                     |                          |                          |              |            |                  |             |                 |             |                 |
| 8   |                             |  |                               |                                     |                          |                          |              |            |                  |             |                 |             |                 |
| 9   |                             |  |                               |                                     |                          |                          |              |            |                  |             |                 |             |                 |
| 10  |                             |  |                               |                                     |                          |                          |              |            |                  |             |                 |             |                 |
| 11  |                             |  |                               |                                     |                          |                          |              |            |                  |             |                 |             |                 |



26-700093.M000

TOTAL 2,200

**COMMENTS**

Dwelling has an Economic Factor of 100%



| OCCUPANCY   | EXTERIOR                          | FLOOR | AREA | CONST | VALUE |
|---|-----------------------------------|-------|------|-------|-------|
| <input type="checkbox"/> SF <input type="checkbox"/> DU <input type="checkbox"/> TR | <input type="checkbox"/> WOOD     |       |      |       |       |
| <input type="checkbox"/> CONVERSION   | <input type="checkbox"/> STUCCO   |       |      |       |       |
| <b>BUILDING TYPE</b>  | <input type="checkbox"/> ALM/VYNL |       |      |       |       |
| <input type="checkbox"/> MOBILE HOME  | <input type="checkbox"/> CONC BLK |       |      |       |       |
| <input type="checkbox"/> BI/TR LEVEL  | <input type="checkbox"/> METAL    |       |      |       |       |
| <input type="checkbox"/> MOD/MAN  | <input type="checkbox"/> BRICK    |       |      |       |       |
| <input type="checkbox"/> _____  | <input type="checkbox"/> STONE    |       |      |       |       |

| ROOFING                            | ROOF TYPE                        |
|------------------------------------|----------------------------------|
| <input type="checkbox"/> METAL     | <input type="checkbox"/> GABLE   |
| <input type="checkbox"/> SLT/TLE   | <input type="checkbox"/> HIP     |
| <input type="checkbox"/> SHINGLES  | <input type="checkbox"/> GAMBREL |
| <input type="checkbox"/> SHAKES    | <input type="checkbox"/> MANSARD |
| <input type="checkbox"/> COMPOSITE | <input type="checkbox"/> FLAT    |

| FLOORS         | B                        | 1                        | 2                        | 3                        | U                             |
|----------------|--------------------------|--------------------------|--------------------------|--------------------------|-------------------------------|
| CONCRETE       | <input type="checkbox"/> | <input type="checkbox"/> | <input type="checkbox"/> | <input type="checkbox"/> | <input type="checkbox"/>      |
| WOOD           | <input type="checkbox"/> | <input type="checkbox"/> | <input type="checkbox"/> | <input type="checkbox"/> | <input type="checkbox"/>      |
| TILE/COMPO     | <input type="checkbox"/> | <input type="checkbox"/> | <input type="checkbox"/> | <input type="checkbox"/> | <input type="checkbox"/>      |
| CARPET         | <input type="checkbox"/> | <input type="checkbox"/> | <input type="checkbox"/> | <input type="checkbox"/> | <input type="checkbox"/>      |
| INT. FINISH    | B                        | 1                        | 2                        | 3                        | U                             |
| PLASTER/DW     | <input type="checkbox"/> | <input type="checkbox"/> | <input type="checkbox"/> | <input type="checkbox"/> | <input type="checkbox"/>      |
| PANELING       | <input type="checkbox"/> | <input type="checkbox"/> | <input type="checkbox"/> | <input type="checkbox"/> | <input type="checkbox"/>      |
| UNFINISHED     | <input type="checkbox"/> | <input type="checkbox"/> | <input type="checkbox"/> | <input type="checkbox"/> | <input type="checkbox"/>      |
| ACCOMMODATIONS |                          |                          |                          |                          |                               |
| # OF ROOMS     |                          |                          |                          |                          |                               |
| BEDROOMS       |                          |                          |                          |                          |                               |
| FIREPLACES     |                          |                          |                          |                          |                               |
| HEAT & AC      | B                        | 1                        | 2                        | 3                        | U                             |
| NO HEAT        | <input type="checkbox"/> | <input type="checkbox"/> | <input type="checkbox"/> | <input type="checkbox"/> | <input type="checkbox"/>      |
| CTRL HEAT      | <input type="checkbox"/> | <input type="checkbox"/> | <input type="checkbox"/> | <input type="checkbox"/> | <input type="checkbox"/>      |
| HW/STEAM       | <input type="checkbox"/> | <input type="checkbox"/> | <input type="checkbox"/> | <input type="checkbox"/> | <input type="checkbox"/>      |
| ELECTRIC       | <input type="checkbox"/> | <input type="checkbox"/> | <input type="checkbox"/> | <input type="checkbox"/> | <input type="checkbox"/>      |
| HEAT PUMP      | <input type="checkbox"/> | <input type="checkbox"/> | <input type="checkbox"/> | <input type="checkbox"/> | <input type="checkbox"/>      |
| FLR/WALL       | <input type="checkbox"/> | <input type="checkbox"/> | <input type="checkbox"/> | <input type="checkbox"/> | <input type="checkbox"/>      |
| STVE/SPCE      | <input type="checkbox"/> | <input type="checkbox"/> | <input type="checkbox"/> | <input type="checkbox"/> | <input type="checkbox"/>      |
| GEO THERMAL    | <input type="checkbox"/> | <input type="checkbox"/> | <input type="checkbox"/> | <input type="checkbox"/> | <input type="checkbox"/>      |
| OUTSIDE        | <input type="checkbox"/> | <input type="checkbox"/> | <input type="checkbox"/> | <input type="checkbox"/> | <input type="checkbox"/>      |
| CTRL A/C       | <input type="checkbox"/> | <input type="checkbox"/> | <input type="checkbox"/> | <input type="checkbox"/> | <input type="checkbox"/>      |
| PLUMBING       |                          |                          |                          |                          | BASE <input type="checkbox"/> |
| X FULL BATH    |                          |                          |                          |                          |                               |
| X HALF BATH    |                          |                          |                          |                          |                               |
| X FIXTURES     |                          |                          |                          |                          |                               |

|                         |        |   |
|-------------------------|--------|---|
| <b>SUBTOTAL</b>         |        | 0 |
| MULTI-FAMILY #          | 0      | 0 |
| BUILDING TYPE           | 000%   | 0 |
| BSMT FINISH             | 0 S.F. | 0 |
| FIREPLACE #             | 0      | 0 |
| HEATING                 | 0 S.F. | 0 |
| AIR COND                | 0 S.F. | 0 |
| PLUMBING #              | 0      | 0 |
| GARAGES & CARPORTS      |        | 0 |
| EXTRA FEATURES          |        | 0 |
| <b>SUBTOTAL</b>         |        | 0 |
| GRADE FACTOR            |        | % |
| <b>UNADJUSTED VALUE</b> |        | 0 |
| FACTOR                  |        | % |

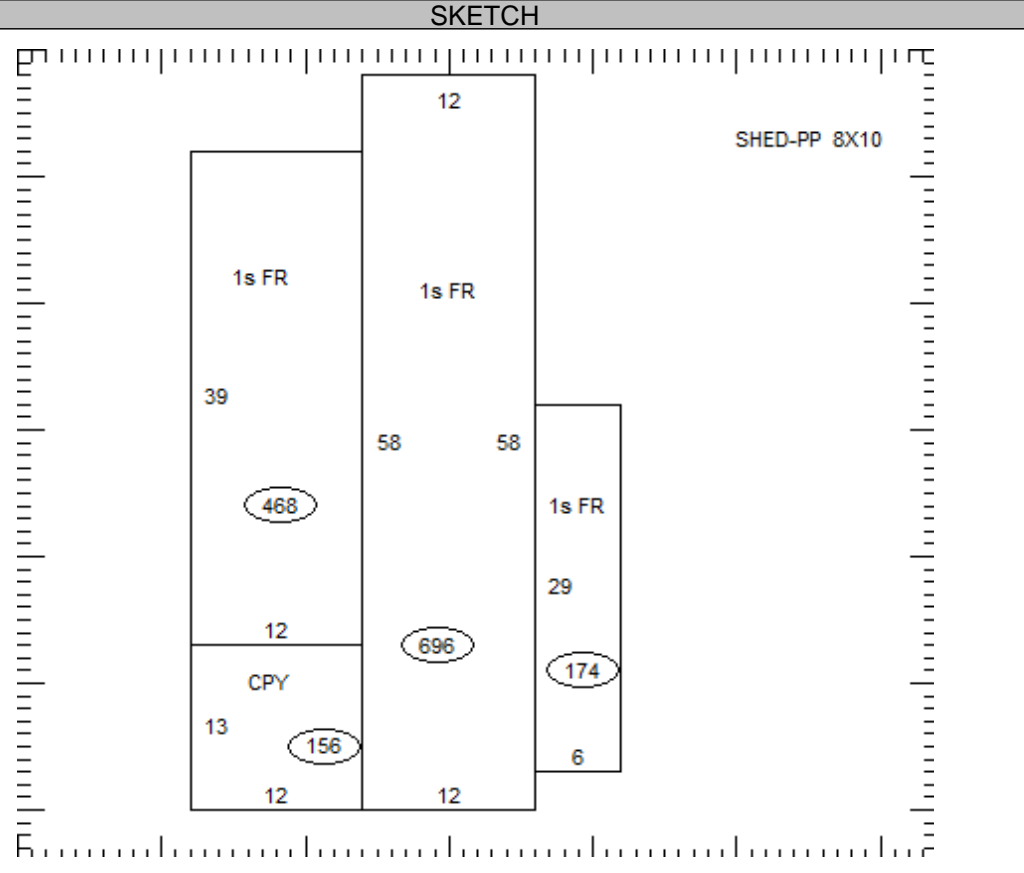

| OCCUPANCY   | ST.HT | SIZE | AREA | GRADE | PRICE | AGE | REMD | CND | UNADJ VAL | PHYS | PHYS VAL | FUNC | TRUE VAL |
|-------------|-------|------|------|-------|-------|-----|------|-----|-----------|------|----------|------|----------|
| MOBILE HOME |       | SK   |      |       |       |     |      |     |           |      |          |      |          |
| 1           |       |      |      |       |       |     |      |     |           |      |          |      |          |
| 2           |       |      |      |       |       |     |      |     |           |      |          |      |          |
| 3           |       |      |      |       |       |     |      |     |           |      |          |      |          |
| 4           |       |      |      |       |       |     |      |     |           |      |          |      |          |
| 5           |       |      |      |       |       |     |      |     |           |      |          |      |          |
| 6           |       |      |      |       |       |     |      |     |           |      |          |      |          |
| 7           |       |      |      |       |       |     |      |     |           |      |          |      |          |
| 8           |       |      |      |       |       |     |      |     |           |      |          |      |          |
| 9           |       |      |      |       |       |     |      |     |           |      |          |      |          |
| 10          |       |      |      |       |       |     |      |     |           |      |          |      |          |
| 11          |       |      |      |       |       |     |      |     |           |      |          |      |          |

26-700093.M000

TOTAL 0

COMMENTS



| OCCUPANCY   | EXTERIOR                          | FLOOR | AREA | CONST | VALUE |
|---|-----------------------------------|-------|------|-------|-------|
| <input type="checkbox"/> SF <input type="checkbox"/> DU <input type="checkbox"/> TR | <input type="checkbox"/> WOOD     |       |      |       |       |
| <input type="checkbox"/> CONVERSION   | <input type="checkbox"/> STUCCO   |       |      |       |       |
| <b>BUILDING TYPE</b>  | <input type="checkbox"/> ALM/VYNL |       |      |       |       |
| <input type="checkbox"/> MOBILE HOME  | <input type="checkbox"/> CONC BLK |       |      |       |       |
| <input type="checkbox"/> BI/TR LEVEL  | <input type="checkbox"/> METAL    |       |      |       |       |
| <input type="checkbox"/> MOD/MAN  | <input type="checkbox"/> BRICK    |       |      |       |       |
| <input type="checkbox"/>  | <input type="checkbox"/> STONE    |       |      |       |       |

| ROOFING                            | ROOF TYPE                        |
|------------------------------------|----------------------------------|
| <input type="checkbox"/> METAL     | <input type="checkbox"/> GABLE   |
| <input type="checkbox"/> SLT/TLE   | <input type="checkbox"/> HIP     |
| <input type="checkbox"/> SHINGLES  | <input type="checkbox"/> GAMBREL |
| <input type="checkbox"/> SHAKES    | <input type="checkbox"/> MANSARD |
| <input type="checkbox"/> COMPOSITE | <input type="checkbox"/> FLAT    |

| FLOORS         | B                        | 1                        | 2                        | 3                        | U                        |
|----------------|--------------------------|--------------------------|--------------------------|--------------------------|--------------------------|
| CONCRETE       | <input type="checkbox"/> | <input type="checkbox"/> | <input type="checkbox"/> | <input type="checkbox"/> | <input type="checkbox"/> |
| WOOD           | <input type="checkbox"/> | <input type="checkbox"/> | <input type="checkbox"/> | <input type="checkbox"/> | <input type="checkbox"/> |
| TILE/COMPO     | <input type="checkbox"/> | <input type="checkbox"/> | <input type="checkbox"/> | <input type="checkbox"/> | <input type="checkbox"/> |
| CARPET         | <input type="checkbox"/> | <input type="checkbox"/> | <input type="checkbox"/> | <input type="checkbox"/> | <input type="checkbox"/> |
| INT. FINISH    | B                        | 1                        | 2                        | 3                        | U                        |
| PLASTER/DW     | <input type="checkbox"/> | <input type="checkbox"/> | <input type="checkbox"/> | <input type="checkbox"/> | <input type="checkbox"/> |
| PANELING       | <input type="checkbox"/> | <input type="checkbox"/> | <input type="checkbox"/> | <input type="checkbox"/> | <input type="checkbox"/> |
| UNFINISHED     | <input type="checkbox"/> | <input type="checkbox"/> | <input type="checkbox"/> | <input type="checkbox"/> | <input type="checkbox"/> |
| ACCOMMODATIONS |                          |                          |                          |                          |                          |
| # OF ROOMS     |                          |                          |                          |                          |                          |
| BEDROOMS       |                          |                          |                          |                          |                          |
| FIREPLACES     |                          |                          |                          |                          |                          |
| HEAT & AC      | B                        | 1                        | 2                        | 3                        | U                        |
| NO HEAT        | <input type="checkbox"/> | <input type="checkbox"/> | <input type="checkbox"/> | <input type="checkbox"/> | <input type="checkbox"/> |
| CTRL HEAT      | <input type="checkbox"/> | <input type="checkbox"/> | <input type="checkbox"/> | <input type="checkbox"/> | <input type="checkbox"/> |
| HW/STEAM       | <input type="checkbox"/> | <input type="checkbox"/> | <input type="checkbox"/> | <input type="checkbox"/> | <input type="checkbox"/> |
| ELECTRIC       | <input type="checkbox"/> | <input type="checkbox"/> | <input type="checkbox"/> | <input type="checkbox"/> | <input type="checkbox"/> |
| HEAT PUMP      | <input type="checkbox"/> | <input type="checkbox"/> | <input type="checkbox"/> | <input type="checkbox"/> | <input type="checkbox"/> |
| FLR/WALL       | <input type="checkbox"/> | <input type="checkbox"/> | <input type="checkbox"/> | <input type="checkbox"/> | <input type="checkbox"/> |
| STVE/SPCE      | <input type="checkbox"/> | <input type="checkbox"/> | <input type="checkbox"/> | <input type="checkbox"/> | <input type="checkbox"/> |
| GEO THERMAL    | <input type="checkbox"/> | <input type="checkbox"/> | <input type="checkbox"/> | <input type="checkbox"/> | <input type="checkbox"/> |
| OUTSIDE        | <input type="checkbox"/> | <input type="checkbox"/> | <input type="checkbox"/> | <input type="checkbox"/> | <input type="checkbox"/> |
| CTRL A/C       | <input type="checkbox"/> | <input type="checkbox"/> | <input type="checkbox"/> | <input type="checkbox"/> | <input type="checkbox"/> |
| PLUMBING       |                          |                          |                          |                          | <input type="checkbox"/> |
| X FULL BATH    |                          |                          |                          |                          |                          |
| X HALF BATH    |                          |                          |                          |                          |                          |
| X FIXTURES     |                          |                          |                          |                          |                          |

|                         |        |   |
|-------------------------|--------|---|
| <b>SUBTOTAL</b>         |        | 0 |
| MULTI-FAMILY #          | 0      | 0 |
| BUILDING TYPE           | 000%   | 0 |
| BSMT FINISH             | 0 S.F. | 0 |
| FIREPLACE #             | 0      | 0 |
| HEATING                 | 0 S.F. | 0 |
| AIR COND                | 0 S.F. | 0 |
| PLUMBING #              | 0      | 0 |
| GARAGES & CARPORTS      |        | 0 |
| EXTRA FEATURES          |        | 0 |
| <b>SUBTOTAL</b>         |        | 0 |
| GRADE FACTOR            |        | % |
| <b>UNADJUSTED VALUE</b> |        | 0 |
| FACTOR                  |        | % |

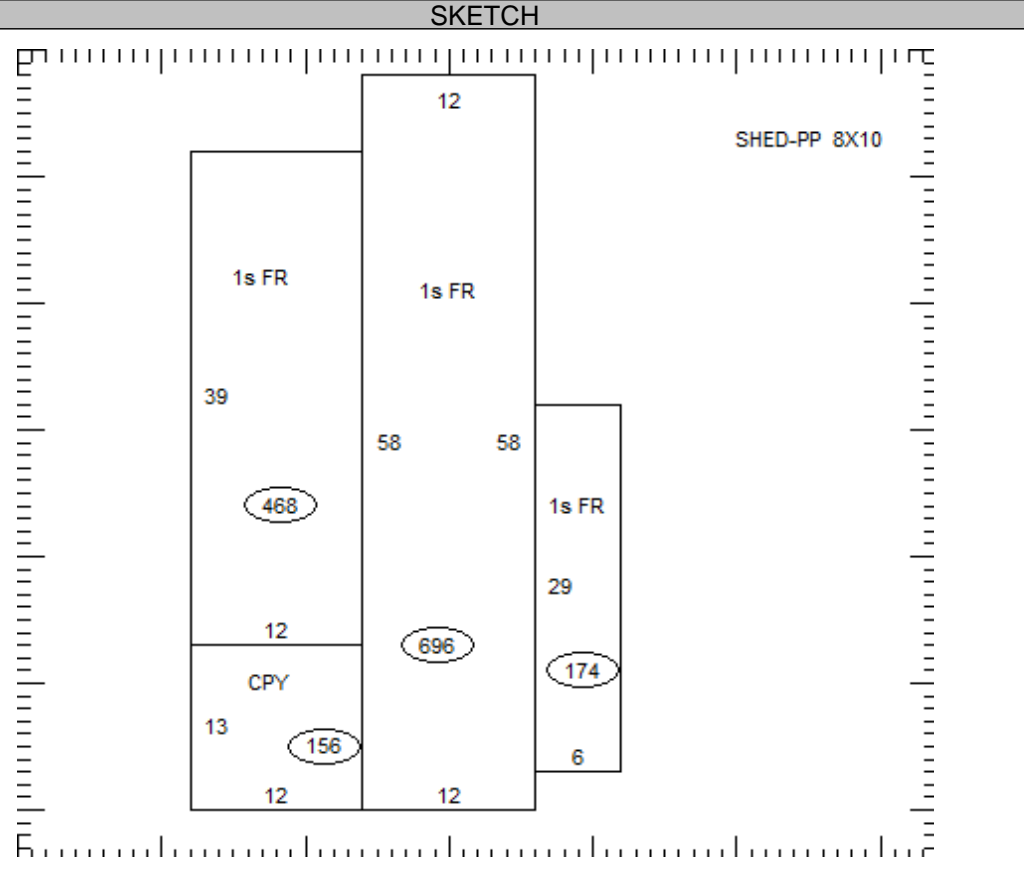

| OCCUPANCY   | ST.HT | SIZE | AREA | GRADE | PRICE | AGE | REMD | CND | UNADJ VAL | PHYS | PHYS VAL | FUNC | TRUE VAL |
|-------------|-------|------|------|-------|-------|-----|------|-----|-----------|------|----------|------|----------|
| MOBILE HOME |       | SK   |      |       |       |     |      |     |           |      |          |      |          |
| 1           |       |      |      |       |       |     |      |     |           |      |          |      |          |
| 2           |       |      |      |       |       |     |      |     |           |      |          |      |          |
| 3           |       |      |      |       |       |     |      |     |           |      |          |      |          |
| 4           |       |      |      |       |       |     |      |     |           |      |          |      |          |
| 5           |       |      |      |       |       |     |      |     |           |      |          |      |          |
| 6           |       |      |      |       |       |     |      |     |           |      |          |      |          |
| 7           |       |      |      |       |       |     |      |     |           |      |          |      |          |
| 8           |       |      |      |       |       |     |      |     |           |      |          |      |          |
| 9           |       |      |      |       |       |     |      |     |           |      |          |      |          |
| 10          |       |      |      |       |       |     |      |     |           |      |          |      |          |
| 11          |       |      |      |       |       |     |      |     |           |      |          |      |          |

26-700093.M000

**TOTAL** 0

**COMMENTS**