

OCCUPANCY
 SF DU TR
 CONVERSION
BUILDING TYPE
 MOBILE HOME
 BI/TR LEVEL
 MOD/MAN

FLOOR	AREA	CONST	VALUE
1	1528	FR	204,190

ROOFING
 METAL
 SLT/TLE
 SHINGLES
 SHAKES
 COMPOSITE

EXTERIOR
 WOOD
 STUCCO
 ALM/VYNL
 CONC BLK
 METAL
 BRICK
 STONE

ROOF TYPE
 GABLE
 HIP
 GAMBREL
 MANSARD
 FLAT

FLOORS B 1 2 3 U
 CONCRETE
 WOOD
 TILE/COMPO
 CARPET

SUBTOTAL 204,190

MULTI-FAMILY # 0 0
 BUILDING TYPE 100% 0
 BSMT FINISH 0 S.F. 0
 FIREPLACE # 0 0
 HEATING 0 S.F. 0
 AIR COND 1,528 S.F. 2,520
 PLUMBING # 3 3,630
 GARAGES & CARPORTS 13,600
 EXTRA FEATURES 4,100

INT. FINISH B 1 2 3 U
 PLASTER/DW
 PANELING
 UNFINISHED

SUBTOTAL 228,040

GRADE FACTOR 105 %
UNADJUSTED VALUE 239,440
 FACTOR 100 %

ACCOMMODATIONS
 # OF ROOMS 6
 BEDROOMS 3
 FIREPLACES
 HEAT & AC B 1 2 3 U

OCCUPANCY ST.HT SIZE AREA GRADE PRICE AGE REMD CND UNADJ VAL PHYS PHYS VAL FUNC TRUE VAL

NO HEAT
 CTRL HEAT
 HW/STEAM
 ELECTRIC
 HEAT PUMP
 FLR/WALL
 STVE/SPCE
 GEOTHERMAL
 OUTSIDE
 CTRL A/C

OCCUPANCY	ST.HT	SIZE	AREA	GRADE	PRICE	AGE	REMD	CND	UNADJ VAL	PHYS	PHYS VAL	FUNC	TRUE VAL
DWELLING	1	SK	1,528	C+		1998		A	239,440	22	186,760		186,800
1													
2													
3													
4													
5													
6													
7													
8													
9													
10													
11													

PLUMBING BASE
 X FULL BATH 1
 X HALF BATH
 X FIXTURES

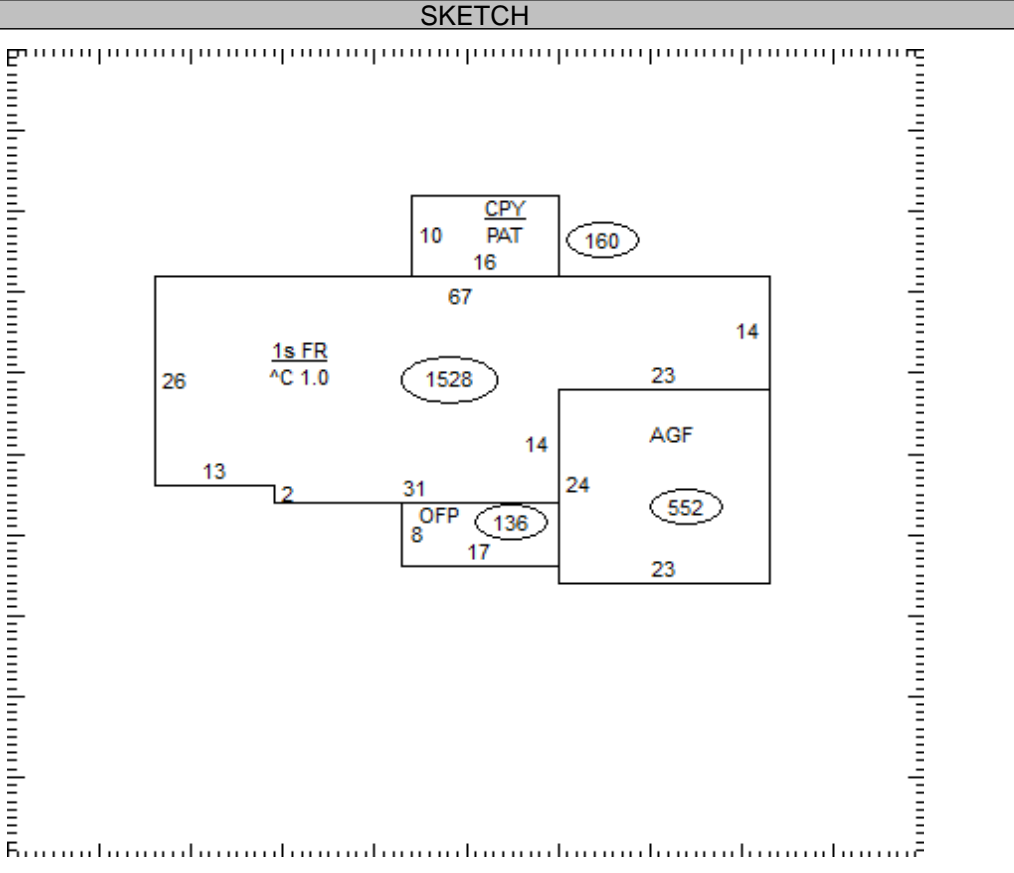

26-243700.0600

TOTAL 186,800

COMMENTS
 IRREGULAR LOT. 32 LINEAL FEET BRICK TRIM 8FT HIGH
 Dwelling has an Economic Factor of 100%