

| OCCUPANCY | EXTERIOR | FLOOR | AREA | CONST | VALUE |
|--|---|-------|------|-------|---------|
| <input checked="" type="checkbox"/> SF <input type="checkbox"/> DU <input type="checkbox"/> TR | <input type="checkbox"/> WOOD | 1 | 1392 | BRK | 209,290 |
| <input type="checkbox"/> CONVERSION | <input type="checkbox"/> STUCCO | .25 | 340 | BRK | 46,690 |
| BUILDING TYPE | <input type="checkbox"/> ALM/VYNL | | | | |
| <input type="checkbox"/> MOBILE HOME | <input type="checkbox"/> CONC BLK | | | | |
| <input type="checkbox"/> BI/TR LEVEL | <input type="checkbox"/> METAL | | | | |
| <input type="checkbox"/> MOD/MAN | <input checked="" type="checkbox"/> BRICK | | | | |
| <input type="checkbox"/> | <input type="checkbox"/> STONE | | | | |

| ROOFING | ROOF TYPE |
|--|---|
| <input type="checkbox"/> METAL | <input type="checkbox"/> GABLE |
| <input type="checkbox"/> SLT/TLE | <input checked="" type="checkbox"/> HIP |
| <input checked="" type="checkbox"/> SHINGLES | <input type="checkbox"/> GAMBREL |
| <input type="checkbox"/> SHAKES | <input type="checkbox"/> MANSARD |
| <input type="checkbox"/> COMPOSITE | <input type="checkbox"/> FLAT |

| FLOORS | B | 1 | 2 | 3 | U |
|----------------|-------------------------------------|-------------------------------------|-------------------------------------|-------------------------------------|--------------------------|
| CONCRETE | <input checked="" type="checkbox"/> | <input type="checkbox"/> | <input type="checkbox"/> | <input type="checkbox"/> | <input type="checkbox"/> |
| WOOD | <input type="checkbox"/> | <input checked="" type="checkbox"/> | <input checked="" type="checkbox"/> | <input type="checkbox"/> | <input type="checkbox"/> |
| TILE/COMPO | <input type="checkbox"/> | <input checked="" type="checkbox"/> | <input type="checkbox"/> | <input type="checkbox"/> | <input type="checkbox"/> |
| CARPET | <input type="checkbox"/> | <input checked="" type="checkbox"/> | <input checked="" type="checkbox"/> | <input type="checkbox"/> | <input type="checkbox"/> |
| INT. FINISH | B | 1 | 2 | 3 | U |
| PLASTER/DW | <input type="checkbox"/> | <input checked="" type="checkbox"/> | <input checked="" type="checkbox"/> | <input type="checkbox"/> | <input type="checkbox"/> |
| PANELING | <input type="checkbox"/> | <input type="checkbox"/> | <input type="checkbox"/> | <input type="checkbox"/> | <input type="checkbox"/> |
| UNFINISHED | <input checked="" type="checkbox"/> | <input type="checkbox"/> | <input type="checkbox"/> | <input type="checkbox"/> | <input type="checkbox"/> |
| ACCOMMODATIONS | | | | | |
| # OF ROOMS | | 5 | 2 | | |
| BEDROOMS | | 2 | 2 | | |
| FIREPLACES | | 1 | | | |
| HEAT & AC | B | 1 | 2 | 3 | U |
| NO HEAT | <input type="checkbox"/> | <input type="checkbox"/> | <input type="checkbox"/> | <input type="checkbox"/> | <input type="checkbox"/> |
| CTRL HEAT | <input type="checkbox"/> | <input checked="" type="checkbox"/> | <input checked="" type="checkbox"/> | <input type="checkbox"/> | <input type="checkbox"/> |
| HW/STEAM | <input type="checkbox"/> | <input type="checkbox"/> | <input type="checkbox"/> | <input type="checkbox"/> | <input type="checkbox"/> |
| ELECTRIC | <input type="checkbox"/> | <input type="checkbox"/> | <input type="checkbox"/> | <input type="checkbox"/> | <input type="checkbox"/> |
| HEAT PUMP | <input type="checkbox"/> | <input type="checkbox"/> | <input type="checkbox"/> | <input type="checkbox"/> | <input type="checkbox"/> |
| FLR/WALL | <input type="checkbox"/> | <input type="checkbox"/> | <input type="checkbox"/> | <input type="checkbox"/> | <input type="checkbox"/> |
| STVE/SPCE | <input type="checkbox"/> | <input type="checkbox"/> | <input type="checkbox"/> | <input type="checkbox"/> | <input type="checkbox"/> |
| GEO THERMAL | <input type="checkbox"/> | <input type="checkbox"/> | <input type="checkbox"/> | <input type="checkbox"/> | <input type="checkbox"/> |
| OUTSIDE | <input type="checkbox"/> | <input type="checkbox"/> | <input type="checkbox"/> | <input type="checkbox"/> | <input type="checkbox"/> |
| CTRL A/C | <input type="checkbox"/> | <input checked="" type="checkbox"/> | <input checked="" type="checkbox"/> | <input type="checkbox"/> | <input type="checkbox"/> |
| PLUMBING | | | BASE | <input checked="" type="checkbox"/> | |
| X FULL BATH | | | 1 | | |
| X HALF BATH | | | | | |
| X FIXTURES | | | | | |

| | | | |
|-------------------------|------------|--|---------|
| BSMT | 1074 | | 15,360 |
| SUBTOTAL | | | 271,340 |
| MULTI-FAMILY # | 0 | | 0 |
| BUILDING TYPE | 100% | | 0 |
| BSMT FINISH | 0 S.F. | | 0 |
| FIREPLACE # | 1 | | 4,400 |
| HEATING | 0 S.F. | | 0 |
| AIR COND | 1,732 S.F. | | 2,860 |
| PLUMBING # | 3 | | 3,630 |
| GARAGES & CARPORTS | | | 1,400 |
| EXTRA FEATURES | | | 2,000 |
| SUBTOTAL | | | 285,630 |
| GRADE FACTOR | | | 100 % |
| UNADJUSTED VALUE | | | 285,630 |
| FACTOR | | | 100 % |

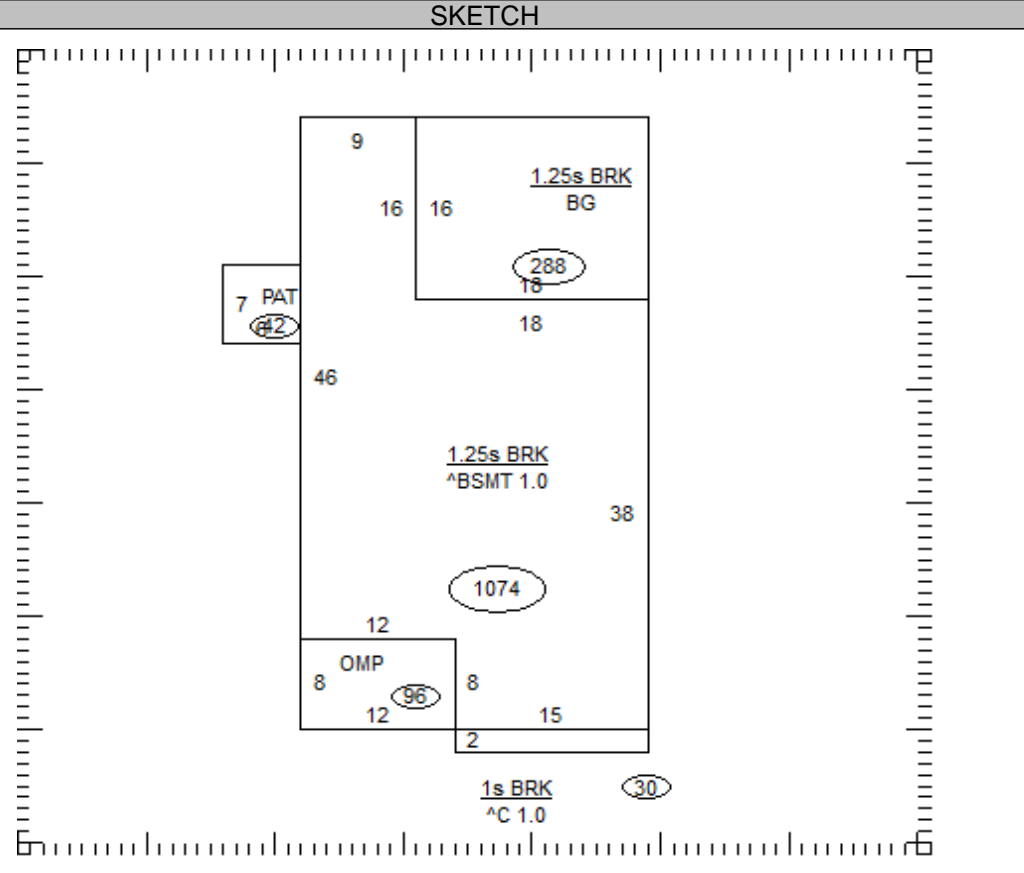

| OCCUPANCY | ST.HT | SIZE | AREA | GRADE | PRICE | AGE | REMD | CND | UNADJ VAL | PHYS | PHYS VAL | FUNC | TRUE VAL |
|-----------|-------|------|-------|-------|-------|------|------|-----|-----------|------|----------|------|----------|
| DWELLING | 1.25 | SK | 1,732 | C | | 1937 | | A | 285,630 | 45 | 157,100 | | 149,200 |
| 1 | | | | | | | | | | | | | |
| 2 | | | | | | | | | | | | | |
| 3 | | | | | | | | | | | | | |
| 4 | | | | | | | | | | | | | |
| 5 | | | | | | | | | | | | | |
| 6 | | | | | | | | | | | | | |
| 7 | | | | | | | | | | | | | |
| 8 | | | | | | | | | | | | | |
| 9 | | | | | | | | | | | | | |
| 10 | | | | | | | | | | | | | |
| 11 | | | | | | | | | | | | | |

17-036500.0000

TOTAL 149,200

COMMENTS

Dwelling has an Economic Factor of 95%

