



OCCUPANCY	EXTERIOR	FLOOR	AREA	CONST	VALUE
<input checked="" type="checkbox"/> SF <input type="checkbox"/> DU <input type="checkbox"/> TR	<input type="checkbox"/> WOOD	1	1977	FR	233,440
<input type="checkbox"/> CONVERSION	<input type="checkbox"/> STUCCO				
<b>BUILDING TYPE</b>	<input checked="" type="checkbox"/> ALM/VYNL				
<input type="checkbox"/> MOBILE HOME	<input type="checkbox"/> CONC BLK				
<input type="checkbox"/> BI/TR LEVEL	<input type="checkbox"/> METAL				
<input type="checkbox"/> MOD/MAN	<input type="checkbox"/> BRICK				
<input type="checkbox"/>	<input checked="" type="checkbox"/> STONE				

ROOFING	ROOF TYPE
<input type="checkbox"/> METAL	<input type="checkbox"/> GABLE
<input type="checkbox"/> SLT/TLE	<input checked="" type="checkbox"/> HIP
<input checked="" type="checkbox"/> SHINGLES	<input type="checkbox"/> GAMBREL
<input type="checkbox"/> SHAKES	<input type="checkbox"/> MANSARD
<input type="checkbox"/> COMPOSITE	<input type="checkbox"/> FLAT

BSMT	1457	20,840
<b>SUBTOTAL</b>		254,280
MULTI-FAMILY #	0	0
BUILDING TYPE	100%	0
BSMT FINISH	728 S.F.	10,410
FIREPLACE #	0	0
HEATING	0 S.F.	0
AIR COND	2,705 S.F.	4,460
PLUMBING #	6	7,260
GARAGES & CARPORTS		0
EXTRA FEATURES		3,400
<b>SUBTOTAL</b>		279,810
GRADE FACTOR		105 %
<b>UNADJUSTED VALUE</b>		293,800
FACTOR		100 %

OCCUPANCY	ST.HT	SIZE	AREA	GRADE	PRICE	AGE	REMD	CND	UNADJ VAL	PHYS	PHYS VAL	FUNC	TRUE VAL
DWELLING	1	SK	1,977	C+		1955		A	293,800	42	170,400		196,000
1 Gar - Frame		22x28	616	C	23.70	1972		A	14,600	85	2,190		2,200
2 Shed	PP	10x15	150	C		2022		A		2			0
3 Pool - PP		18x18	324	C		2022		G		1			0
4													
5													
6													
7													
8													
9													
10													
11													

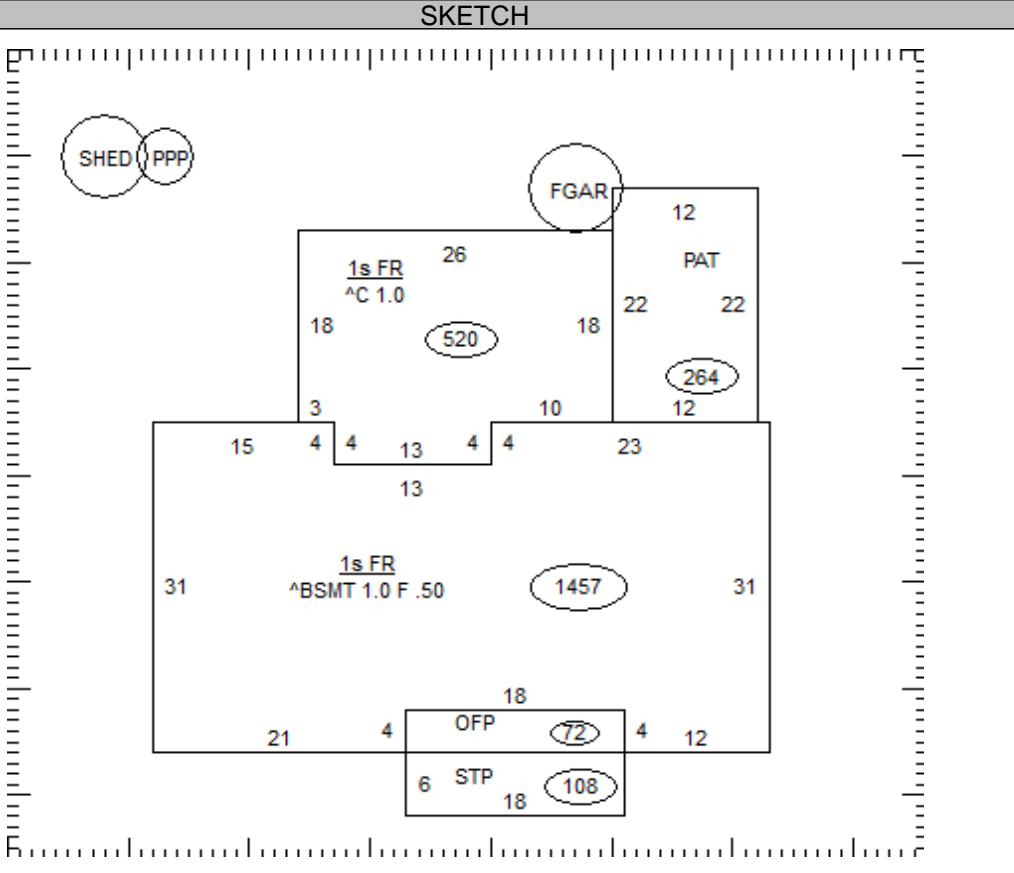

17-009000.0000

TOTAL 198,200

COMMENTS

46 L/F STONE TRIM 4' HIGH  
 Dwelling has an Economic Factor of 115%