

OCCUPANCY
 SF DU TR
 CONVERSION
BUILDING TYPE
 MOBILE HOME
 BI/TR LEVEL
 MOD/MAN

FLOOR	AREA	CONST	VALUE
1	1240	FR	183,580

ROOFING
 METAL
 SLT/TLE
 SHINGLES
 SHAKES
 COMPOSITE

ROOF TYPE
 WOOD
 STUCCO
 ALM/VYNL
 CONC BLK
 METAL
 BRICK
 STONE

ROOFING	ROOF TYPE	VALUE

FLOORS
 CONCRETE
 WOOD
 TILE/COMPO
 CARPET

SUBTOTAL		183,580
MULTI-FAMILY #	0	0
BUILDING TYPE	100%	0
BSMT FINISH	0 S.F.	0
FIREPLACE #	0	0
HEATING	0 S.F.	0
AIR COND	1,240 S.F.	2,050
PLUMBING #	3	3,630
GARAGES & CARPORTS		15,800
EXTRA FEATURES		9,200
SUBTOTAL		214,260
GRADE FACTOR		100 %
UNADJUSTED VALUE		214,260
FACTOR		100 %

INT. FINISH
 PLASTER/DW
 PANELING
 UNFINISHED

SUBTOTAL		214,260
GRADE FACTOR		100 %
UNADJUSTED VALUE		214,260
FACTOR		100 %

ACCOMMODATIONS
 # OF ROOMS
 BEDROOMS
 FIREPLACES

SUBTOTAL		214,260
GRADE FACTOR		100 %
UNADJUSTED VALUE		214,260
FACTOR		100 %

HEAT & AC
 NO HEAT
 CTRL HEAT
 HW/STEAM
 ELECTRIC
 HEAT PUMP
 FLR/WALL
 STVE/SPCE
 GEOTHERMAL
 OUTSIDE
 CTRL A/C

OCCUPANCY	ST.HT	SIZE	AREA	GRADE	PRICE	AGE	REMD	CND	UNADJ VAL	PHYS	PHYS VAL	FUNC	TRUE VAL
DWELLING	1	SK	1,240	C		1900		A	214,260	45	117,840		111,900
1 Gar - Brick	8	24x32	768	D	22.86	1900		A	17,560	95	880		900
2													
3													
4													
5													
6													
7													
8													
9													
10													
11													

PLUMBING
 X FULL BATH
 X HALF BATH
 X FIXTURES

SUBTOTAL		214,260
GRADE FACTOR		100 %
UNADJUSTED VALUE		214,260
FACTOR		100 %

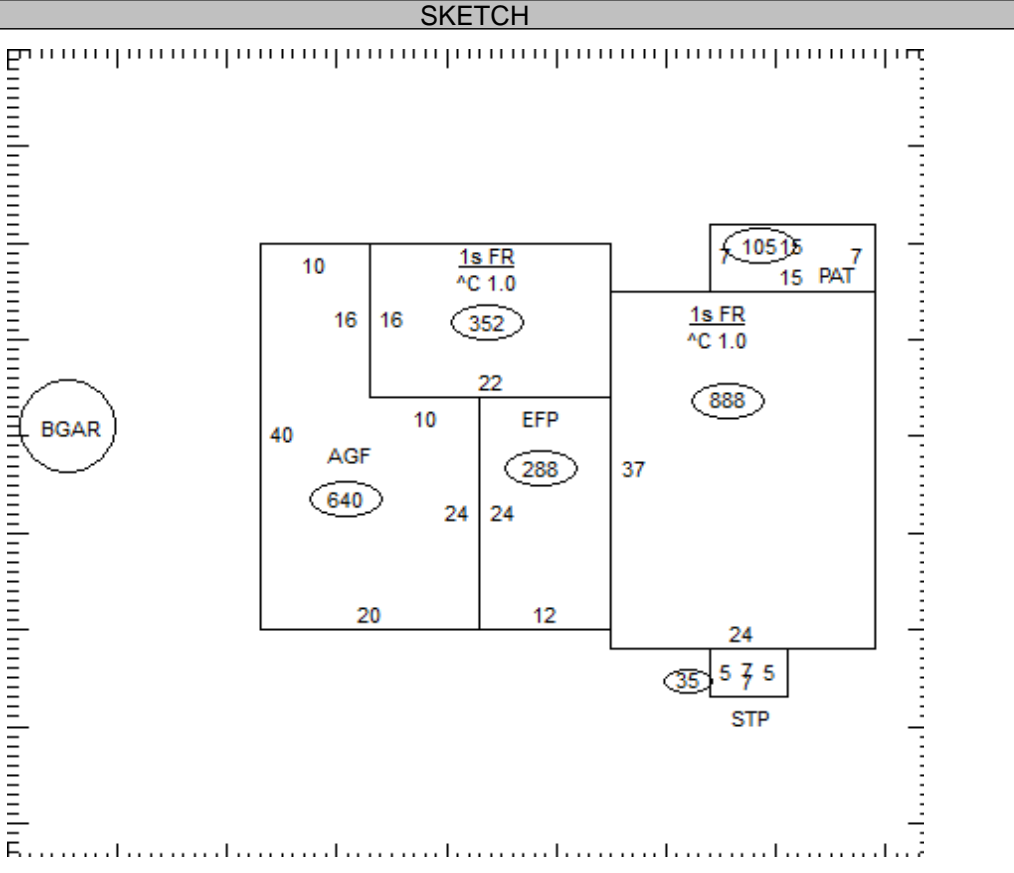

14-002000.0000

TOTAL 112,800

COMMENTS

Dwelling has an Economic Factor of 95%