



**OCCUPANCY**  
 SF  DU  TR  
 CONVERSION  
**BUILDING TYPE**  
 MOBILE HOME  
 BI/TR LEVEL  
 MOD/MAN

FLOOR	AREA	CONST	VALUE
1	2544	FR	275,690

**ROOFING**  
 METAL  
 SLT/TLE  
 SHINGLES  
 SHAKES  
 COMPOSITE

**ROOF TYPE**  
 WOOD  
 STUCCO  
 ALM/VYNL  
 CONC BLK  
 METAL  
 BRICK  
 STONE

ROOFING	ROOF TYPE
<input type="checkbox"/> METAL	<input checked="" type="checkbox"/> GABLE
<input type="checkbox"/> SLT/TLE	<input type="checkbox"/> HIP
<input checked="" type="checkbox"/> SHINGLES	<input type="checkbox"/> GAMBREL
<input type="checkbox"/> SHAKES	<input type="checkbox"/> MANSARD
<input type="checkbox"/> COMPOSITE	<input type="checkbox"/> FLAT

**FLOORS** B 1 2 3 U  
 CONCRETE       
 WOOD       
 TILE/COMPO       
 CARPET

SUBTOTAL		275,690
MULTI-FAMILY #	0	0
BUILDING TYPE	100%	0
BSMT FINISH	0 S.F.	0
FIREPLACE #	0	0
HEATING	0 S.F.	0
AIR COND	2,544 S.F.	4,200
PLUMBING #	3	3,630
GARAGES & CARPORTS		14,200
EXTRA FEATURES		1,200
SUBTOTAL		298,920
GRADE FACTOR		100 %
UNADJUSTED VALUE		298,920
FACTOR		100 %

**INT. FINISH** B 1 2 3 U  
 PLASTER/DW       
 PANELING       
 UNFINISHED

ACCOMMODATIONS	
# OF ROOMS	8
BEDROOMS	5
FIREPLACES	
HEAT & AC	B 1 2 3 U
NO HEAT	<input type="checkbox"/> <input type="checkbox"/> <input type="checkbox"/> <input type="checkbox"/> <input type="checkbox"/>
CTRL HEAT	<input type="checkbox"/> <input checked="" type="checkbox"/> <input type="checkbox"/> <input type="checkbox"/> <input type="checkbox"/>
HW/STEAM	<input type="checkbox"/> <input type="checkbox"/> <input type="checkbox"/> <input type="checkbox"/> <input type="checkbox"/>
ELECTRIC	<input type="checkbox"/> <input type="checkbox"/> <input type="checkbox"/> <input type="checkbox"/> <input type="checkbox"/>
HEAT PUMP	<input type="checkbox"/> <input type="checkbox"/> <input type="checkbox"/> <input type="checkbox"/> <input type="checkbox"/>
FLR/WALL	<input type="checkbox"/> <input type="checkbox"/> <input type="checkbox"/> <input type="checkbox"/> <input type="checkbox"/>
STVE/SPCE	<input type="checkbox"/> <input type="checkbox"/> <input type="checkbox"/> <input type="checkbox"/> <input type="checkbox"/>
GEOHERMAL	<input type="checkbox"/> <input type="checkbox"/> <input type="checkbox"/> <input type="checkbox"/> <input type="checkbox"/>
OUTSIDE	<input type="checkbox"/> <input type="checkbox"/> <input type="checkbox"/> <input type="checkbox"/> <input type="checkbox"/>
CTRL A/C	<input type="checkbox"/> <input checked="" type="checkbox"/> <input type="checkbox"/> <input type="checkbox"/> <input type="checkbox"/>
PLUMBING	BASE <input checked="" type="checkbox"/>
X FULL BATH	1
X HALF BATH	
X FIXTURES	

**ACCOMMODATIONS**  
 # OF ROOMS 8  
 BEDROOMS 5  
 FIREPLACES  
 HEAT & AC B 1 2 3 U

OCCUPANCY	ST.HT	SIZE	AREA	GRADE	PRICE	AGE	REMD	CND	UNADJ VAL	PHYS	PHYS VAL	FUNC	TRUE VAL
DWELLING	1	SK	2,544	C		1954		A	298,920	42	173,370		130,000
1 Lean - To		9x12	108	C	4.80	1954		A	520	90	50		100
2 Shed		14x20	280	C	7.70	1954		A	2,160	90	220		200
3													
4													
5													
6													
7													
8													
9													
10													
11													

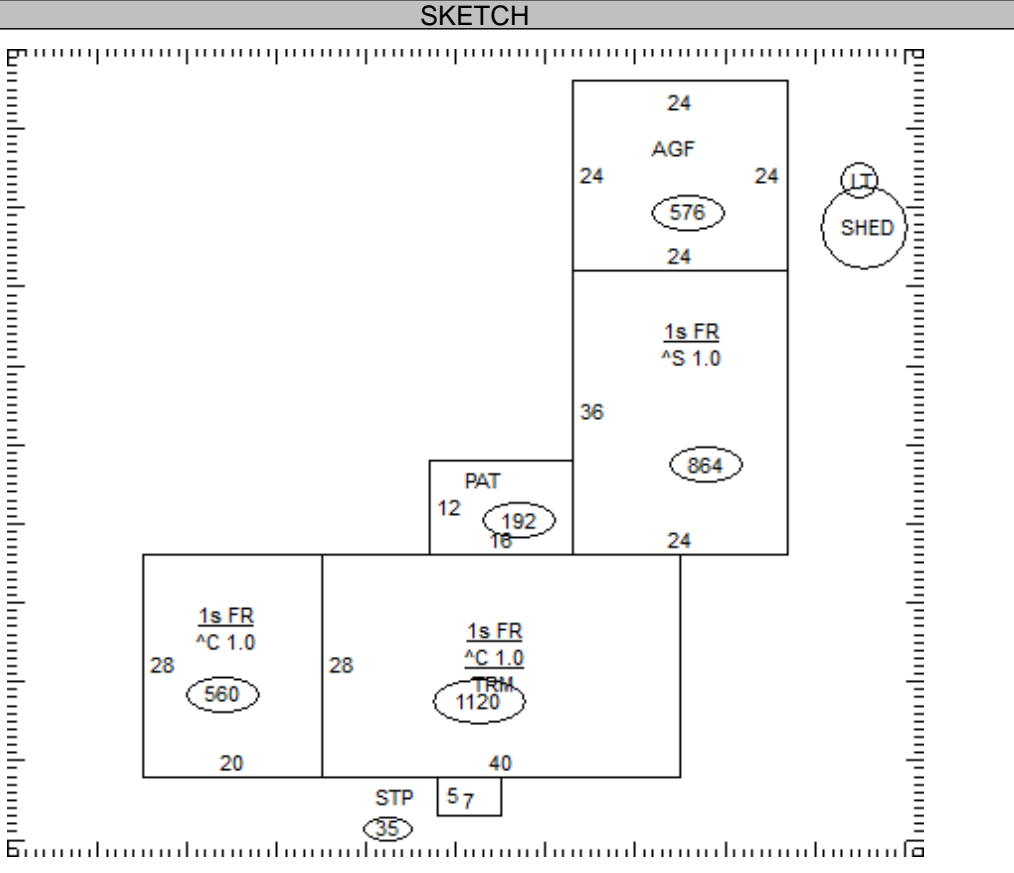

**HEAT & AC** B 1 2 3 U  
 NO HEAT       
 CTRL HEAT       
 HW/STEAM       
 ELECTRIC       
 HEAT PUMP       
 FLR/WALL       
 STVE/SPCE       
 GEOHERMAL       
 OUTSIDE       
 CTRL A/C

OCCUPANCY	ST.HT	SIZE	AREA	GRADE	PRICE	AGE	REMD	CND	UNADJ VAL	PHYS	PHYS VAL	FUNC	TRUE VAL
DWELLING	1	SK	2,544	C		1954		A	298,920	42	173,370		130,000
1 Lean - To		9x12	108	C	4.80	1954		A	520	90	50		100
2 Shed		14x20	280	C	7.70	1954		A	2,160	90	220		200
3													
4													
5													
6													
7													
8													
9													
10													
11													

08-042400.0000 TOTAL 130,300

**COMMENTS**

60 L/F BRICK 4 (240)  
 Dwelling has an Economic Factor of 75% (Rollback Basis=\$184,900)