



**OCCUPANCY**  
 SF  DU  TR  
 CONVERSION

**BUILDING TYPE**  
 MOBILE HOME  
 BI/TR LEVEL  
 MOD/MAN

**EXTERIOR**  
 WOOD  
 STUCCO  
 ALM/VYNL  
 CONC BLK  
 METAL  
 BRICK  
 STONE

**ROOFING**  
 METAL  
 SLT/TLE  
 SHINGLES  
 SHAKES  
 COMPOSITE

**ROOF TYPE**  
 GABLE  
 HIP  
 GAMBREL  
 MANSARD  
 FLAT

**FLOORS** B 1 2 3 U  
 CONCRETE       
 WOOD       
 TILE/COMPO       
 CARPET

**INT. FINISH** B 1 2 3 U  
 PLASTER/DW       
 PANELING       
 UNFINISHED

**ACCOMMODATIONS**  
 # OF ROOMS 6  
 BEDROOMS 3  
 FIREPLACES  
 HEAT & AC B 1 2 3 U

NO HEAT       
 CTRL HEAT       
 HW/STEAM       
 ELECTRIC       
 HEAT PUMP       
 FLR/WALL       
 STVE/SPCE       
 GEOTHERMAL       
 OUTSIDE       
 CTRL A/C

**PLUMBING** BASE   
 X FULL BATH  
 X HALF BATH  
 X FIXTURES

FLOOR	AREA	CONST	VALUE
1	1086	FR	169,390
<b>SUBTOTAL</b>			169,390
MULTI-FAMILY #	0		0
BUILDING TYPE	100%		0
BSMT FINISH	0 S.F.		0
FIREPLACE #	0		0
HEATING	0 S.F.		0
AIR COND	1,086 S.F.		1,790
PLUMBING #	0		0
GARAGES & CARPORTS			0
EXTRA FEATURES			2,600
<b>SUBTOTAL</b>			173,780
GRADE FACTOR			85 %
<b>UNADJUSTED VALUE</b>			147,710
FACTOR			100 %

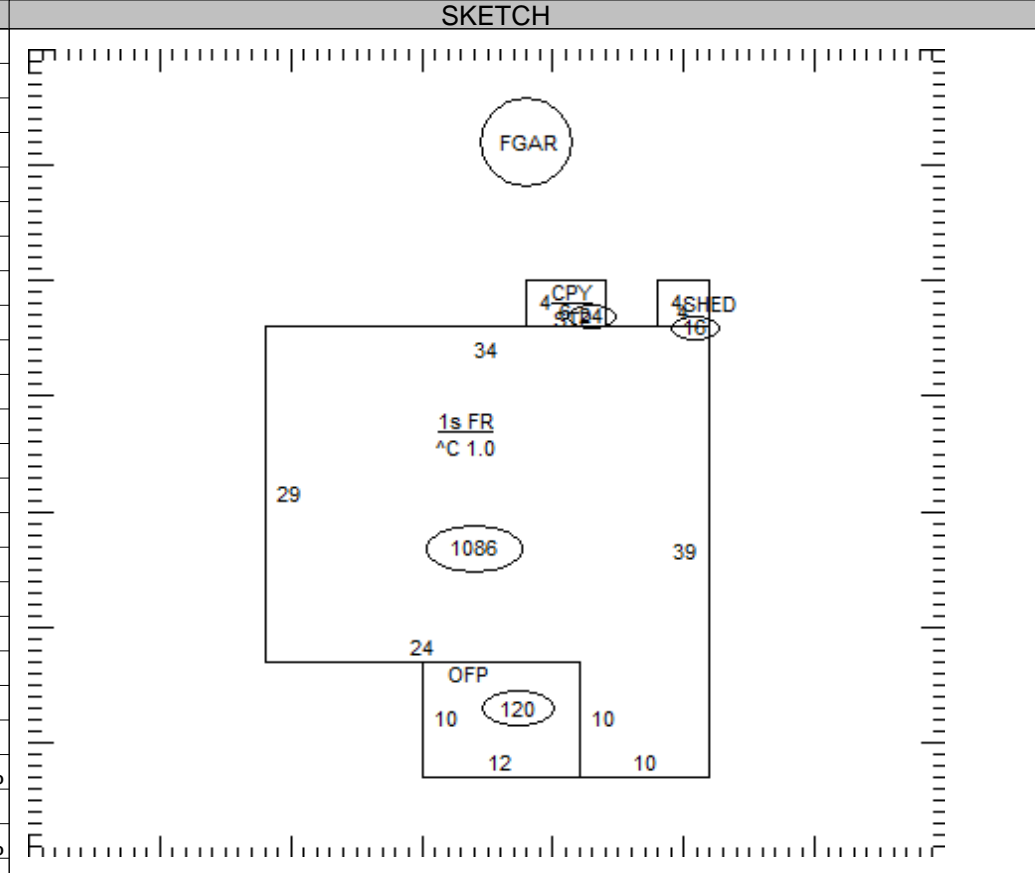

OCCUPANCY	ST.HT	SIZE	AREA	GRADE	PRICE	AGE	REMD	CND	UNADJ VAL	PHYS	PHYS VAL	FUNC	TRUE VAL
DWELLING	1	SK	1,086	D+		1937	1987	A	147,710	40	88,630		62,000
1 Gar - Frame		24x26	624	C	23.70	1953		A	14,790	90	1,480		1,500
2													
3													
4													
5													
6													
7													
8													
9													
10													
11													

06-028300.0000 TOTAL 63,500

**COMMENTS**

VINYL SIDING  
 Dwelling has an Economic Factor of 70%



