

OCCUPANCY
 SF DU TR
 CONVERSION
BUILDING TYPE
 MOBILE HOME
 BI/TR LEVEL
 MOD/MAN

FLOOR	AREA	CONST	VALUE
1	2053	FR	237,450

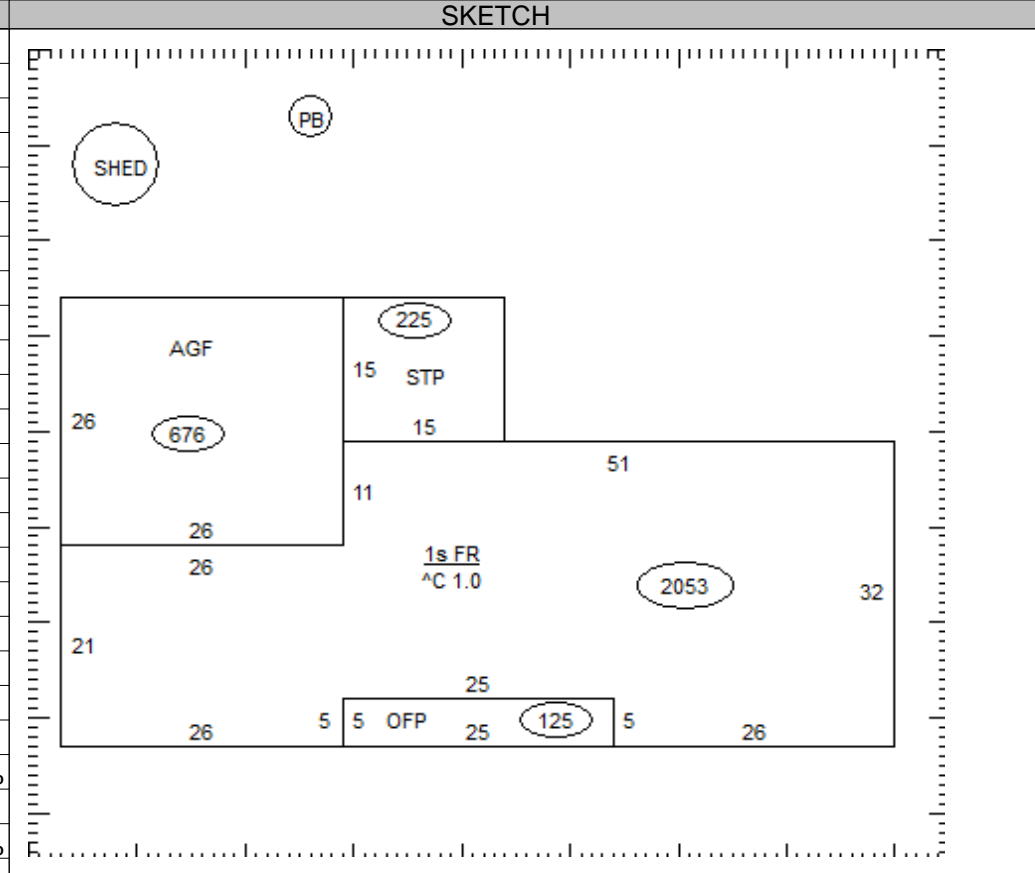

ROOFING
 METAL
 SLT/TLE
 SHINGLES
 SHAKES
 COMPOSITE

ROOF TYPE
 GABLE
 HIP
 GAMBREL
 MANSARD
 FLAT

SUBTOTAL			237,450
MULTI-FAMILY #	0		0
BUILDING TYPE	100%		0
BSMT FINISH	0 S.F.		0
FIREPLACE #	0		0
HEATING	0 S.F.		0
AIR COND	2,053 S.F.		3,390
PLUMBING #	5		6,050
GARAGES & CARPORTS			16,700
EXTRA FEATURES			4,300
SUBTOTAL			267,890
GRADE FACTOR			105 %
UNADJUSTED VALUE			281,280
FACTOR			100 %

FLOORS B 1 2 3 U
 CONCRETE
 WOOD
 TILE/COMPO
 CARPET

SUBTOTAL			267,890
GRADE FACTOR			105 %
UNADJUSTED VALUE			281,280
FACTOR			100 %

INT. FINISH B 1 2 3 U
 PLASTER/DW
 PANELING
 UNFINISHED

SUBTOTAL			267,890
GRADE FACTOR			105 %
UNADJUSTED VALUE			281,280
FACTOR			100 %

ACCOMMODATIONS
 # OF ROOMS 5
 BEDROOMS 3
 FIREPLACES

SUBTOTAL			267,890
GRADE FACTOR			105 %
UNADJUSTED VALUE			281,280
FACTOR			100 %

HEAT & AC B 1 2 3 U
 NO HEAT
 CTRL HEAT
 HW/STEAM
 ELECTRIC
 HEAT PUMP
 FLR/WALL
 STVE/SPCE
 GEOTHERMAL
 OUTSIDE
 CTRL A/C

OCCUPANCY	ST.HT	SIZE	AREA	GRADE	PRICE	AGE	REMD	CND	UNADJ VAL	PHYS	PHYS VAL	FUNC	TRUE VAL
DWELLING	1	SK	2,053	C+		2000		A	281,280	22	219,400		230,400
1 Shed	PP	10x12	120	C		2000		A		37			0
2 Pole Bldg		60x100	6,000	C	13.75	2019		A	82,500	4	79,200		79,200
3													
4													
5													
6													
7													
8													
9													
10													
11													

PLUMBING BASE
 X FULL BATH 1
 X HALF BATH 1
 X FIXTURES

TOTAL													309,600
COMMENTS													
>>OB Features: 1.2 <Add Concrete Floor> Dwelling has an Economic Factor of 105%													

06-014000.0100

TOTAL 309,600

COMMENTS

>>OB Features: 1.2 <Add Concrete Floor>
Dwelling has an Economic Factor of 105%