

BUTLER TWP-COLDWATER CORP / COLDWATER SD
08-27-426-004

05-246000.0200

BROOKHART BRADLEY M & LILLIAN M
BROOKHART BRADLEY M & LILLIAN M
907 SOUTHWOOD DR
COLDWATER, OH 45828

LEGAL INFORMATION
SCHWIETERMAN ADDITION

LOT#: 1671

Created in 2013 From 05-246000.0000 due to Split

OWNERSHIP	ADDRESS	CITY	STATE	ZIP	DATE	AMOUNT	DEED:CONV#	JS	VALID	
1	BROOKHART BRADLEY M &	907 SOUTHWOOD DR	COLDWATER	OH	45828	09/07/2021	464,000	WDC : 761	<input type="checkbox"/>	<input checked="" type="checkbox"/>
2	PLATFOOT KENNETH &	907 SOUTHWOOD DR	COLDWATER	OH	45828	04/24/2015	38,900	SUC : 250	<input type="checkbox"/>	<input checked="" type="checkbox"/>
3	SCHWIETERMAN RANDY ETAL	491 E KREMER HOYING RD SAINT HENRY	OH	45883	08/07/2013	0	: 0	<input type="checkbox"/>	<input type="checkbox"/>	

X: TTO LISTER: JK DATE: 02/21/2017 TIME: 12:00:00 AM LETTER LETTER REC'D GIS CODE

STREET/ROAD	TOPOGRAPHY	PU-UTILITIES-PR	NEIGHBORHOOD	INFLUENCE FACTORS	PROPERTY LOCATION
-------------	------------	-----------------	--------------	-------------------	-------------------

<input type="checkbox"/> PAVED	<input type="checkbox"/> LEVEL	<input type="checkbox"/> WATER	<input type="checkbox"/> IMPROVING	<input type="checkbox"/> A. NO ROAD	<input type="checkbox"/> F. RESTRICT	907 SOUTHWOOD DR, COLDWATER COMMENT TY2022:Net Gen=\$4,001.34, Other Assessment=\$0.00 DE17 DWLG COMPL, ADD PAT DE16 ADD DWLG/NOH/@ 50% COMPL
<input type="checkbox"/> GRAVEL	<input type="checkbox"/> HIGH	<input type="checkbox"/> SEWER	<input type="checkbox"/> STATIC	<input type="checkbox"/> B. TOPGRHY	<input type="checkbox"/> G. WOOD LT	
<input type="checkbox"/> DIRT	<input type="checkbox"/> LOW	<input type="checkbox"/> GAS	<input type="checkbox"/> DECLINING	<input type="checkbox"/> C. Ex Front	<input type="checkbox"/> H. VACANCY	
<input type="checkbox"/> SIDEWALKS	<input type="checkbox"/> ROLLING	<input type="checkbox"/> ELECTRIC	<input type="checkbox"/> OLD	<input type="checkbox"/> D. QUANTITY	<input type="checkbox"/> I. WATER FRONT	
<input type="checkbox"/> CURBS	<input type="checkbox"/> STANDARD	<input type="checkbox"/> STANDARD	<input type="checkbox"/> STANDARD	<input type="checkbox"/> E. SZ/SHAPE	<input type="checkbox"/> J. OTHER/CDU	

LAND COMPUTATIONS

LAND TYPE	SIZE	M	RATE	C	INF	M	VALUE	C
F:Front	F100 D140	ST535	DP96	ADJ514		51,400		0
TOTAL						51,400		0

VALUATION SUMMARY

VALUE YEAR	2023	2020	2017
REASON FOR CHANGE	RAPP	RAPP	NC
APPRAISED VALUE	<u>LAND</u> 51,400	39,600	36,000
	<u>IMPR</u> 365,200	264,100	245,000
	<u>TOTAL</u> 416,600	303,700	281,000
ASSESSED VALUE	<u>LAND</u> 17,990	13,860	12,600
	<u>IMPR</u> 127,820	92,440	85,750
	<u>TOTAL</u> 145,810	106,300	98,350

OCCUPANCY	EXTERIOR	FLOOR	AREA	CONST	VALUE
<input checked="" type="checkbox"/> SF <input type="checkbox"/> DU <input type="checkbox"/> TR	<input type="checkbox"/> WOOD	1	2034	FR	237,630
<input type="checkbox"/> CONVERSION	<input type="checkbox"/> STUCCO				
BUILDING TYPE	<input checked="" type="checkbox"/> ALM/VYNL				
<input type="checkbox"/> MOBILE HOME	<input type="checkbox"/> CONC BLK				
<input type="checkbox"/> BI/TR LEVEL	<input type="checkbox"/> METAL				
<input type="checkbox"/> MOD/MAN	<input type="checkbox"/> BRICK				
<input type="checkbox"/> _____	<input type="checkbox"/> STONE				
ROOFING	ROOF TYPE				
<input type="checkbox"/> METAL	<input type="checkbox"/> GABLE				
<input type="checkbox"/> SLT/TLE	<input checked="" type="checkbox"/> HIP				
<input checked="" type="checkbox"/> SHINGLES	<input type="checkbox"/> GAMBREL				
<input type="checkbox"/> SHAKES	<input type="checkbox"/> MANSARD				
<input type="checkbox"/> COMPOSITE	<input type="checkbox"/> FLAT				
FLOORS	B 1 2 3 U	BSMT	2034		29,090
CONCRETE	<input type="checkbox"/> <input type="checkbox"/> <input type="checkbox"/> <input type="checkbox"/> <input type="checkbox"/>	SUBTOTAL			266,720
WOOD	<input type="checkbox"/> <input type="checkbox"/> <input type="checkbox"/> <input type="checkbox"/> <input type="checkbox"/>	MULTI-FAMILY #	0		0
TILE/COMPO	<input type="checkbox"/> <input checked="" type="checkbox"/> <input type="checkbox"/> <input type="checkbox"/> <input type="checkbox"/>	BUILDING TYPE	100%		0
CARPET	<input type="checkbox"/> <input checked="" type="checkbox"/> <input type="checkbox"/> <input type="checkbox"/> <input type="checkbox"/>	BSMT FINISH	0 S.F.		0
INT. FINISH	B 1 2 3 U	FIREPLACE #	1		4,400
PLASTER/DW	<input type="checkbox"/> <input checked="" type="checkbox"/> <input type="checkbox"/> <input type="checkbox"/> <input type="checkbox"/>	HEATING	0 S.F.		0
PANELING	<input type="checkbox"/> <input type="checkbox"/> <input type="checkbox"/> <input type="checkbox"/> <input type="checkbox"/>	AIR COND	2,034 S.F.		3,360
UNFINISHED	<input checked="" type="checkbox"/> <input type="checkbox"/> <input type="checkbox"/> <input type="checkbox"/> <input type="checkbox"/>	PLUMBING #	4		4,840
ACCOMMODATIONS		GARAGES & CARPORTS			20,800
# OF ROOMS		EXTRA FEATURES			3,800
BEDROOMS		SUBTOTAL			303,920
FIREPLACES		GRADE FACTOR			115 %
HEAT & AC		UNADJUSTED VALUE			349,510
		FACTOR			100 %
NO HEAT	<input type="checkbox"/> <input type="checkbox"/> <input type="checkbox"/> <input type="checkbox"/> <input type="checkbox"/>	OCCUPANCY			
CTRL HEAT	<input type="checkbox"/> <input checked="" type="checkbox"/> <input type="checkbox"/> <input type="checkbox"/> <input type="checkbox"/>	ST.HT			
HW/STEAM	<input type="checkbox"/> <input type="checkbox"/> <input type="checkbox"/> <input type="checkbox"/> <input type="checkbox"/>	SIZE			
ELECTRIC	<input type="checkbox"/> <input type="checkbox"/> <input type="checkbox"/> <input type="checkbox"/> <input type="checkbox"/>	AREA			
HEAT PUMP	<input type="checkbox"/> <input checked="" type="checkbox"/> <input type="checkbox"/> <input type="checkbox"/> <input type="checkbox"/>	GRADE			
FLR/WALL	<input type="checkbox"/> <input type="checkbox"/> <input type="checkbox"/> <input type="checkbox"/> <input type="checkbox"/>	PRICE			
STVE/SPCE	<input type="checkbox"/> <input type="checkbox"/> <input type="checkbox"/> <input type="checkbox"/> <input type="checkbox"/>	AGE			
GEO THERMAL	<input type="checkbox"/> <input type="checkbox"/> <input type="checkbox"/> <input type="checkbox"/> <input type="checkbox"/>	REMD			
OUTSIDE	<input type="checkbox"/> <input type="checkbox"/> <input type="checkbox"/> <input type="checkbox"/> <input type="checkbox"/>	CND			
CTRL A/C	<input type="checkbox"/> <input checked="" type="checkbox"/> <input type="checkbox"/> <input type="checkbox"/> <input type="checkbox"/>	UNADJ VAL			
PLUMBING	BASE <input checked="" type="checkbox"/>	PHYS			
X FULL BATH		PHYS VAL			
X HALF BATH		FUNC			
X FIXTURES		TRUE VAL			

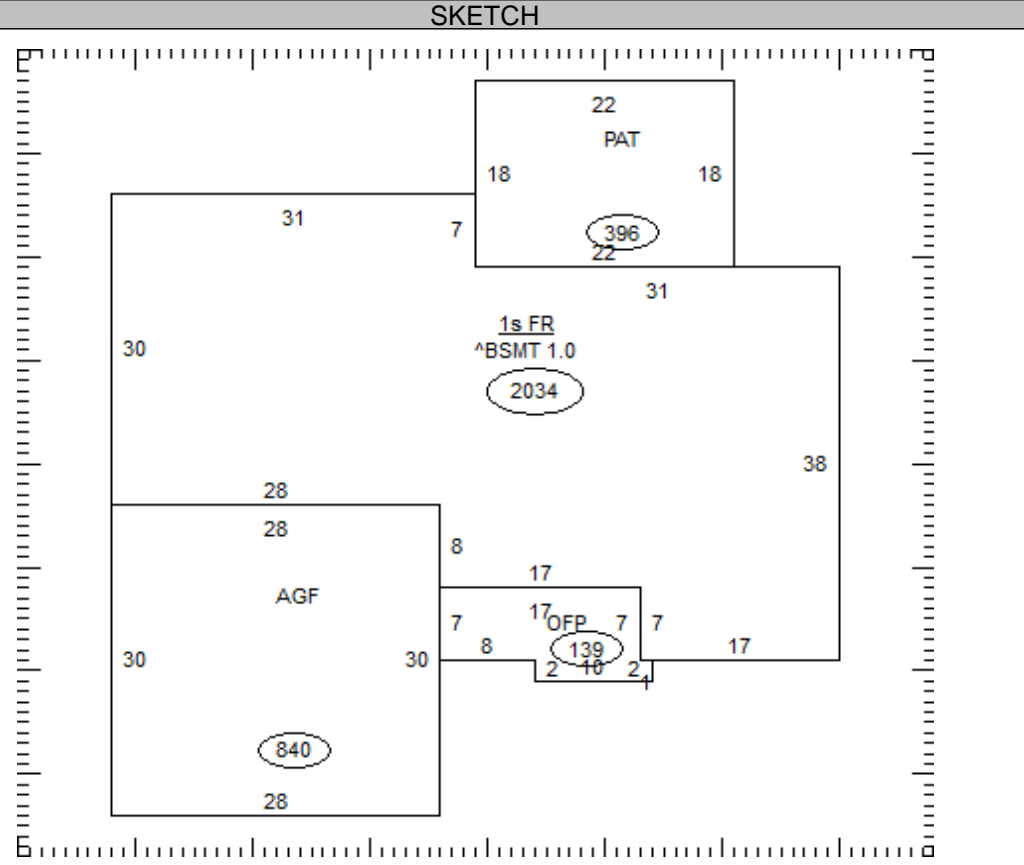

05-246000.0200

TOTAL 365,200

COMMENTS

Dwelling has an Economic Factor of 110%