



08-28-177-003

## LEGAL INFORMATION

NORTHFIELD ESTATES FIRST

ADD PLATTED 8/11/95

LOT#: 1424

Page 1 of 1	
Property Class: 510	
Neighborhood 000511-TS60	
Map: 14B3	
Block:	
Card: 15	
Bk:	Pg:

X:	<input type="checkbox"/> TTO	LISTER: NS	DATE: 12/30/2004	TIME: 12:00:00 AM	<input type="checkbox"/> LETTER	<input checked="" type="checkbox"/> LETTER REC'D	GIS CODE
----	------------------------------	------------	------------------	-------------------	---------------------------------	--	----------

<input type="checkbox"/> PAVED	<input checked="" type="checkbox"/> LEVEL	<input type="checkbox"/> WATER	<input type="checkbox"/> IMPROVING	<input type="checkbox"/> A. NO ROAD	<input type="checkbox"/> F. RESTRICT	809 PAULINE DR, COLDWATER
<input type="checkbox"/> GRAVEL	<input type="checkbox"/> HIGH	<input type="checkbox"/> SEWER	<input type="checkbox"/> STATIC	<input type="checkbox"/> B. TOPGRHY	<input type="checkbox"/> G. WOOD LT	COMMENT
<input type="checkbox"/> DIRT	<input type="checkbox"/> LOW	<input type="checkbox"/> GAS	<input type="checkbox"/> DECLINING	<input checked="" type="checkbox"/> C. Ex Front	<input type="checkbox"/> H. VACANCY	TY2022:Net Gen=\$4,716.50, Other
<input checked="" type="checkbox"/> SIDEWALKS	<input type="checkbox"/> ROLLING	<input type="checkbox"/> ELECTRIC	<input type="checkbox"/> OLD	<input type="checkbox"/> D. QUANTITY	<input type="checkbox"/> I. WATER FRONT	Assessment=\$0.00
<input type="checkbox"/> CURBS	<input type="checkbox"/> STANDARD	<input checked="" type="checkbox"/> STANDARD	<input checked="" type="checkbox"/> STANDARD	<input type="checkbox"/> E. SZ/SHAPE	<input type="checkbox"/> J. OTHER/CDU	DE16 DESKTOP RVW CHG: COR PAT

VALUATION SUMMARY	
1. Market Value	\$100,000
2. Liquidation Value	\$80,000
3. Book Value	\$60,000
4. Intrinsic Value	\$90,000
5. Fair Value	\$85,000
6. Reasonable Value	\$75,000
7. Net Value	\$50,000
8. Total Value	\$400,000

[illegible]

OCCUPANCY		EXTERIOR		FLOOR	AREA	CONST	VALUE						
<input checked="" type="checkbox"/> SF	<input type="checkbox"/> DU	<input type="checkbox"/> TR	<input type="checkbox"/> WOOD	1	2811	BRK	317,420						
<input type="checkbox"/> CONVERSION			<input type="checkbox"/> STUCCO										
BUILDING TYPE			<input type="checkbox"/> ALM/VYNL										
<input type="checkbox"/> MOBILE HOME			<input type="checkbox"/> CONC BLK										
<input type="checkbox"/> BI/TR LEVEL			<input type="checkbox"/> METAL										
<input type="checkbox"/> MOD/MAN			<input checked="" type="checkbox"/> BRICK										
<input type="checkbox"/>			<input type="checkbox"/> STONE										
ROOFING		ROOF TYPE											
<input type="checkbox"/> METAL		<input checked="" type="checkbox"/> GABLE											
<input type="checkbox"/> SLT/TLE		<input type="checkbox"/> HIP											
<input checked="" type="checkbox"/> SHINGLES		<input type="checkbox"/> GAMBREL											
<input type="checkbox"/> SHAKES		<input type="checkbox"/> MANSARD											
<input type="checkbox"/> COMPOSITE		<input type="checkbox"/> FLAT											
FLOORS		B	1	2	3	U							
CONCRETE		<input type="checkbox"/>	<input type="checkbox"/>	<input type="checkbox"/>	<input type="checkbox"/>	<input type="checkbox"/>							
WOOD		<input type="checkbox"/>	<input checked="" type="checkbox"/>	<input type="checkbox"/>	<input type="checkbox"/>	<input type="checkbox"/>							
TILE/COMPO		<input type="checkbox"/>	<input checked="" type="checkbox"/>	<input type="checkbox"/>	<input type="checkbox"/>	<input type="checkbox"/>							
CARPET		<input checked="" type="checkbox"/>	<input checked="" type="checkbox"/>	<input type="checkbox"/>	<input type="checkbox"/>	<input type="checkbox"/>							
INT. FINISH		B	1	2	3	U							
PLASTER/DW		<input checked="" type="checkbox"/>	<input checked="" type="checkbox"/>	<input type="checkbox"/>	<input type="checkbox"/>	<input type="checkbox"/>							
PANELING		<input type="checkbox"/>	<input type="checkbox"/>	<input type="checkbox"/>	<input type="checkbox"/>	<input type="checkbox"/>							
UNFINISHED		<input type="checkbox"/>	<input type="checkbox"/>	<input type="checkbox"/>	<input type="checkbox"/>	<input type="checkbox"/>							
ACCOMMODATIONS													
# OF ROOMS	3	7											
BEDROOMS	1	3											
FIREPLACES	1												
HEAT & AC		B	1	2	3	U							
NO HEAT		<input type="checkbox"/>	<input type="checkbox"/>	<input type="checkbox"/>	<input type="checkbox"/>	<input type="checkbox"/>							
CTRL HEAT		<input checked="" type="checkbox"/>	<input checked="" type="checkbox"/>	<input type="checkbox"/>	<input type="checkbox"/>	<input type="checkbox"/>							
HW/STEAM		<input type="checkbox"/>	<input type="checkbox"/>	<input type="checkbox"/>	<input type="checkbox"/>	<input type="checkbox"/>							
ELECTRIC		<input type="checkbox"/>	<input type="checkbox"/>	<input type="checkbox"/>	<input type="checkbox"/>	<input type="checkbox"/>							
HEAT PUMP		<input type="checkbox"/>	<input type="checkbox"/>	<input type="checkbox"/>	<input type="checkbox"/>	<input type="checkbox"/>							
FLR/WALL		<input type="checkbox"/>	<input type="checkbox"/>	<input type="checkbox"/>	<input type="checkbox"/>	<input type="checkbox"/>							
STVE/SPCE		<input type="checkbox"/>	<input type="checkbox"/>	<input type="checkbox"/>	<input type="checkbox"/>	<input type="checkbox"/>							
GEO THERMAL		<input type="checkbox"/>	<input type="checkbox"/>	<input type="checkbox"/>	<input type="checkbox"/>	<input type="checkbox"/>							
OUTSIDE		<input type="checkbox"/>	<input type="checkbox"/>	<input type="checkbox"/>	<input type="checkbox"/>	<input type="checkbox"/>							
CTRL A/C		<input checked="" type="checkbox"/>	<input checked="" type="checkbox"/>	<input type="checkbox"/>	<input type="checkbox"/>	<input type="checkbox"/>							
PLUMBING		BASE			<input checked="" type="checkbox"/>								
X FULL BATH	1	1											
X HALF BATH													
X FIXTURES													
BSMT	2108						30,140						
SUBTOTAL							347,560						
MULTI-FAMILY #							0						
BUILDING TYPE							100%						
BSMT FINISH							1,500 S.F.						
FIREPLACE #							1						
HEATING							0 S.F.						
AIR COND							4,311 S.F.						
PLUMBING #							6						
GARAGES & CARPORTS							21,600						
EXTRA FEATURES							4,100						
SUBTOTAL							413,490						
GRADE FACTOR							130 %						
UNADJUSTED VALUE							537,540						
FACTOR							100 %						
OCCUPANCY	ST.HT	SIZE	AREA	GRADE	PRICE	AGE	REMD	CND	UNADJ VAL	PHYS	PHYS VAL	FUNC	TRUE VAL
DWELLING	1	SK	2,811	B+		1996		A	537,540	22	419,280		419,300
1													
2													
3													
4													
5													
6													
7													
8													
9													
10													
11													

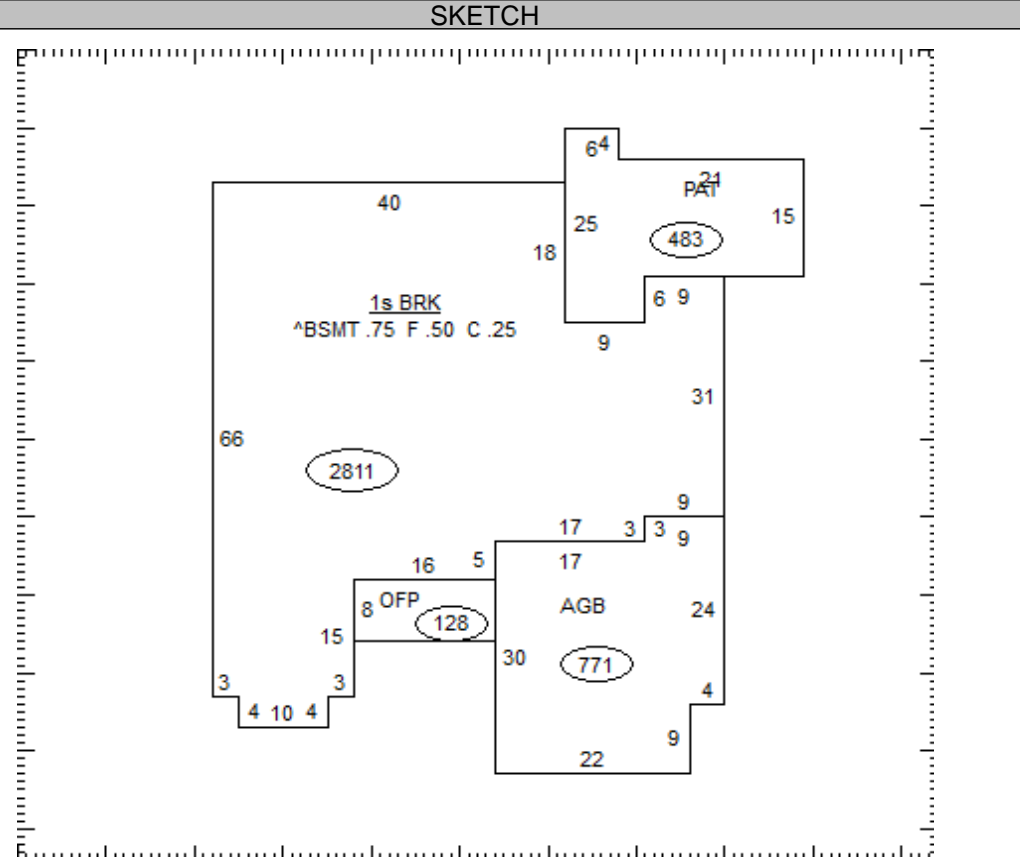

05-183200.0000

TOTAL 419,300

COMMENTS

Dwelling has an Economic Factor of 100%