

OCCUPANCY
 SF DU TR
 CONVERSION

BUILDING TYPE
 MOBILE HOME
 BI/TR LEVEL
 MOD/MAN

ROOFING
 METAL
 SLT/TLE
 SHINGLES
 SHAKES
 COMPOSITE

FLOORS
 CONCRETE
 WOOD
 TILE/COMPO
 CARPET

INT. FINISH
 PLASTER/DW
 PANELING
 UNFINISHED

ACCOMMODATIONS
 # OF ROOMS 6
 BEDROOMS 2
 FIREPLACES
 HEAT & AC

HEAT & AC
 NO HEAT
 CTRL HEAT
 HW/STEAM
 ELECTRIC
 HEAT PUMP
 FLR/WALL
 STVE/SPCE
 GEOTHERMAL
 OUTSIDE
 CTRL A/C

PLUMBING
 X FULL BATH
 X HALF BATH
 X FIXTURES

| FLOOR | AREA | CONST | VALUE |
|-------------------------|--------|-------|---------|
| 1 | 1040 | BRK | 176,540 |
| SUBTOTAL | | | 176,540 |
| MULTI-FAMILY # | 0 | | 0 |
| BUILDING TYPE | 100% | | 0 |
| BSMT FINISH | 0 S.F. | | 0 |
| FIREPLACE # | 0 | | 0 |
| HEATING | 0 S.F. | | 0 |
| AIR COND | 0 S.F. | | 0 |
| PLUMBING # | 0 | | 0 |
| GARAGES & CARPORTS | | | 7,900 |
| EXTRA FEATURES | | | 300 |
| SUBTOTAL | | | 184,740 |
| GRADE FACTOR | | | 100 % |
| UNADJUSTED VALUE | | | 184,740 |
| FACTOR | | | 100 % |

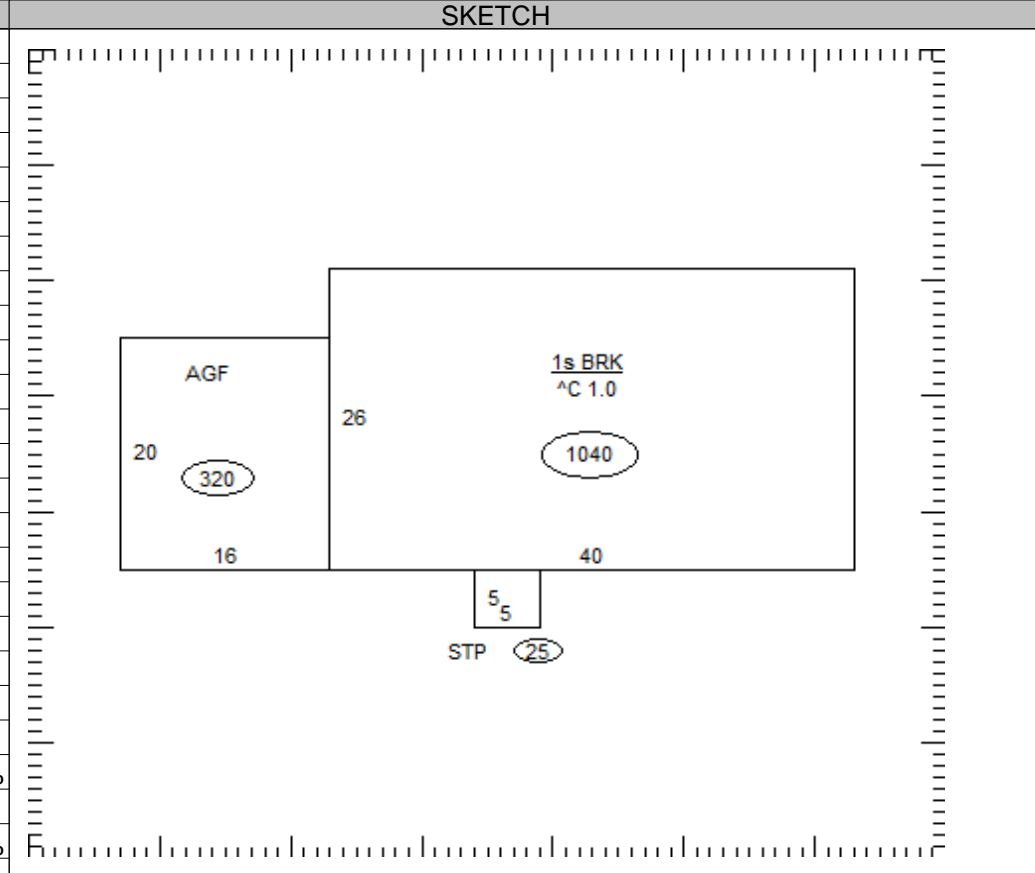

| OCCUPANCY | ST.HT | SIZE | AREA | GRADE | PRICE | AGE | REMD | CND | UNADJ VAL | PHYS | PHYS VAL | FUNC | TRUE VAL |
|-----------|-------|------|-------|-------|-------|------|------|-----|-----------|------|----------|------|----------|
| DWELLING | 1 | SK | 1,040 | C | | 1990 | | A | 184,740 | 26 | 136,710 | | 123,000 |
| 1 | | | | | | | | | | | | | |
| 2 | | | | | | | | | | | | | |
| 3 | | | | | | | | | | | | | |
| 4 | | | | | | | | | | | | | |
| 5 | | | | | | | | | | | | | |
| 6 | | | | | | | | | | | | | |
| 7 | | | | | | | | | | | | | |
| 8 | | | | | | | | | | | | | |
| 9 | | | | | | | | | | | | | |
| 10 | | | | | | | | | | | | | |
| 11 | | | | | | | | | | | | | |

05-174200.0000 TOTAL 123,000

COMMENTS

Dwelling has an Economic Factor of 90%

