



**OCCUPANCY**  
 SF  DU  TR  
 CONVERSION  
**BUILDING TYPE**  
 MOBILE HOME  
 BI/TR LEVEL  
 MOD/MAN  
 \_\_\_\_\_

**EXTERIOR**  
 WOOD  
 STUCCO  
 ALM/VYNL  
 CONC BLK  
 METAL  
 BRICK  
 STONE

FLOOR	AREA	CONST	VALUE
1	1040	FR	164,990

**ROOFING**  
 METAL  
 SLT/TLE  
 SHINGLES  
 SHAKES  
 COMPOSITE

**ROOF TYPE**  
 GABLE  
 HIP  
 GAMBREL  
 MANSARD  
 FLAT

SUBTOTAL			164,990
MULTI-FAMILY #	0		0
BUILDING TYPE	100%		0
BSMT FINISH	0 S.F.		0
FIREPLACE #	0		0
HEATING	0 S.F.		0
AIR COND	0 S.F.		0
PLUMBING #	0		0
GARAGES & CARPORTS			9,000
EXTRA FEATURES			800
SUBTOTAL			174,790
GRADE FACTOR			100 %
UNADJUSTED VALUE			174,790
FACTOR			100 %

**FLOORS** B 1 2 3 U  
 CONCRETE       
 WOOD       
 TILE/COMPO       
 CARPET

SUBTOTAL			164,990
MULTI-FAMILY #	0		0
BUILDING TYPE	100%		0
BSMT FINISH	0 S.F.		0
FIREPLACE #	0		0
HEATING	0 S.F.		0
AIR COND	0 S.F.		0
PLUMBING #	0		0
GARAGES & CARPORTS			9,000
EXTRA FEATURES			800
SUBTOTAL			174,790
GRADE FACTOR			100 %
UNADJUSTED VALUE			174,790
FACTOR			100 %

**INT. FINISH** B 1 2 3 U  
 PLASTER/DW       
 PANELING       
 UNFINISHED

**ACCOMMODATIONS**  
 # OF ROOMS  5      
 BEDROOMS  3      
 FIREPLACES       
 HEAT & AC B 1 2 3 U

SUBTOTAL			174,790
GRADE FACTOR			100 %
UNADJUSTED VALUE			174,790
FACTOR			100 %

NO HEAT       
 CTRL HEAT       
 HW/STEAM       
 ELECTRIC       
 HEAT PUMP       
 FLR/WALL       
 STVE/SPCE       
 GEOTHERMAL       
 OUTSIDE       
 CTRL A/C

OCCUPANCY	ST.HT	SIZE	AREA	GRADE	PRICE	AGE	REMD	CND	UNADJ VAL	PHYS	PHYS VAL	FUNC	TRUE VAL
DWELLING	1	SK	1,040	C		1978		A	174,790	30	122,350		128,500
1 Shed		8x8	64	C		1980		A		77			0
2													
3													
4													
5													
6													
7													
8													
9													
10													
11													

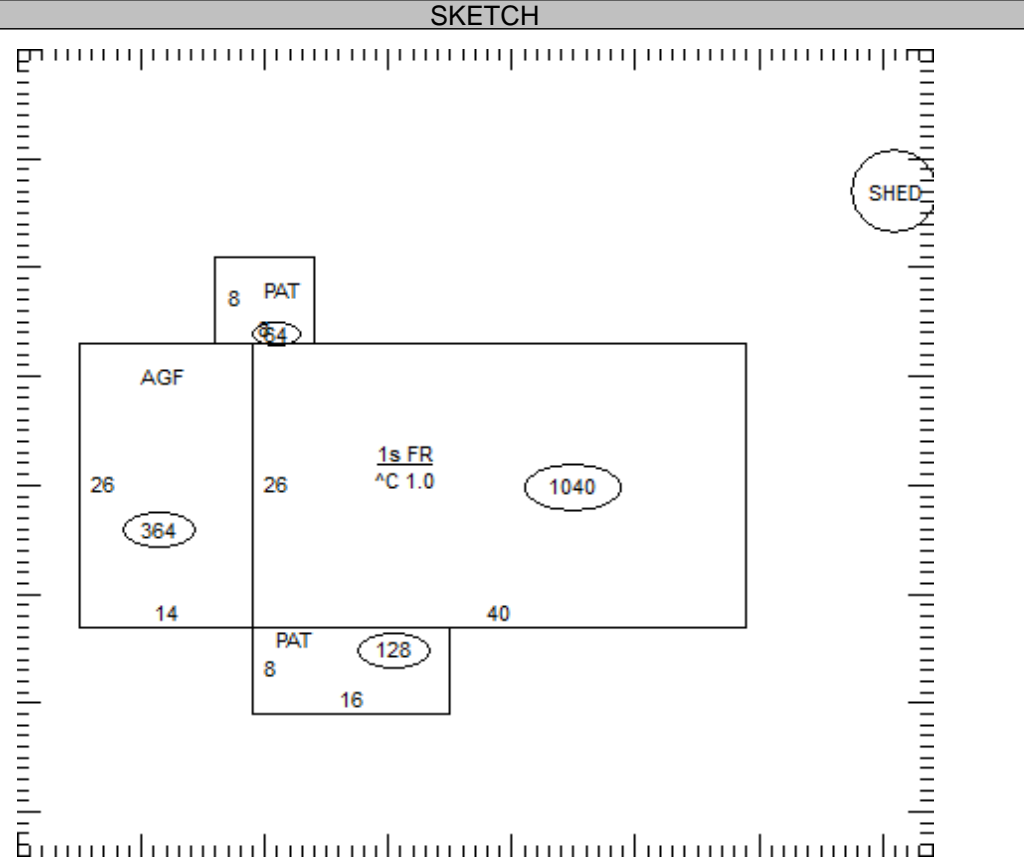

**PLUMBING** BASE   
 X FULL BATH       
 X HALF BATH       
 X FIXTURES

05-155300.0000

TOTAL 128,500

**COMMENTS**  
 MASONRY TRIM  
 Dwelling has an Economic Factor of 105%



