

OCCUPANCY
 SF DU TR
 CONVERSION

BUILDING TYPE
 MOBILE HOME
 BI/TR LEVEL
 MOD/MAN

ROOFING
 METAL
 SLT/TLE
 SHINGLES
 SHAKES
 COMPOSITE

FLOORS
 CONCRETE
 WOOD
 TILE/COMPO
 CARPET

INT. FINISH
 PLASTER/DW
 PANELING
 UNFINISHED

ACCOMMODATIONS
 # OF ROOMS
 BEDROOMS
 FIREPLACES
 HEAT & AC

PLUMBING
 X FULL BATH
 X HALF BATH
 X FIXTURES

FLOOR	AREA	CONST	VALUE
1	1224	FR	181,210
BSMT	960		13,730
SUBTOTAL			194,940
MULTI-FAMILY #	0		0
BUILDING TYPE	100%		0
BSMT FINISH	0 S.F.		0
FIREPLACE #	0		0
HEATING	0 S.F.		0
AIR COND	1,224 S.F.		2,020
PLUMBING #	2		2,420
GARAGES & CARPORTS			14,200
EXTRA FEATURES			700
SUBTOTAL			214,280
GRADE FACTOR			100 %
UNADJUSTED VALUE			214,280
FACTOR			100 %

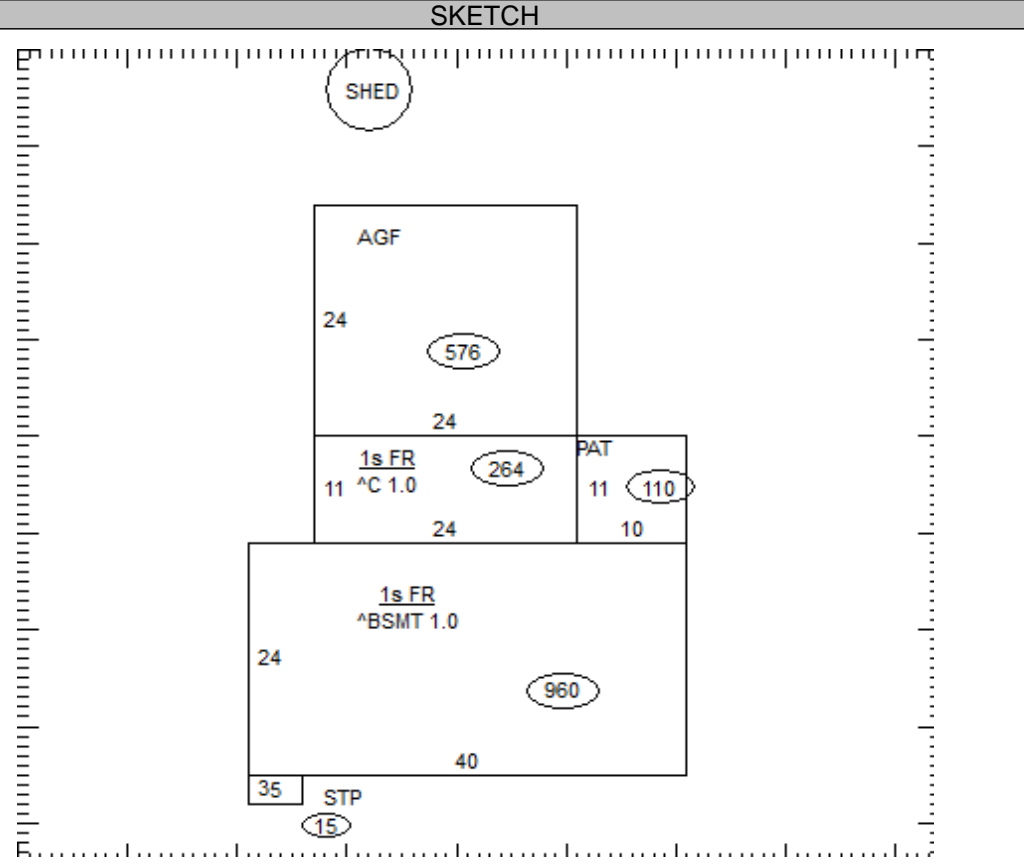

OCCUPANCY	ST.HT	SIZE	AREA	GRADE	PRICE	AGE	REMD	CND	UNADJ VAL	PHYS	PHYS VAL	FUNC	TRUE VAL
DWELLING	1	SK	1,224	C		1955		A	214,280	42	124,280		142,900
1 Shed	PP	10x12	120	C		2000		A		37			0
2													
3													
4													
5													
6													
7													
8													
9													
10													
11													

05-106000.0000

TOTAL 142,900

COMMENTS

Dwelling has an Economic Factor of 115%