

OCCUPANCY
 SF DU TR
 CONVERSION
BUILDING TYPE
 MOBILE HOME
 BI/TR LEVEL
 MOD/MAN

EXTERIOR
 WOOD
 STUCCO
 ALM/VYNL
 CONC BLK
 METAL
 BRICK
 STONE

ROOFING
 METAL
 SLT/TLE
 SHINGLES
 SHAKES
 COMPOSITE

ROOF TYPE
 GABLE
 HIP
 GAMBREL
 MANSARD
 FLAT

FLOORS B 1 2 3 U
 CONCRETE
 WOOD
 TILE/COMPO
 CARPET

INT. FINISH B 1 2 3 U
 PLASTER/DW
 PANELING
 UNFINISHED

ACCOMMODATIONS
 # OF ROOMS 7
 BEDROOMS 3
 FIREPLACES 1

HEAT & AC B 1 2 3 U
 NO HEAT
 CTRL HEAT
 HW/STEAM
 ELECTRIC
 HEAT PUMP
 FLR/WALL
 STVE/SPCE
 GEOTHERMAL
 OUTSIDE
 CTRL A/C

PLUMBING BASE
 X FULL BATH 1
 X HALF BATH 1
 X FIXTURES

FLOOR	AREA	CONST	VALUE
1	2444	BRK	286,560
BSMT	2444		34,950
SUBTOTAL			321,510
MULTI-FAMILY #	0		0
BUILDING TYPE	100%		0
BSMT FINISH	0 S.F.		0
FIREPLACE #	1		4,400
HEATING	0 S.F.		0
AIR COND	2,444 S.F.		4,030
PLUMBING #	5		6,050
GARAGES & CARPORTS			27,900
EXTRA FEATURES			15,300
SUBTOTAL			379,190
GRADE FACTOR			115 %
UNADJUSTED VALUE			436,070
FACTOR			100 %

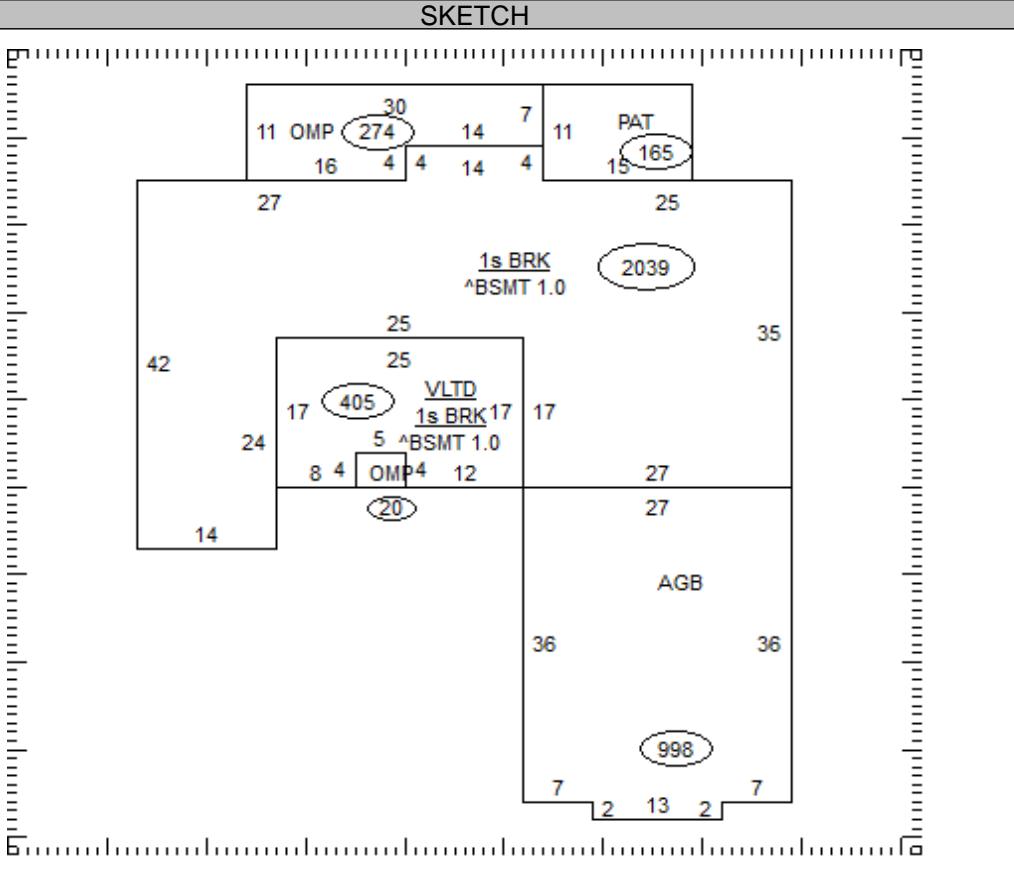

OCCUPANCY	ST.HT	SIZE	AREA	GRADE	PRICE	AGE	REMD	CND	UNADJ VAL	PHYS	PHYS VAL	FUNC	TRUE VAL
DWELLING	1	SK	2,444	B-		2022		G	436,070	1	431,710		474,900
1													
2													
3													
4													
5													
6													
7													
8													
9													
10													
11													

05-009750.1733

TOTAL 474,900

COMMENTS
 Dwelling has an Economic Factor of 110%