

BUTLER TWP / CELINA SD

08-18-300-001

Property Class: 510

Neighborhood

009025-R150

Map: 06

Block:

Card: 08

Bk: Pg:

02-005500.0000

LEGAL INFORMATION

PT NW NW SW FR

RTS: 002-06-18
Acres:0.9100

BRADY CLAY M
BRADY CLAY M
5730 TOWNSHIP LINE RD
COLDWATER, OH 45828

| | OWNERSHIP | ADDRESS | CITY | STATE | ZIP | DATE | AMOUNT | DEED:CONV# | JS | VALID |
|---|----------------------|-----------------------|-----------|-------|-------|------------|---------|---------------|--------------------------|-------------------------------------|
| 1 | BRADY CLAY M | 5730 TOWNSHIP LINE RD | COLDWATER | OH | 45828 | 06/22/2018 | 109,000 | WDC : 444 | <input type="checkbox"/> | <input checked="" type="checkbox"/> |
| 2 | HASENJAGER COREY M | 5730 TOWNSHIP LINE RD | COLDWATER | OH | 45828 | 01/07/2008 | 0 | QCE : X : 0 | <input type="checkbox"/> | <input type="checkbox"/> |
| 3 | HASENJAGER COREY M & | 5730 TOWNSHIP LINE RD | COLDWATER | OH | 45828 | 08/11/2006 | 87,500 | WDC : A : 651 | <input type="checkbox"/> | <input type="checkbox"/> |

X: TTO LISTER: JO DATE: 03/29/2005 TIME: 02:03:50 PM LETTER LETTER REC'D GIS CODE

| STREET/ROAD | TOPOGRAPHY | PU-UTILITIES-PR | NEIGHBORHOOD | INFLUENCE FACTORS | PROPERTY LOCATION |
|---|---|--|--|--|----------------------------------|
| <input checked="" type="checkbox"/> PAVED | <input checked="" type="checkbox"/> LEVEL | <input type="checkbox"/> WATER <input type="checkbox"/> | <input type="checkbox"/> IMPROVING | <input type="checkbox"/> A. NO ROAD <input type="checkbox"/> F. RESTRICT | 5730 TOWNSHIP LINE RD, COLDWATER |
| <input type="checkbox"/> GRAVEL | <input type="checkbox"/> HIGH | <input type="checkbox"/> SEWER <input type="checkbox"/> | <input checked="" type="checkbox"/> STATIC | <input type="checkbox"/> B. TOPGRHY <input type="checkbox"/> G. WOOD LT | COMMENT |
| <input type="checkbox"/> DIRT | <input type="checkbox"/> LOW | <input type="checkbox"/> GAS <input type="checkbox"/> | <input type="checkbox"/> DECLINING | <input type="checkbox"/> C. Ex Front <input type="checkbox"/> H. VACANCY | TY2022:Net Gen=\$1,407.86, Other |
| <input type="checkbox"/> SIDEWALKS | <input type="checkbox"/> ROLLING | <input type="checkbox"/> ELECTRIC <input type="checkbox"/> | <input type="checkbox"/> OLD | <input type="checkbox"/> D. QUANTITY <input type="checkbox"/> I. WATER FRONT | Assessment=\$4.64 |
| <input type="checkbox"/> CURBS | <input type="checkbox"/> STANDARD | <input checked="" type="checkbox"/> STANDARD | <input type="checkbox"/> STANDARD | <input type="checkbox"/> E. SZ/SHAPE <input type="checkbox"/> J. OTHER/CDU | DE17 DESKTOP RVW CHG: ADD WDDK |

LAND COMPUTATIONS

| LAND TYPE | SIZE | M | RATE | C | INF | M | VALUE | C |
|------------------------------|---------|-------|------|---|-----|--------|--------|---|
| HS:Home Site <1 @ 26580*0.99 | AC:0.91 | 26310 | | | | 26,300 | 0 | |
| Total Acres: .9100 | | | | | | TOTAL | 26,300 | 0 |

VALUATION SUMMARY

| VALUE YEAR | 2023 | 2020 | 2017 | 2017 | | | | |
|-------------------|-------------------------|--------|--------|--------|--|--|--|--|
| REASON FOR CHANGE | RAPP | RAPP | RAPP | MISC | | | | |
| APPRAISED VALUE | <u>LAND</u> 26,300 | 19,400 | 16,300 | 14,900 | | | | |
| | <u>IMPR</u> 90,600 | 65,900 | 55,200 | 46,700 | | | | |
| | <u>TOTAL</u> 116,900 | 85,300 | 71,500 | 61,600 | | | | |
| ASSESSED VALUE | <u>LAND</u> 9,210 | 6,790 | 5,710 | 5,220 | | | | |
| | <u>IMPR</u> 31,710 | 23,070 | 19,320 | 16,350 | | | | |
| | <u>TOTAL</u> 40,920 | 29,860 | 25,030 | 21,570 | | | | |

| | | | | | |
|--|--|--------------|-------------|--------------|--------------|
| OCCUPANCY | EXTERIOR | FLOOR | AREA | CONST | VALUE |
| <input checked="" type="checkbox"/> SF <input type="checkbox"/> DU <input type="checkbox"/> TR | <input type="checkbox"/> WOOD | 1 | 1278 | FR | 185,920 |
| <input type="checkbox"/> CONVERSION | <input type="checkbox"/> STUCCO | .5 | 271 | FR | 24,440 |
| BUILDING TYPE | <input checked="" type="checkbox"/> ALM/VYNL | | | | |
| <input type="checkbox"/> MOBILE HOME | <input type="checkbox"/> CONC BLK | | | | |
| <input type="checkbox"/> BI/TR LEVEL | <input type="checkbox"/> METAL | | | | |
| <input type="checkbox"/> MOD/MAN | <input type="checkbox"/> BRICK | | | | |
| <input type="checkbox"/> | <input type="checkbox"/> STONE | | | | |

| | |
|--|---|
| ROOFING | ROOF TYPE |
| <input type="checkbox"/> METAL | <input checked="" type="checkbox"/> GABLE |
| <input type="checkbox"/> SLT/TLE | <input type="checkbox"/> HIP |
| <input checked="" type="checkbox"/> SHINGLES | <input type="checkbox"/> GAMBREL |
| <input type="checkbox"/> SHAKES | <input type="checkbox"/> MANSARD |
| <input type="checkbox"/> COMPOSITE | <input type="checkbox"/> FLAT |

| | | | | | |
|-----------------------|--------------------------|-------------------------------------|-------------------------------------|--------------------------|--------------------------|
| FLOORS | B | 1 | 2 | 3 | U |
| CONCRETE | <input type="checkbox"/> | <input type="checkbox"/> | <input type="checkbox"/> | <input type="checkbox"/> | <input type="checkbox"/> |
| WOOD | <input type="checkbox"/> | <input checked="" type="checkbox"/> | <input checked="" type="checkbox"/> | <input type="checkbox"/> | <input type="checkbox"/> |
| TILE/COMPO | <input type="checkbox"/> | <input type="checkbox"/> | <input type="checkbox"/> | <input type="checkbox"/> | <input type="checkbox"/> |
| CARPET | <input type="checkbox"/> | <input type="checkbox"/> | <input type="checkbox"/> | <input type="checkbox"/> | <input type="checkbox"/> |
| INT. FINISH | B | 1 | 2 | 3 | U |
| PLASTER/DW | <input type="checkbox"/> | <input checked="" type="checkbox"/> | <input checked="" type="checkbox"/> | <input type="checkbox"/> | <input type="checkbox"/> |
| PANELING | <input type="checkbox"/> | <input type="checkbox"/> | <input type="checkbox"/> | <input type="checkbox"/> | <input type="checkbox"/> |
| UNFINISHED | <input type="checkbox"/> | <input type="checkbox"/> | <input type="checkbox"/> | <input type="checkbox"/> | <input type="checkbox"/> |
| ACCOMMODATIONS | | | | | |
| # OF ROOMS | | 4 | 3 | | |
| BEDROOMS | | 1 | 3 | | |
| FIREPLACES | | | | | |
| HEAT & AC | B | 1 | 2 | 3 | U |
| NO HEAT | <input type="checkbox"/> | <input type="checkbox"/> | <input type="checkbox"/> | <input type="checkbox"/> | <input type="checkbox"/> |
| CTRL HEAT | <input type="checkbox"/> | <input checked="" type="checkbox"/> | <input checked="" type="checkbox"/> | <input type="checkbox"/> | <input type="checkbox"/> |
| HW/STEAM | <input type="checkbox"/> | <input checked="" type="checkbox"/> | <input checked="" type="checkbox"/> | <input type="checkbox"/> | <input type="checkbox"/> |
| ELECTRIC | <input type="checkbox"/> | <input checked="" type="checkbox"/> | <input checked="" type="checkbox"/> | <input type="checkbox"/> | <input type="checkbox"/> |
| HEAT PUMP | <input type="checkbox"/> | <input type="checkbox"/> | <input type="checkbox"/> | <input type="checkbox"/> | <input type="checkbox"/> |
| FLR/WALL | <input type="checkbox"/> | <input type="checkbox"/> | <input type="checkbox"/> | <input type="checkbox"/> | <input type="checkbox"/> |
| STVE/SPCE | <input type="checkbox"/> | <input type="checkbox"/> | <input type="checkbox"/> | <input type="checkbox"/> | <input type="checkbox"/> |
| GEOHERMAL | <input type="checkbox"/> | <input type="checkbox"/> | <input type="checkbox"/> | <input type="checkbox"/> | <input type="checkbox"/> |
| OUTSIDE | <input type="checkbox"/> | <input type="checkbox"/> | <input type="checkbox"/> | <input type="checkbox"/> | <input type="checkbox"/> |
| CTRL A/C | <input type="checkbox"/> | <input type="checkbox"/> | <input type="checkbox"/> | <input type="checkbox"/> | <input type="checkbox"/> |
| PLUMBING | BASE | <input checked="" type="checkbox"/> | | | |
| X FULL BATH | | | | | |
| X HALF BATH | | | | | |
| X FIXTURES | | | | | |

| | | |
|-------------------------|--------|---------|
| SUBTOTAL | | 210,360 |
| MULTI-FAMILY # | 0 | 0 |
| BUILDING TYPE | 100% | 0 |
| BSMT FINISH | 0 S.F. | 0 |
| FIREPLACE # | 0 | 0 |
| HEATING | 0 S.F. | 0 |
| AIR COND | 0 S.F. | 0 |
| PLUMBING # | 0 | 0 |
| GARAGES & CARPORTS | | 0 |
| EXTRA FEATURES | | 5,400 |
| SUBTOTAL | | 215,760 |
| GRADE FACTOR | | 80 % |
| UNADJUSTED VALUE | | 172,610 |
| FACTOR | | 100 % |

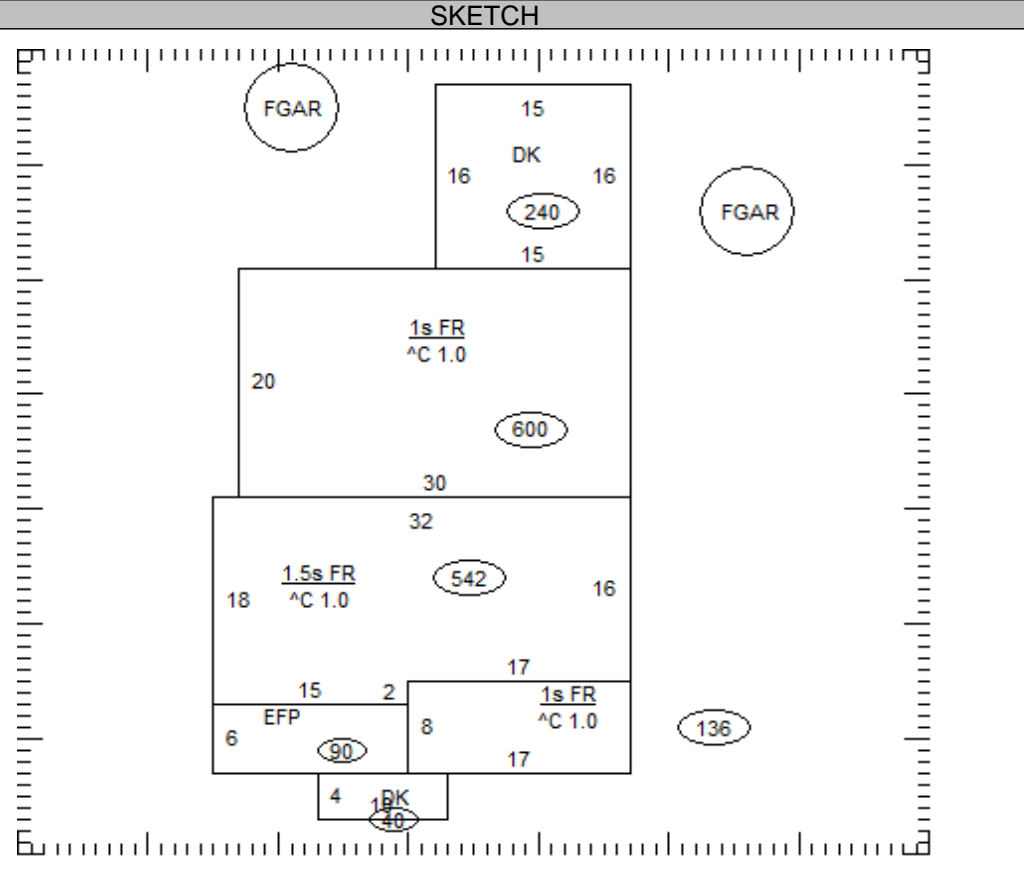

| OCCUPANCY | ST.HT | SIZE | AREA | GRADE | PRICE | AGE | REMD | CND | UNADJ VAL | PHYS | PHYS VAL | FUNC | TRUE VAL |
|---------------|-------|-------|-------|-------|-------|------|------|-----|-----------|------|----------|------|----------|
| DWELLING | 1.5 | SK | 1,549 | D | | 1940 | | A | 172,610 | 50 | 86,310 | | 86,300 |
| 1 Gar - Frame | 8 | 18x32 | 576 | D | 18.96 | 1970 | | A | 10,920 | 85 | 1,640 | | 1,600 |
| 2 Gar - Frame | 8 | 24x32 | 768 | C | 23.70 | 1970 | | A | 18,200 | 85 | 2,730 | | 2,700 |
| 3 | | | | | | | | | | | | | |
| 4 | | | | | | | | | | | | | |
| 5 | | | | | | | | | | | | | |
| 6 | | | | | | | | | | | | | |
| 7 | | | | | | | | | | | | | |
| 8 | | | | | | | | | | | | | |
| 9 | | | | | | | | | | | | | |
| 10 | | | | | | | | | | | | | |
| 11 | | | | | | | | | | | | | |

02-005500.0000 TOTAL 90,600

COMMENTS

de06 corr gar
 Dwelling has an Economic Factor of 100%

BUTLER TWP / CELINA SD

08-18-300-001

Property Class: 510

Neighborhood

009025-R150

Map: 06

Block:

Card: 08

Bk: Pg:

02-005500.0000

LEGAL INFORMATION

PT NW NW SW FR

RTS: 002-06-18

Acres:0.9100

BRADY CLAY M
BRADY CLAY M
5730 TOWNSHIP LINE RD
COLDWATER, OH 45828

| | OWNERSHIP | ADDRESS | CITY | STATE | ZIP | DATE | AMOUNT | DEED:CONV# | JS | VALID |
|---|----------------------------|-----------------------|-----------|-------|-------|------------|--------|-------------|--------------------------|-------------------------------------|
| 1 | ELLIS MICHELLE L | 7530 TOWNSHIP LINE RD | COLDWATER | OH | 45828 | 05/12/2005 | 0 | QCE : X : 0 | <input type="checkbox"/> | <input type="checkbox"/> |
| 2 | ELLIS ROGER E & MICHELLE L | 5730 TOWNSHIP LINE RD | COLDWATER | OH | 45828 | 08/27/2001 | 74,200 | : A : 0 | <input type="checkbox"/> | <input checked="" type="checkbox"/> |
| 3 | | | | | | | 0 | 0 | <input type="checkbox"/> | <input type="checkbox"/> |

X: TTO LISTER: JO DATE: 03/29/2005 TIME: 02:03:50 PM LETTER LETTER REC'D GIS CODE

| STREET/ROAD | TOPOGRAPHY | PU-UTILITIES-PR | NEIGHBORHOOD | INFLUENCE FACTORS | PROPERTY LOCATION |
|---|---|--|--|--|---|
| <input checked="" type="checkbox"/> PAVED | <input checked="" type="checkbox"/> LEVEL | <input type="checkbox"/> WATER <input type="checkbox"/> | <input type="checkbox"/> IMPROVING | <input type="checkbox"/> A. NO ROAD <input type="checkbox"/> F. RESTRICT | 5730 TOWNSHIP LINE RD, COLDWATER COMMENT |
| <input type="checkbox"/> GRAVEL | <input type="checkbox"/> HIGH | <input type="checkbox"/> SEWER <input type="checkbox"/> | <input checked="" type="checkbox"/> STATIC | <input type="checkbox"/> B. TOPGRHY <input type="checkbox"/> G. WOOD LT | |
| <input type="checkbox"/> DIRT | <input type="checkbox"/> LOW | <input type="checkbox"/> GAS <input type="checkbox"/> | <input type="checkbox"/> DECLINING | <input type="checkbox"/> C. Ex Front <input type="checkbox"/> H. VACANCY | |
| <input type="checkbox"/> SIDEWALKS | <input type="checkbox"/> ROLLING | <input type="checkbox"/> ELECTRIC <input type="checkbox"/> | <input type="checkbox"/> OLD | <input type="checkbox"/> D. QUANTITY <input type="checkbox"/> I. WATER FRONT | |
| <input type="checkbox"/> CURBS | <input type="checkbox"/> STANDARD | <input checked="" type="checkbox"/> STANDARD | <input type="checkbox"/> STANDARD | <input type="checkbox"/> E. SZ/SHAPE <input type="checkbox"/> J. OTHER/CDU | |
| | | | | | |

LAND COMPUTATIONS

| LAND TYPE | SIZE | M | RATE | C | INF | M | VALUE | C |
|--------------------|------|---|------|---|-------|---|--------|---|
| | | | | | | | | |
| | | | | | | | | |
| | | | | | | | | |
| | | | | | | | | |
| | | | | | | | | |
| | | | | | | | | |
| | | | | | | | | |
| | | | | | | | | |
| Total Acres: .9100 | | | | | TOTAL | | 26,300 | 0 |

VALUATION SUMMARY

| VALUE YEAR | REASON FOR CHANGE | APPRaised | IMPR | TOTAL | ASSESSED | IMPR | TOTAL |
|------------|-------------------|-----------|------|-------|----------|------|-------|
| | | | | | | | |
| | | | | | | | |
| | | | | | | | |
| | | | | | | | |

| OCCUPANCY | EXTERIOR | FLOOR | AREA | CONST | VALUE |
|---|-----------------------------------|-------|------|-------|-------|
| <input type="checkbox"/> SF <input type="checkbox"/> DU <input type="checkbox"/> TR | <input type="checkbox"/> WOOD | | | | |
| <input type="checkbox"/> CONVERSION | <input type="checkbox"/> STUCCO | | | | |
| BUILDING TYPE | <input type="checkbox"/> ALM/VYNL | | | | |
| <input type="checkbox"/> MOBILE HOME | <input type="checkbox"/> CONC BLK | | | | |
| <input type="checkbox"/> BI/TR LEVEL | <input type="checkbox"/> METAL | | | | |
| <input type="checkbox"/> MOD/MAN | <input type="checkbox"/> BRICK | | | | |
| <input type="checkbox"/> | <input type="checkbox"/> STONE | | | | |

| ROOFING | ROOF TYPE |
|------------------------------------|----------------------------------|
| <input type="checkbox"/> METAL | <input type="checkbox"/> GABLE |
| <input type="checkbox"/> SLT/TLE | <input type="checkbox"/> HIP |
| <input type="checkbox"/> SHINGLES | <input type="checkbox"/> GAMBREL |
| <input type="checkbox"/> SHAKES | <input type="checkbox"/> MANSARD |
| <input type="checkbox"/> COMPOSITE | <input type="checkbox"/> FLAT |

| FLOORS | B | 1 | 2 | 3 | U |
|----------------|--------------------------|--------------------------|--------------------------|--------------------------|-------------------------------|
| CONCRETE | <input type="checkbox"/> | <input type="checkbox"/> | <input type="checkbox"/> | <input type="checkbox"/> | <input type="checkbox"/> |
| WOOD | <input type="checkbox"/> | <input type="checkbox"/> | <input type="checkbox"/> | <input type="checkbox"/> | <input type="checkbox"/> |
| TILE/COMPO | <input type="checkbox"/> | <input type="checkbox"/> | <input type="checkbox"/> | <input type="checkbox"/> | <input type="checkbox"/> |
| CARPET | <input type="checkbox"/> | <input type="checkbox"/> | <input type="checkbox"/> | <input type="checkbox"/> | <input type="checkbox"/> |
| INT. FINISH | B | 1 | 2 | 3 | U |
| PLASTER/DW | <input type="checkbox"/> | <input type="checkbox"/> | <input type="checkbox"/> | <input type="checkbox"/> | <input type="checkbox"/> |
| PANELING | <input type="checkbox"/> | <input type="checkbox"/> | <input type="checkbox"/> | <input type="checkbox"/> | <input type="checkbox"/> |
| UNFINISHED | <input type="checkbox"/> | <input type="checkbox"/> | <input type="checkbox"/> | <input type="checkbox"/> | <input type="checkbox"/> |
| ACCOMMODATIONS | | | | | |
| # OF ROOMS | | | | | |
| BEDROOMS | | | | | |
| FIREPLACES | | | | | |
| HEAT & AC | B | 1 | 2 | 3 | U |
| NO HEAT | <input type="checkbox"/> | <input type="checkbox"/> | <input type="checkbox"/> | <input type="checkbox"/> | <input type="checkbox"/> |
| CTRL HEAT | <input type="checkbox"/> | <input type="checkbox"/> | <input type="checkbox"/> | <input type="checkbox"/> | <input type="checkbox"/> |
| HW/STEAM | <input type="checkbox"/> | <input type="checkbox"/> | <input type="checkbox"/> | <input type="checkbox"/> | <input type="checkbox"/> |
| ELECTRIC | <input type="checkbox"/> | <input type="checkbox"/> | <input type="checkbox"/> | <input type="checkbox"/> | <input type="checkbox"/> |
| HEAT PUMP | <input type="checkbox"/> | <input type="checkbox"/> | <input type="checkbox"/> | <input type="checkbox"/> | <input type="checkbox"/> |
| FLR/WALL | <input type="checkbox"/> | <input type="checkbox"/> | <input type="checkbox"/> | <input type="checkbox"/> | <input type="checkbox"/> |
| STVE/SPCE | <input type="checkbox"/> | <input type="checkbox"/> | <input type="checkbox"/> | <input type="checkbox"/> | <input type="checkbox"/> |
| GEO THERMAL | <input type="checkbox"/> | <input type="checkbox"/> | <input type="checkbox"/> | <input type="checkbox"/> | <input type="checkbox"/> |
| OUTSIDE | <input type="checkbox"/> | <input type="checkbox"/> | <input type="checkbox"/> | <input type="checkbox"/> | <input type="checkbox"/> |
| CTRL A/C | <input type="checkbox"/> | <input type="checkbox"/> | <input type="checkbox"/> | <input type="checkbox"/> | <input type="checkbox"/> |
| PLUMBING | | | | | BASE <input type="checkbox"/> |
| X FULL BATH | | | | | |
| X HALF BATH | | | | | |
| X FIXTURES | | | | | |

| | | |
|-------------------------|--------|---|
| SUBTOTAL | | 0 |
| MULTI-FAMILY # | 0 | 0 |
| BUILDING TYPE | 000% | 0 |
| BSMT FINISH | 0 S.F. | 0 |
| FIREPLACE # | 0 | 0 |
| HEATING | 0 S.F. | 0 |
| AIR COND | 0 S.F. | 0 |
| PLUMBING # | 0 | 0 |
| GARAGES & CARPORTS | | 0 |
| EXTRA FEATURES | | 0 |
| SUBTOTAL | | 0 |
| GRADE FACTOR | | % |
| UNADJUSTED VALUE | | 0 |
| FACTOR | | % |

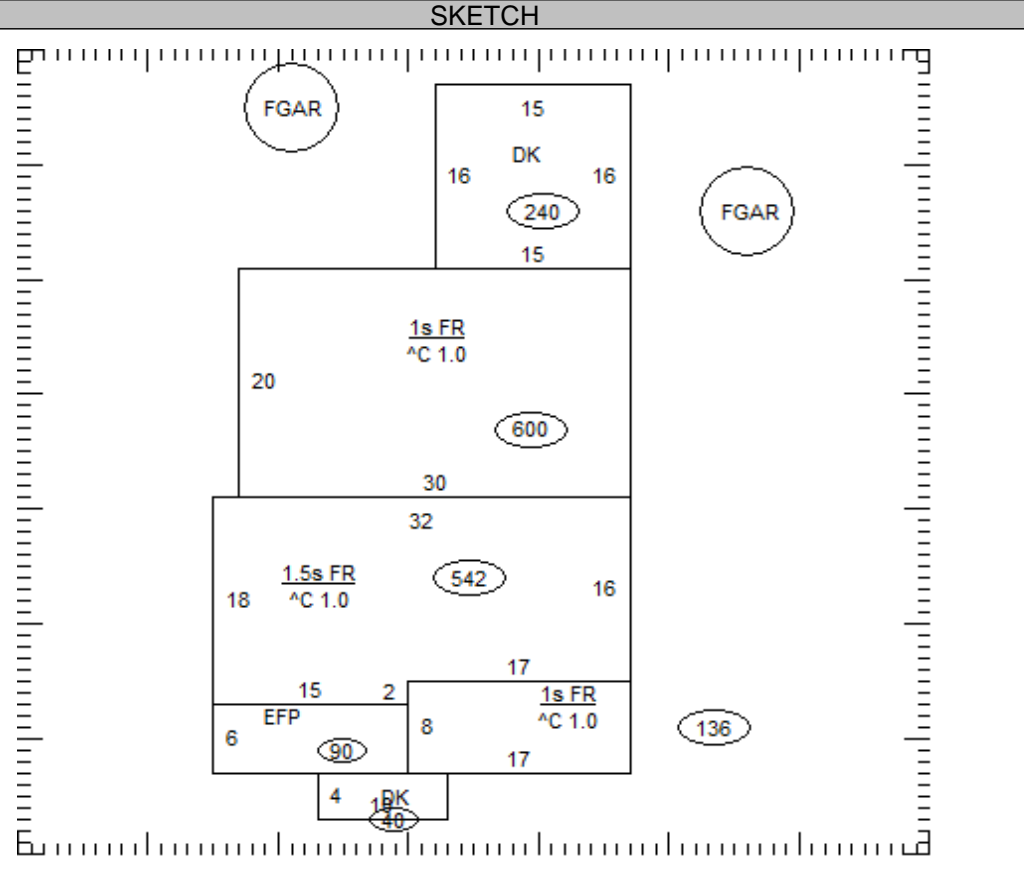

| OCCUPANCY | ST.HT | SIZE | AREA | GRADE | PRICE | AGE | REMD | CND | UNADJ VAL | PHYS | PHYS VAL | FUNC | TRUE VAL |
|-----------|-------|------|------|-------|-------|-----|------|-----|-----------|------|----------|------|----------|
| DWELLING | | SK | | | | | | | | | | | |
| 1 | | | | | | | | | | | | | |
| 2 | | | | | | | | | | | | | |
| 3 | | | | | | | | | | | | | |
| 4 | | | | | | | | | | | | | |
| 5 | | | | | | | | | | | | | |
| 6 | | | | | | | | | | | | | |
| 7 | | | | | | | | | | | | | |
| 8 | | | | | | | | | | | | | |
| 9 | | | | | | | | | | | | | |
| 10 | | | | | | | | | | | | | |
| 11 | | | | | | | | | | | | | |

02-005500.0000

TOTAL 0

COMMENTS