

OCCUPANCY		EXTERIOR		FLOOR	AREA	CONST	VALUE
<input checked="" type="checkbox"/> SF <input type="checkbox"/> DU <input type="checkbox"/> TR	<input type="checkbox"/> WOOD	1	2066	FR			238,950
<input type="checkbox"/> CONVERSION	<input type="checkbox"/> STUCCO						
BUILDING TYPE							
<input type="checkbox"/> MOBILE HOME	<input checked="" type="checkbox"/> ALM/VYNL						
<input type="checkbox"/> BI/TR LEVEL	<input type="checkbox"/> CONC BLK						
<input type="checkbox"/> MOD/MAN	<input type="checkbox"/> METAL						
<input type="checkbox"/>	<input type="checkbox"/> BRICK						
	<input type="checkbox"/> STONE						
ROOFING		ROOF TYPE					
<input type="checkbox"/> METAL	<input type="checkbox"/> GABLE						
<input type="checkbox"/> SLT/TLE	<input checked="" type="checkbox"/> HIP						
<input checked="" type="checkbox"/> SHINGLES	<input type="checkbox"/> GAMBREL						
<input type="checkbox"/> SHAKES	<input type="checkbox"/> MANSARD						
<input type="checkbox"/> COMPOSITE	<input type="checkbox"/> FLAT						
FLOORS		B	1	2	3	U	
CONCRETE	<input type="checkbox"/>	<input type="checkbox"/>	<input type="checkbox"/>	<input type="checkbox"/>	<input type="checkbox"/>	<input type="checkbox"/>	
WOOD	<input type="checkbox"/>	<input checked="" type="checkbox"/>	<input type="checkbox"/>	<input type="checkbox"/>	<input type="checkbox"/>	<input type="checkbox"/>	
TILE/COMPO	<input type="checkbox"/>	<input checked="" type="checkbox"/>	<input type="checkbox"/>	<input type="checkbox"/>	<input type="checkbox"/>	<input type="checkbox"/>	
CARPET	<input type="checkbox"/>	<input type="checkbox"/>	<input type="checkbox"/>	<input type="checkbox"/>	<input type="checkbox"/>	<input type="checkbox"/>	
INT. FINISH		B	1	2	3	U	
PLASTER/DW	<input type="checkbox"/>	<input checked="" type="checkbox"/>	<input type="checkbox"/>	<input type="checkbox"/>	<input type="checkbox"/>	<input type="checkbox"/>	
PANELING	<input type="checkbox"/>	<input type="checkbox"/>	<input type="checkbox"/>	<input type="checkbox"/>	<input type="checkbox"/>	<input type="checkbox"/>	
UNFINISHED	<input checked="" type="checkbox"/>	<input type="checkbox"/>	<input type="checkbox"/>	<input type="checkbox"/>	<input type="checkbox"/>	<input type="checkbox"/>	
ACCOMMODATIONS							
# OF ROOMS		6					
BEDROOMS		2					
FIREPLACES							
HEAT & AC		B	1	2	3	U	
NO HEAT	<input type="checkbox"/>	<input type="checkbox"/>	<input type="checkbox"/>	<input type="checkbox"/>	<input type="checkbox"/>	<input type="checkbox"/>	
CTRL HEAT	<input type="checkbox"/>	<input checked="" type="checkbox"/>	<input type="checkbox"/>	<input type="checkbox"/>	<input type="checkbox"/>	<input type="checkbox"/>	
HW/STEAM	<input type="checkbox"/>	<input type="checkbox"/>	<input type="checkbox"/>	<input type="checkbox"/>	<input type="checkbox"/>	<input type="checkbox"/>	
ELECTRIC	<input type="checkbox"/>	<input type="checkbox"/>	<input type="checkbox"/>	<input type="checkbox"/>	<input type="checkbox"/>	<input type="checkbox"/>	
HEAT PUMP	<input type="checkbox"/>	<input type="checkbox"/>	<input type="checkbox"/>	<input type="checkbox"/>	<input type="checkbox"/>	<input type="checkbox"/>	
FLR/WALL	<input type="checkbox"/>	<input type="checkbox"/>	<input type="checkbox"/>	<input type="checkbox"/>	<input type="checkbox"/>	<input type="checkbox"/>	
STVE/SPCE	<input type="checkbox"/>	<input type="checkbox"/>	<input type="checkbox"/>	<input type="checkbox"/>	<input type="checkbox"/>	<input type="checkbox"/>	
GEOHERMAL	<input type="checkbox"/>	<input type="checkbox"/>	<input type="checkbox"/>	<input type="checkbox"/>	<input type="checkbox"/>	<input type="checkbox"/>	
OUTSIDE	<input type="checkbox"/>	<input type="checkbox"/>	<input type="checkbox"/>	<input type="checkbox"/>	<input type="checkbox"/>	<input type="checkbox"/>	
CTRL A/C	<input type="checkbox"/>	<input checked="" type="checkbox"/>	<input type="checkbox"/>	<input type="checkbox"/>	<input type="checkbox"/>	<input type="checkbox"/>	
PLUMBING		BASE		<input checked="" type="checkbox"/>			
X FULL BATH		1					
X HALF BATH							
X FIXTURES							
BSMT			780				11,150
SUBTOTAL							250,100
MULTI-FAMILY #			0				0
BUILDING TYPE			100%				0
BSMT FINISH			0 S.F.				0
FIREPLACE #			0				0
HEATING			0 S.F.				0
AIR COND			2,066 S.F.				3,410
PLUMBING #			3				3,630
GARAGES & CARPORTS							16,600
EXTRA FEATURES							4,200
SUBTOTAL							277,940
GRADE FACTOR							100 %
UNADJUSTED VALUE							277,940
FACTOR							100 %

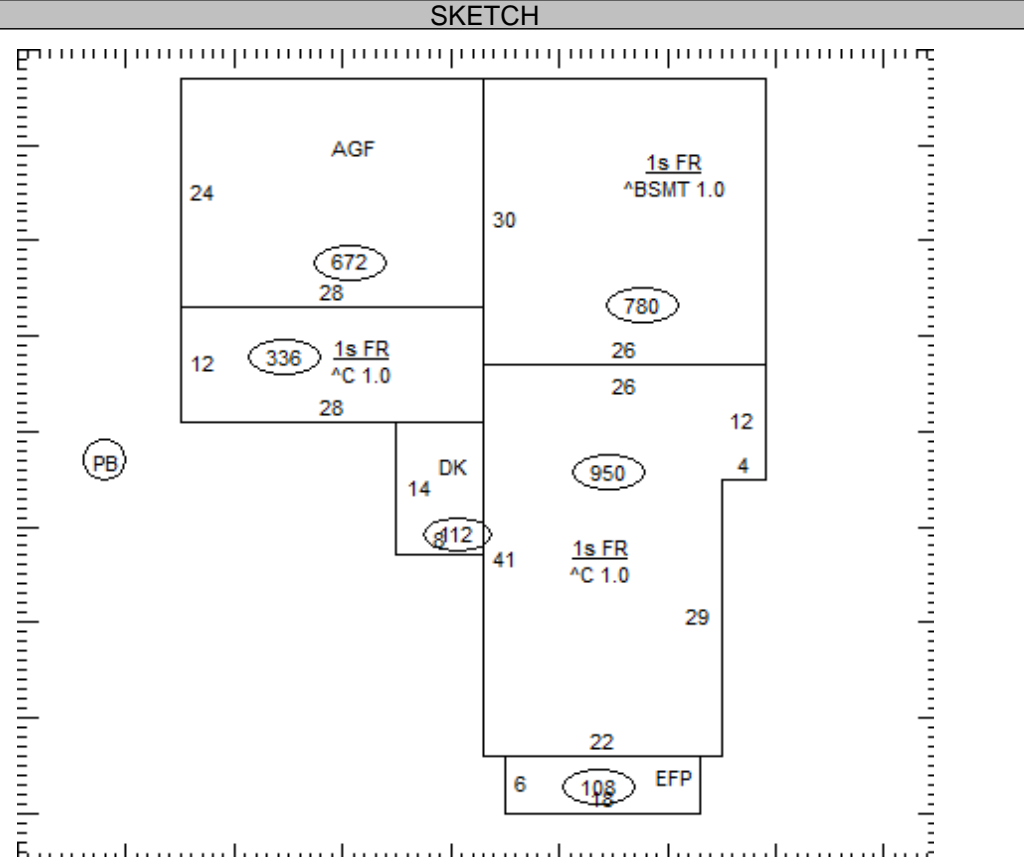

OCCUPANCY	ST.HT	SIZE	AREA	GRADE	PRICE	AGE	REMD	CND	UNADJ VAL	PHYS	PHYS VAL	FUNC	TRUE VAL
DWELLING	1	SK	2,066	C		1900	2019	A	277,940	24	211,230		190,100
1 Pole Bldg	10	40x80	3,200	C	14.39	2022		A	46,050	2	45,130		45,100
2													
3													
4													
5													
6													
7													
8													
9													
10													
11													

01-036900.0100

TOTAL 235,200

COMMENTS

>>OB Features: 1.1 <Add Concrete Floor>
 Dwelling has an Economic Factor of 90% (Rollback Basis=\$207,600)