

08-062200.0000

STEMEN DAVID A

STEMEN DAVID A
810 S MAIN
ROCKFORD, OH 45882

LEGAL INFORMATION

OL 41 PT
ALSO .061 FORMER RR ST
LOT#: 41
Acres:0.2810 M:0.0000

| | OWNERSHIP | ADDRESS | CITY | STATE | ZIP | DATE | AMOUNT | DEED:CONV# | JS | VALID |
|---|----------------|--------------|----------|-------|-------|------------|--------|------------|--------------------------|-------------------------------------|
| 1 | STEMEN DAVID A | 810 S MAIN | ROCKFORD | OH | 45882 | 01/07/2016 | 91,000 | WDC : 10 | <input type="checkbox"/> | <input checked="" type="checkbox"/> |
| 2 | MARSEE DEBRA C | 306 STATE ST | ROCKFORD | OH | 45882 | 04/06/1994 | 0 | : X : 0 | <input type="checkbox"/> | <input type="checkbox"/> |
| 3 | | | | | | | 0 | 0 | <input type="checkbox"/> | <input type="checkbox"/> |

X: TTO LISTER: RK DATE: 11/23/2004 TIME: 01:57:27 PM LETTER LETTER REC'D GIS CODE

STREET/ROAD TOPOGRAPHY PU-UTILITIES-PR NEIGHBORHOOD INFLUENCE FACTORS PROPERTY LOCATION

- PAVED LEVEL WATER IMPROVING A. NO ROAD F. RESTRICT
- GRAVEL HIGH SEWER STATIC B. TOPGRHY G. WOOD LT
- DIRT LOW GAS DECLINING C. Ex Front H. VACANCY
- SIDEWALKS ROLLING ELECTRIC OLD D. QUANTITY I. WATER FRONT
- CURBS STANDARD STANDARD E. SZ/SHAPE J. OTHER/CDU

810 S MAIN ST, ROCKFORD

COMMENT

TY2018:Net Gen=\$1,201.02, Other
Assessment=\$449.82
DE16 DESKTOP REVIEW CHG: cor dwlg msmnt
DE15 ADD A/C PER DATA MAILER
DE17 RMV OWN OCC/DIDN'T RET APP

LAND COMPUTATIONS

| LAND TYPE | SIZE | M | RATE | C | INF | M | VALUE | C |
|-----------|----------|-------|------|--------|-----|-------|--------|---|
| F:Front | F90 D132 | ST210 | DP94 | ADJ197 | | | 17,700 | 0 |
| | | | | | | TOTAL | 17,700 | 0 |

VALUATION SUMMARY

| VALUE YEAR | 2017 | 2016 | 2015 | 2014 | 2011 |
|-------------------|--------|--------|--------|--------|--------|
| REASON FOR CHANGE | RAPP | MISC | MISC | RAPP | RAPP |
| APPRAISED | 17,700 | 17,100 | 17,100 | 17,100 | 18,600 |
| VALUE | IMPR | 63,400 | 66,800 | 61,800 | 60,900 |
| | TOTAL | 81,100 | 83,900 | 78,900 | 78,000 |
| ASSESSED | LAND | 6,200 | 5,990 | 5,990 | 5,990 |
| VALUE | IMPR | 22,190 | 23,380 | 21,630 | 21,320 |
| | TOTAL | 28,390 | 29,370 | 27,620 | 29,680 |

| OCCUPANCY | EXTERIOR |
|--|---|
| <input checked="" type="checkbox"/> SINGL FMLY | <input type="checkbox"/> WOOD |
| <input type="checkbox"/> DUPLEX | <input type="checkbox"/> STUCCO |
| <input type="checkbox"/> TRIPLEX | <input type="checkbox"/> ALM/VYNL |
| <input type="checkbox"/> CONVR | <input type="checkbox"/> CONC BLK |
| <input type="checkbox"/> MOBILE HM | <input type="checkbox"/> METAL |
| <input type="checkbox"/> BI/L TRI/L | <input checked="" type="checkbox"/> BRICK |
| <input type="checkbox"/> MOD/MAN | <input type="checkbox"/> STONE |

| ROOFING | ROOF TYPE |
|--|---|
| <input type="checkbox"/> METAL | <input type="checkbox"/> GABLE |
| <input type="checkbox"/> SLT/TLE | <input checked="" type="checkbox"/> HIP |
| <input checked="" type="checkbox"/> SHINGLES | <input type="checkbox"/> GAMBREL |
| <input type="checkbox"/> SHAKES | <input type="checkbox"/> MANSARD |
| <input type="checkbox"/> COMPOSITE | <input type="checkbox"/> FLAT |

| FLOORS | B | 1 | 2 | 3 | U |
|------------|--------------------------|-------------------------------------|--------------------------|--------------------------|--------------------------|
| CONCRETE | <input type="checkbox"/> | <input type="checkbox"/> | <input type="checkbox"/> | <input type="checkbox"/> | <input type="checkbox"/> |
| WOOD | <input type="checkbox"/> | <input checked="" type="checkbox"/> | <input type="checkbox"/> | <input type="checkbox"/> | <input type="checkbox"/> |
| TILE/COMPO | <input type="checkbox"/> | <input checked="" type="checkbox"/> | <input type="checkbox"/> | <input type="checkbox"/> | <input type="checkbox"/> |
| CARPET | <input type="checkbox"/> | <input checked="" type="checkbox"/> | <input type="checkbox"/> | <input type="checkbox"/> | <input type="checkbox"/> |

| INT. FINISH | B | 1 | 2 | 3 | U |
|-------------|--------------------------|-------------------------------------|--------------------------|--------------------------|--------------------------|
| PLASTER/DW | <input type="checkbox"/> | <input checked="" type="checkbox"/> | <input type="checkbox"/> | <input type="checkbox"/> | <input type="checkbox"/> |
| PANELING | <input type="checkbox"/> | <input type="checkbox"/> | <input type="checkbox"/> | <input type="checkbox"/> | <input type="checkbox"/> |
| UNFINISHED | <input type="checkbox"/> | <input type="checkbox"/> | <input type="checkbox"/> | <input type="checkbox"/> | <input type="checkbox"/> |

| ACCOMMODATIONS | | | | | |
|----------------|--|---|--|--|--|
| # OF ROOMS | | 6 | | | |
| BEDROOMS | | 3 | | | |
| FIREPLACES | | | | | |

| HEAT & AC | B | 1 | 2 | 3 | U |
|-----------|--------------------------|-------------------------------------|--------------------------|--------------------------|--------------------------|
| NO HEAT | <input type="checkbox"/> | <input type="checkbox"/> | <input type="checkbox"/> | <input type="checkbox"/> | <input type="checkbox"/> |
| CTRL HEAT | <input type="checkbox"/> | <input checked="" type="checkbox"/> | <input type="checkbox"/> | <input type="checkbox"/> | <input type="checkbox"/> |
| HW/STEAM | <input type="checkbox"/> | <input type="checkbox"/> | <input type="checkbox"/> | <input type="checkbox"/> | <input type="checkbox"/> |
| ELECTRIC | <input type="checkbox"/> | <input type="checkbox"/> | <input type="checkbox"/> | <input type="checkbox"/> | <input type="checkbox"/> |
| HEAT PUMP | <input type="checkbox"/> | <input type="checkbox"/> | <input type="checkbox"/> | <input type="checkbox"/> | <input type="checkbox"/> |
| FLR/WALL | <input type="checkbox"/> | <input type="checkbox"/> | <input type="checkbox"/> | <input type="checkbox"/> | <input type="checkbox"/> |
| STVE/SPCE | <input type="checkbox"/> | <input type="checkbox"/> | <input type="checkbox"/> | <input type="checkbox"/> | <input type="checkbox"/> |
| GEOHERMAL | <input type="checkbox"/> | <input type="checkbox"/> | <input type="checkbox"/> | <input type="checkbox"/> | <input type="checkbox"/> |
| OUTSIDE | <input type="checkbox"/> | <input type="checkbox"/> | <input type="checkbox"/> | <input type="checkbox"/> | <input type="checkbox"/> |
| CTRL A/C | <input type="checkbox"/> | <input checked="" type="checkbox"/> | <input type="checkbox"/> | <input type="checkbox"/> | <input type="checkbox"/> |

| PLUMBING | BASE |
|-------------|--------------------------|
| X FULL BATH | <input type="checkbox"/> |
| X HALF BATH | <input type="checkbox"/> |
| X FIXTURES | <input type="checkbox"/> |

| FLOOR | AREA | CONST | VALUE |
|-------------------------|------------|-------|----------------|
| 1 | 1272 | BRK | 114,350 |
| BSMT | 1272 | | 16,540 |
| SUBTOTAL | | | 130,890 |
| MULTI-FAMILY # | 0 | | 0 |
| BSMT FINISH | 0 S.F. | | 0 |
| FIREPLACE # | 0 | | 0 |
| HEATING | 0 S.F. | | 0 |
| AIR COND | 1,272 S.F. | | 1,910 |
| PLUMBING # | 2 | | 2,200 |
| GARAGES & CARPORTS | | | 12,900 |
| EXTRA FEATURES | | | 900 |
| SUBTOTAL | | | 148,800 |
| GRADE FACTOR | | | 100 % |
| UNADJUSTED VALUE | | | 148,800 |
| FACTOR | | | 100 % |

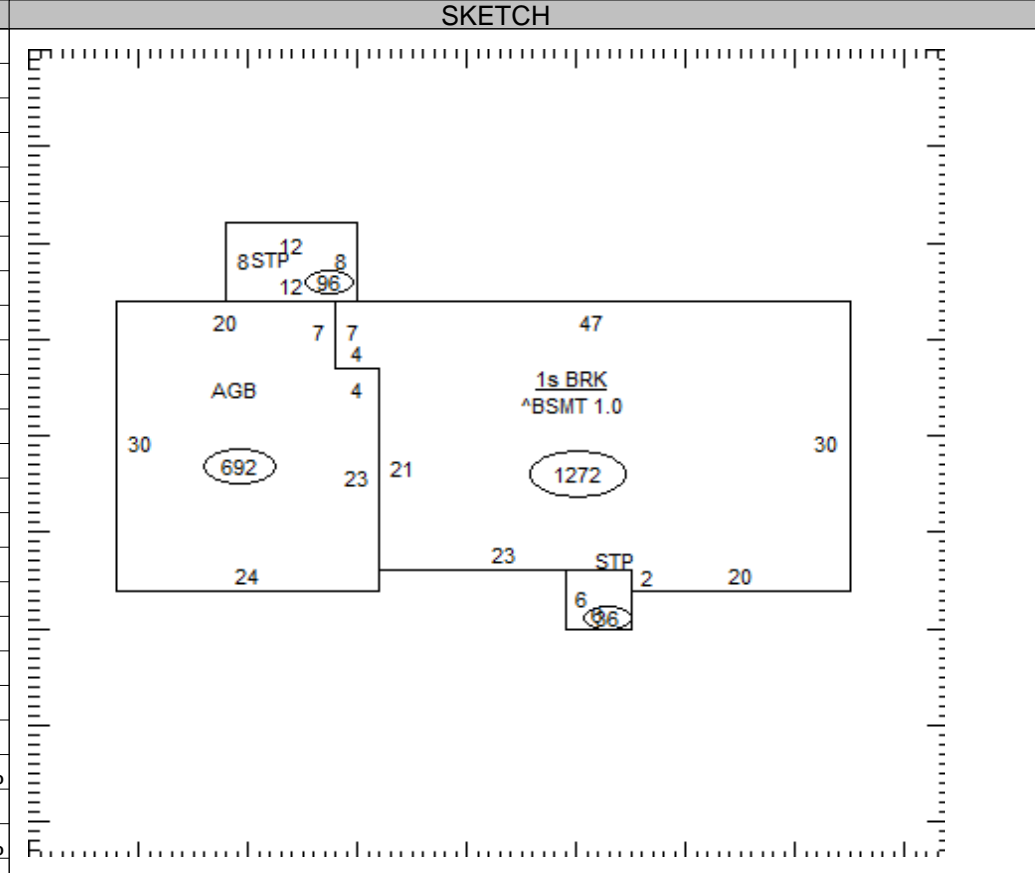

| OCCUPANCY | ST.HT | SIZE | AREA | GRADE | PRICE | AGE | REMD | CND | UNADJ VAL | PHYS | PHYS VAL | FUNC | TRUE VAL |
|-----------|-------|------|-------|-------|-------|------|------|-----|-----------|------|----------|------|----------|
| DWELLING | 1 | SK | 1,272 | C | | 1963 | | A | 148,800 | 40 | 89,280 | | 63,400 |
| 1 | | | | | | | | | | | | | |
| 2 | | | | | | | | | | | | | |
| 3 | | | | | | | | | | | | | |
| 4 | | | | | | | | | | | | | |
| 5 | | | | | | | | | | | | | |
| 6 | | | | | | | | | | | | | |
| 7 | | | | | | | | | | | | | |
| 8 | | | | | | | | | | | | | |
| 9 | | | | | | | | | | | | | |
| 10 | | | | | | | | | | | | | |
| 11 | | | | | | | | | | | | | |

08-062200.0000 TOTAL 63,400

COMMENTS

Dwelling has an Economic Factor of 71%