

05-069900.0000

HUBER JOSHUA M
HUBER JOSHUA M
407 E COLLEGE ST
COLDWATER, OH 45828

LEGAL INFORMATION
FETZERS 2ND ADD

LOT#: 319

| | OWNERSHIP | ADDRESS | CITY | STATE | ZIP | DATE | AMOUNT | DEED:CONV# | JS | VALID |
|---|----------------|------------------|-----------|-------|-------|------------|--------|-------------|--------------------------|-------------------------------------|
| 1 | HUBER JOSHUA M | 407 E COLLEGE ST | COLDWATER | OH | 45828 | 06/20/2016 | 47,000 | WDC : 409 | <input type="checkbox"/> | <input checked="" type="checkbox"/> |
| 2 | BUSCHUR DALE T | 407 E COLLEGE ST | COLDWATER | OH | 45828 | 03/21/2005 | 0 | QCE : X : 0 | <input type="checkbox"/> | <input type="checkbox"/> |
| 3 | BUSCHUR DALE T | 407 E COLLEGE ST | COLDWATER | OH | 45828 | | 0 | : 0 | <input type="checkbox"/> | <input type="checkbox"/> |

X: TTO LISTER: NS DATE: 02/08/2005 TIME: 12:00:00 AM LETTER LETTER REC'D GIS CODE

| STREET/ROAD | TOPOGRAPHY | PU-UTILITIES-PR | NEIGHBORHOOD | INFLUENCE FACTORS | | | | PROPERTY LOCATION |
|---|---|--|--|--------------------------------------|---|--|--|-------------------|
| <input checked="" type="checkbox"/> PAVED | <input checked="" type="checkbox"/> LEVEL | <input type="checkbox"/> WATER | <input type="checkbox"/> IMPROVING | <input type="checkbox"/> A. NO ROAD | <input type="checkbox"/> F. RESTRICT | 407 E COLLEGE ST, COLDWATER | | |
| <input type="checkbox"/> GRAVEL | <input type="checkbox"/> HIGH | <input type="checkbox"/> SEWER | <input checked="" type="checkbox"/> STATIC | <input type="checkbox"/> B. TOPGRHY | <input type="checkbox"/> G. WOOD LT | COMMENT | | |
| <input type="checkbox"/> DIRT | <input type="checkbox"/> LOW | <input type="checkbox"/> GAS | <input type="checkbox"/> DECLINING | <input type="checkbox"/> C. Ex Front | <input type="checkbox"/> H. VACANCY | TY2018:Net Gen=\$1,256.28, Other Assessment=\$0.00 | | |
| <input checked="" type="checkbox"/> SIDEWALKS | <input type="checkbox"/> ROLLING | <input type="checkbox"/> ELECTRIC | <input type="checkbox"/> OLD | <input type="checkbox"/> D. QUANTITY | <input type="checkbox"/> I. WATER FRONT | de09 corr cent ac per data mailer | | |
| <input type="checkbox"/> CURBS | <input type="checkbox"/> STANDARD | <input checked="" type="checkbox"/> STANDARD | <input type="checkbox"/> STANDARD | <input type="checkbox"/> E. SZ/SHAPE | <input type="checkbox"/> J. OTHER/CDU | | | |

LAND COMPUTATIONS

| LAND TYPE | SIZE | M | RATE | C | INF | M | VALUE | C |
|-----------|----------|-------|------|--------|-------|---|-------|---|
| F:Front | F50 D132 | ST200 | DP94 | ADJ188 | | | 9,400 | 0 |
| | | | | | TOTAL | | 9,400 | 0 |

VALUATION SUMMARY

| VALUE YEAR | 2017 | 2014 | 2011 | 2009 | | | | |
|-------------------|--------------|--------|--------|--------|--------|--|--|--|
| REASON FOR CHANGE | RAPP | RAPP | RAPP | MISC | | | | |
| APPRAISED | <u>LAND</u> | 9,400 | 9,400 | 9,400 | 8,300 | | | |
| VALUE | <u>IMPR</u> | 90,300 | 70,500 | 70,500 | 48,600 | | | |
| | <u>TOTAL</u> | 99,700 | 79,900 | 79,900 | 56,900 | | | |
| ASSESSED | <u>LAND</u> | 3,290 | 3,290 | 3,290 | 2,910 | | | |
| VALUE | <u>IMPR</u> | 31,610 | 24,680 | 24,680 | 17,010 | | | |
| | <u>TOTAL</u> | 34,900 | 27,970 | 27,970 | 19,920 | | | |

| OCCUPANCY | EXTERIOR |
|--|---|
| <input checked="" type="checkbox"/> SINGL FMLY | <input checked="" type="checkbox"/> WOOD |
| <input type="checkbox"/> DUPLEX | <input type="checkbox"/> STUCCO |
| <input type="checkbox"/> TRIPLEX | <input type="checkbox"/> ALM/VYNL |
| <input type="checkbox"/> CONVR | <input type="checkbox"/> CONC BLK |
| <input type="checkbox"/> MOBILE HM | <input type="checkbox"/> METAL |
| <input type="checkbox"/> BI/L TRI/L | <input checked="" type="checkbox"/> BRICK |
| <input type="checkbox"/> MOD/MAN | <input type="checkbox"/> STONE |

| ROOFING | ROOF TYPE |
|--|---|
| <input type="checkbox"/> METAL | <input checked="" type="checkbox"/> GABLE |
| <input type="checkbox"/> SLT/TLE | <input type="checkbox"/> HIP |
| <input checked="" type="checkbox"/> SHINGLES | <input type="checkbox"/> GAMBREL |
| <input type="checkbox"/> SHAKES | <input type="checkbox"/> MANSARD |
| <input type="checkbox"/> COMPOSITE | <input type="checkbox"/> FLAT |

| FLOORS | B | 1 | 2 | 3 | U |
|------------|-------------------------------------|-------------------------------------|-------------------------------------|--------------------------|--------------------------|
| CONCRETE | <input checked="" type="checkbox"/> | <input type="checkbox"/> | <input type="checkbox"/> | <input type="checkbox"/> | <input type="checkbox"/> |
| WOOD | <input type="checkbox"/> | <input checked="" type="checkbox"/> | <input checked="" type="checkbox"/> | <input type="checkbox"/> | <input type="checkbox"/> |
| TILE/COMPO | <input type="checkbox"/> | <input type="checkbox"/> | <input checked="" type="checkbox"/> | <input type="checkbox"/> | <input type="checkbox"/> |
| CARPET | <input type="checkbox"/> | <input checked="" type="checkbox"/> | <input type="checkbox"/> | <input type="checkbox"/> | <input type="checkbox"/> |

| INT. FINISH | B | 1 | 2 | 3 | U |
|-------------|-------------------------------------|-------------------------------------|-------------------------------------|--------------------------|--------------------------|
| PLASTER/DW | <input type="checkbox"/> | <input checked="" type="checkbox"/> | <input checked="" type="checkbox"/> | <input type="checkbox"/> | <input type="checkbox"/> |
| PANELING | <input type="checkbox"/> | <input type="checkbox"/> | <input checked="" type="checkbox"/> | <input type="checkbox"/> | <input type="checkbox"/> |
| UNFINISHED | <input checked="" type="checkbox"/> | <input type="checkbox"/> | <input type="checkbox"/> | <input type="checkbox"/> | <input type="checkbox"/> |

| ACCOMMODATIONS | | | | | |
|----------------|--|---|---|--|--|
| # OF ROOMS | | 5 | 1 | | |
| BEDROOMS | | 1 | 1 | | |
| FIREPLACES | | 1 | | | |

| HEAT & AC | B | 1 | 2 | 3 | U |
|-------------|--------------------------|-------------------------------------|-------------------------------------|--------------------------|--------------------------|
| NO HEAT | <input type="checkbox"/> | <input type="checkbox"/> | <input type="checkbox"/> | <input type="checkbox"/> | <input type="checkbox"/> |
| CTRL HEAT | <input type="checkbox"/> | <input checked="" type="checkbox"/> | <input checked="" type="checkbox"/> | <input type="checkbox"/> | <input type="checkbox"/> |
| HW/STEAM | <input type="checkbox"/> | <input type="checkbox"/> | <input type="checkbox"/> | <input type="checkbox"/> | <input type="checkbox"/> |
| ELECTRIC | <input type="checkbox"/> | <input type="checkbox"/> | <input type="checkbox"/> | <input type="checkbox"/> | <input type="checkbox"/> |
| HEAT PUMP | <input type="checkbox"/> | <input type="checkbox"/> | <input type="checkbox"/> | <input type="checkbox"/> | <input type="checkbox"/> |
| FLR/WALL | <input type="checkbox"/> | <input type="checkbox"/> | <input type="checkbox"/> | <input type="checkbox"/> | <input type="checkbox"/> |
| STVE/SPCE | <input type="checkbox"/> | <input type="checkbox"/> | <input type="checkbox"/> | <input type="checkbox"/> | <input type="checkbox"/> |
| GEO THERMAL | <input type="checkbox"/> | <input type="checkbox"/> | <input type="checkbox"/> | <input type="checkbox"/> | <input type="checkbox"/> |
| OUTSIDE | <input type="checkbox"/> | <input type="checkbox"/> | <input type="checkbox"/> | <input type="checkbox"/> | <input type="checkbox"/> |
| CTRL A/C | <input type="checkbox"/> | <input checked="" type="checkbox"/> | <input checked="" type="checkbox"/> | <input type="checkbox"/> | <input type="checkbox"/> |

| PLUMBING | BASE |
|-------------|-------------------------------------|
| X FULL BATH | <input checked="" type="checkbox"/> |
| X HALF BATH | <input type="checkbox"/> |
| X FIXTURES | <input type="checkbox"/> |

| FLOOR | AREA | CONST | VALUE |
|-------------------------|------------|-------|----------------|
| 1 | 1030 | BRK | 100,930 |
| .25 | 228 | FR | 15,830 |
| BSMT | 910 | | 11,830 |
| SUBTOTAL | | | 128,590 |
| MULTI-FAMILY # | 0 | | 0 |
| BSMT FINISH | 0 S.F. | | 0 |
| FIREPLACE # | 1 | | 4,000 |
| HEATING | 0 S.F. | | 0 |
| AIR COND | 1,258 S.F. | | 1,890 |
| PLUMBING # | 0 | | 0 |
| GARAGES & CARPORTS | | | 0 |
| EXTRA FEATURES | | | 1,200 |
| SUBTOTAL | | | 135,680 |
| GRADE FACTOR | | | 105 % |
| UNADJUSTED VALUE | | | 142,460 |
| FACTOR | | | 100 % |

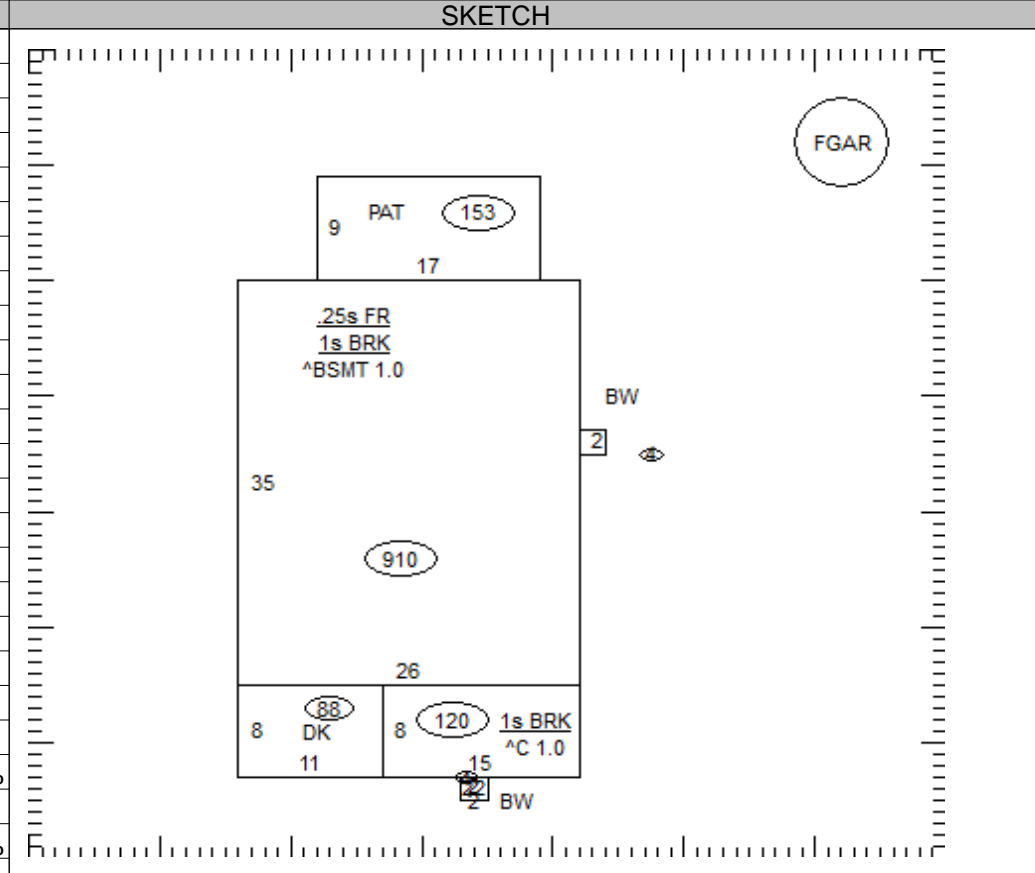

| OCCUPANCY | ST.HT | SIZE | AREA | GRADE | PRICE | AGE | REMD | CND | UNADJ VAL | PHYS | PHYS VAL | FUNC | TRUE VAL |
|---------------|-------|-------|-------|-------|-------|------|------|-----|-----------|------|----------|------|----------|
| DWELLING | 1.25 | SK | 1,258 | C+ | | 1930 | | A | 142,460 | 45 | 78,350 | | 90,100 |
| 1 Gar - Frame | | 18x20 | 360 | D | 12.64 | 1930 | | A | 4,550 | 95 | 230 | | 200 |
| 2 | | | | | | | | | | | | | |
| 3 | | | | | | | | | | | | | |
| 4 | | | | | | | | | | | | | |
| 5 | | | | | | | | | | | | | |
| 6 | | | | | | | | | | | | | |
| 7 | | | | | | | | | | | | | |
| 8 | | | | | | | | | | | | | |
| 9 | | | | | | | | | | | | | |
| 10 | | | | | | | | | | | | | |
| 11 | | | | | | | | | | | | | |

05-069900.0000

TOTAL 90,300

COMMENTS

Dwelling has an Economic Factor of 115%