

1 OF 2		
PROP. CLASS		
1	1	1
NEIGHBORHOOD		
009091-A130		
M	13	
B		
C	24	

09-134400.0000

HEIN JAY J & NORMA J

HEIN JAY J & NORMA J
8109 CLOVER FOUR RD
CELINA, OH 45822

LEGAL INFORMATION

W PT S SD SW
ALSO .046 AC SEC 32
RTS: 003-06-33
Acres:43.7040

**QUALIFIED CREDITS: CAUV:
00630**

	OWNERSHIP	ADDRESS	CITY	STATE	ZIP	DATE	AMOUNT	DEED:CONV#	JS	VALID
1	HEIN JAY J & NORMA J	8109 CLOVER FOUR RD	CELINA	OH	45822	11/28/2016	605,000	WDC : 830	<input type="checkbox"/>	<input checked="" type="checkbox"/>
2	SCHOEN KELLI	4103 COUNTY ROAD 716A	CELINA	OH	45822	10/16/1998	0	: X : 0	<input type="checkbox"/>	<input type="checkbox"/>
3							0	0	<input type="checkbox"/>	<input type="checkbox"/>

X: TTO LISTER: BTC DATE: 04/12/2011 TIME: 12:00:00 AM LETTER LETTER REC'D GIS CODE

STREET/ROAD	TOPOGRAPHY	PU-UTILITIES-PR	NEIGHBORHOOD	INFLUENCE FACTORS	PROPERTY LOCATION	
<input checked="" type="checkbox"/> PAVED <input type="checkbox"/> GRAVEL <input type="checkbox"/> DIRT <input type="checkbox"/> SIDEWALKS <input type="checkbox"/> CURBS	<input checked="" type="checkbox"/> LEVEL <input type="checkbox"/> HIGH <input type="checkbox"/> LOW <input type="checkbox"/> ROLLING <input type="checkbox"/> STANDARD	<input type="checkbox"/> WATER <input type="checkbox"/> SEWER <input type="checkbox"/> GAS <input checked="" type="checkbox"/> ELECTRIC <input type="checkbox"/> STANDARD	<input type="checkbox"/> IMPROVING <input checked="" type="checkbox"/> STATIC <input type="checkbox"/> DECLINING <input type="checkbox"/> OLD <input type="checkbox"/> STANDARD	<input type="checkbox"/> A. NO ROAD <input type="checkbox"/> B. TOPGRHY <input type="checkbox"/> C. Ex Front <input type="checkbox"/> D. QUANTITY <input type="checkbox"/> E. SZ/SHAPE	<input type="checkbox"/> F. RESTRICT <input type="checkbox"/> G. WOOD LT <input type="checkbox"/> H. VACANCY <input type="checkbox"/> I. WATER FRONT <input type="checkbox"/> J. OTHER/CDU	4103 COUNTY ROAD 716A , CELINA COMMENT TY2018:Net Gen=\$3,551.42, Other Assessment=\$0.00 DE17 FIELDCHK RVW CHG: COR SK, ADD LT DE15 RMV GB'S PER DATA MAILER DE11 CORR SK, CORR OUTBLDGS, ADD PB BEWARE OF DOGS (Mod CR:)120

LAND COMPUTATIONS							
LAND TYPE	SIZE	M	RATE	C	INF	M	VALUE C
CR:Crop Land TOTAL	A 39.9740		9,835	1,754		400,500	77,370
0070	A 12.4000		10,140	1,955		125,740	24,240
0077	A 3.5000		9,460	1,325		33,110	4,640
0079	A 10.7000		8,360	545		89,450	5,830
0087	A 13.3740		11,380	3,190		152,200	42,660
HS:Home Site:0601	A 1.0000		16,500	16,500		16,500	16,500
RD:Road:0900	A 1.9800		0	0		0	0
WS:Waste:0990	A .7500		100	50		80	40
Total Acres: 43.7040					TOTAL	417,080	93,910

VALUATION SUMMARY								
VALUE YEAR	2017	2017	2017	2017	2015	2015	2014	2014
REASON FOR CHANGE	CAUV	RAPP	CAUV	MISC	CAUV	REMB	CAUV	RAPP
APPRAISED	93,910	417,080	126,220	323,070	126,220	323,070	126,220	323,070
VALUE	IMPR	134,200	134,200	155,100	155,100	138,000	142,200	142,200
	TOTAL	228,110	551,280	281,320	478,170	264,220	268,420	465,270
ASSESSED	LAND	32,870	145,980	44,180	113,070	44,180	44,180	113,070
VALUE	IMPR	46,970	46,970	54,290	54,290	48,300	49,770	49,770
	TOTAL	79,840	192,950	98,470	167,360	92,480	93,950	162,840
CAUV TAX SAVINGS	2018=5103.18, 2017=5104.76, 2016=3064.86: Total=13272.80							

OCCUPANCY	EXTERIOR	FLOOR	AREA	CONST	VALUE
<input checked="" type="checkbox"/> SNGL FMLY	<input type="checkbox"/> WOOD	1	1820	FR	130,400
<input type="checkbox"/> DUPLEX	<input type="checkbox"/> STUCCO	2ND	940	FR	32,330
<input type="checkbox"/> TRIPLEX	<input checked="" type="checkbox"/> ALM/VYNL				
<input type="checkbox"/> CONVR	<input type="checkbox"/> CONC BLK				
<input type="checkbox"/> MOBILE HM	<input type="checkbox"/> METAL				
<input type="checkbox"/> BI/L TRI/L	<input type="checkbox"/> BRICK				
<input type="checkbox"/> MOD/MAN	<input type="checkbox"/> STONE				
ROOFING	ROOF TYPE				
<input type="checkbox"/> METAL	<input checked="" type="checkbox"/> GABLE				
<input type="checkbox"/> SLT/TLE	<input type="checkbox"/> HIP				
<input checked="" type="checkbox"/> SHINGLES	<input type="checkbox"/> GAMBREL				
<input type="checkbox"/> SHAKES	<input type="checkbox"/> MANSARD				
<input type="checkbox"/> COMPOSITE	<input type="checkbox"/> FLAT				
		BSMT	235		3,060
SUBTOTAL					165,790
FLOORS	B	1	2	3	U
CONCRETE	<input checked="" type="checkbox"/>	<input type="checkbox"/>	<input type="checkbox"/>	<input type="checkbox"/>	<input type="checkbox"/>
WOOD	<input type="checkbox"/>	<input type="checkbox"/>	<input type="checkbox"/>	<input type="checkbox"/>	<input type="checkbox"/>
TILE/COMPO	<input type="checkbox"/>	<input checked="" type="checkbox"/>	<input type="checkbox"/>	<input type="checkbox"/>	<input type="checkbox"/>
CARPET	<input type="checkbox"/>	<input checked="" type="checkbox"/>	<input checked="" type="checkbox"/>	<input type="checkbox"/>	<input type="checkbox"/>
INT. FINISH	B	1	2	3	U
PLASTER/DW	<input type="checkbox"/>	<input checked="" type="checkbox"/>	<input checked="" type="checkbox"/>	<input type="checkbox"/>	<input type="checkbox"/>
PANELING	<input type="checkbox"/>	<input type="checkbox"/>	<input type="checkbox"/>	<input type="checkbox"/>	<input type="checkbox"/>
UNFINISHED	<input checked="" type="checkbox"/>	<input type="checkbox"/>	<input type="checkbox"/>	<input type="checkbox"/>	<input type="checkbox"/>
ACCOMMODATIONS					
# OF ROOMS	1	6	4		
BEDROOMS		2	3		
FIREPLACES					
HEAT & AC	B	1	2	3	U
NO HEAT	<input type="checkbox"/>	<input type="checkbox"/>	<input type="checkbox"/>	<input type="checkbox"/>	<input type="checkbox"/>
CTRL HEAT	<input type="checkbox"/>	<input checked="" type="checkbox"/>	<input checked="" type="checkbox"/>	<input type="checkbox"/>	<input type="checkbox"/>
HW/STEAM	<input type="checkbox"/>	<input type="checkbox"/>	<input type="checkbox"/>	<input type="checkbox"/>	<input type="checkbox"/>
ELECTRIC	<input type="checkbox"/>	<input type="checkbox"/>	<input type="checkbox"/>	<input type="checkbox"/>	<input type="checkbox"/>
HEAT PUMP	<input type="checkbox"/>	<input type="checkbox"/>	<input type="checkbox"/>	<input type="checkbox"/>	<input type="checkbox"/>
FLR/WALL	<input type="checkbox"/>	<input type="checkbox"/>	<input type="checkbox"/>	<input type="checkbox"/>	<input type="checkbox"/>
STVE/SPCE	<input type="checkbox"/>	<input type="checkbox"/>	<input type="checkbox"/>	<input type="checkbox"/>	<input type="checkbox"/>
GEO THERMAL	<input type="checkbox"/>	<input type="checkbox"/>	<input type="checkbox"/>	<input type="checkbox"/>	<input type="checkbox"/>
OUTSIDE	<input type="checkbox"/>	<input type="checkbox"/>	<input type="checkbox"/>	<input type="checkbox"/>	<input type="checkbox"/>
CTRL A/C	<input type="checkbox"/>	<input checked="" type="checkbox"/>	<input checked="" type="checkbox"/>	<input type="checkbox"/>	<input type="checkbox"/>
PLUMBING	BASE <input checked="" type="checkbox"/>				
X FULL BATH		1			
X HALF BATH					
X FIXTURES					
SUBTOTAL					195,530
GRADE FACTOR					105 %
UNADJUSTED VALUE					205,310
FACTOR					100 %

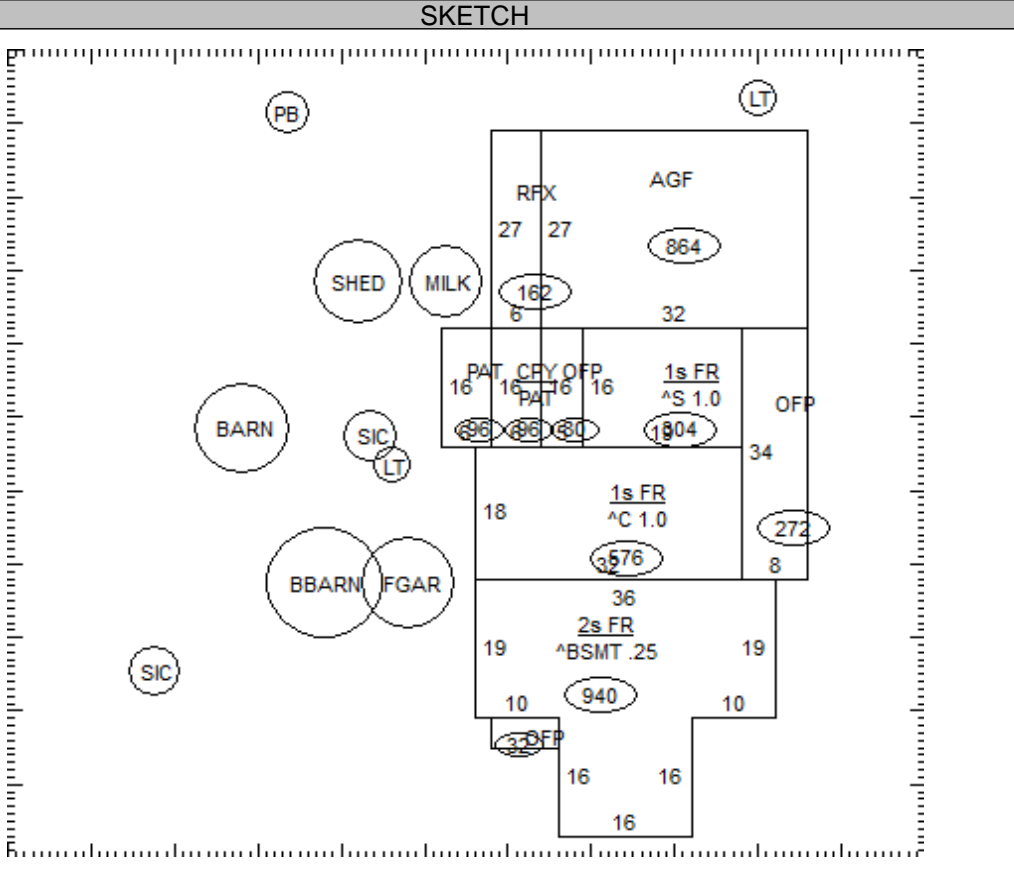

OCCUPANCY	ST.HT	SIZE	AREA	GRADE	PRICE	AGE	REMD	CND	UNADJ VAL	PHYS	PHYS VAL	FUNC	TRUE VAL
DWELLING	2	SK	2,760	C+		1876		A	205,310	45	112,920		105,000
1 Barn	14	49x74	3,626	C	8.00	1968		A	29,010	80	5,800		5,800
2 Lean - To	8	17x55	935	C	3.20	1955		A	2,990	90	300		300
3 Silo - Concrete	60	60x16	960	C	500.00	1960		A	500		500		500
4 Shed	8	26x42	1,092	C	5.00	1960		F	5,460	85	820		800
5 Barn-Bank	14	48x65	3,120	C	10.00	1960		A	31,200	85	4,680		4,700
6 Gar - Frame	6	20x26	520	D	12.64	1975		F	6,570	80	1,310		1,300
7 Milk House / Par	5	12x17	204	C	12.00	1960		F	2,450	85	370		400
8 Silo - Concrete	80	80x20	1,600	C	500.00	1997		A	500		500		500
9 Pole Bldg		64x40	2,560	C	7.80	1999		A	19,970	31	13,780		13,800
10 Lean - To		17x36	612	D	2.56	1999		A	1,570	32	1,070		1,100
11													

09-134400.0000

TOTAL 134,200

COMMENTS

Dwelling has an Economic Factor of 93%



2 OF 2		
PROP. CLASS		
1	1	1
NEIGHBORHOOD		
009091-A130		
M	13	
B		
C	24	

09-134400.0000

HEIN JAY J & NORMA J

HEIN JAY J & NORMA J
8109 CLOVER FOUR RD
CELINA, OH 45822

LEGAL INFORMATION

W PT S SD SW
ALSO .046 AC SEC 32
RTS: 003-06-33
Acres:43.7040

**QUALIFIED CREDITS: CAUV:
00630**

	OWNERSHIP	ADDRESS	CITY	STATE	ZIP	DATE	AMOUNT	DEED:CONV#	JS	VALID
1	HEIN JAY J & NORMA J	8109 CLOVER FOUR RD	CELINA	OH	45822	11/28/2016	605,000	WDC : 830	<input type="checkbox"/>	<input checked="" type="checkbox"/>
2	SCHOEN KELLI	4103 COUNTY ROAD 716A	CELINA	OH	45822	10/16/1998	0	: X : 0	<input type="checkbox"/>	<input type="checkbox"/>
3							0	0	<input type="checkbox"/>	<input type="checkbox"/>

X: TTO LISTER: BTC DATE: 04/12/2011 TIME: 12:00:00 AM LETTER LETTER REC'D GIS CODE

STREET/ROAD	TOPOGRAPHY	PU-UTILITIES-PR	NEIGHBORHOOD	INFLUENCE FACTORS	PROPERTY LOCATION	
<input checked="" type="checkbox"/> PAVED <input type="checkbox"/> GRAVEL <input type="checkbox"/> DIRT <input type="checkbox"/> SIDEWALKS <input type="checkbox"/> CURBS	<input checked="" type="checkbox"/> LEVEL <input type="checkbox"/> HIGH <input type="checkbox"/> LOW <input type="checkbox"/> ROLLING <input type="checkbox"/> STANDARD	<input type="checkbox"/> WATER <input type="checkbox"/> SEWER <input type="checkbox"/> GAS <input checked="" type="checkbox"/> ELECTRIC <input type="checkbox"/> STANDARD	<input type="checkbox"/> IMPROVING <input checked="" type="checkbox"/> STATIC <input type="checkbox"/> DECLINING <input type="checkbox"/> OLD <input type="checkbox"/> STANDARD	<input type="checkbox"/> A. NO ROAD <input type="checkbox"/> B. TOPGRHY <input type="checkbox"/> C. Ex Front <input type="checkbox"/> D. QUANTITY <input type="checkbox"/> E. SZ/SHAPE	<input type="checkbox"/> F. RESTRICT <input type="checkbox"/> G. WOOD LT <input type="checkbox"/> H. VACANCY <input type="checkbox"/> I. WATER FRONT <input type="checkbox"/> J. OTHER/CDU	4103 COUNTY ROAD 716A , CELINA COMMENT

LAND COMPUTATIONS							
LAND TYPE	SIZE	M	RATE	C	INF	M	VALUE C
Total Acres: 43.7040					TOTAL	417,080	93,910

VALUATION SUMMARY							
VALUE YEAR	2011	2011	2011	2011			
REASON FOR CHANGE	CAUV	RAPP	CAUV	NC			
APPRaised	LAND	59,490	227,820	33,670	189,840		
VALUE	IMPR	140,100	140,100	150,900	150,900		
	TOTAL	199,590	367,920	184,570	340,740		
ASSESSED	LAND	20,820	79,740	11,780	66,440		
VALUE	IMPR	49,040	49,040	52,820	52,820		
	TOTAL	69,860	128,780	64,600	119,260		
CAUV TAX SAVINGS	2018=5103.18, 2017=5104.76, 2016=3064.86: Total=13272.80						

OCCUPANCY	EXTERIOR	FLOOR	AREA	CONST	VALUE
<input type="checkbox"/> SNGL FMLY	<input type="checkbox"/> WOOD				
<input type="checkbox"/> DUPLEX	<input type="checkbox"/> STUCCO				
<input type="checkbox"/> TRIPLEX	<input type="checkbox"/> ALM/VYNL				
<input type="checkbox"/> CONVR	<input type="checkbox"/> CONC BLK				
<input type="checkbox"/> MOBILE HM	<input type="checkbox"/> METAL				
<input type="checkbox"/> BI/L TRI/L	<input type="checkbox"/> BRICK				
<input type="checkbox"/> MOD/MAN	<input type="checkbox"/> STONE				
ROOFING	ROOF TYPE				
<input type="checkbox"/> METAL	<input type="checkbox"/> GABLE				
<input type="checkbox"/> SLT/TLE	<input type="checkbox"/> HIP				
<input type="checkbox"/> SHINGLES	<input type="checkbox"/> GAMBREL				
<input type="checkbox"/> SHAKES	<input type="checkbox"/> MANSARD				
<input type="checkbox"/> COMPOSITE	<input type="checkbox"/> FLAT				
SUBTOTAL					0
FLOORS	B	1	2	3	U
CONCRETE	<input type="checkbox"/>	<input type="checkbox"/>	<input type="checkbox"/>	<input type="checkbox"/>	<input type="checkbox"/>
WOOD	<input type="checkbox"/>	<input type="checkbox"/>	<input type="checkbox"/>	<input type="checkbox"/>	<input type="checkbox"/>
TILE/COMPO	<input type="checkbox"/>	<input type="checkbox"/>	<input type="checkbox"/>	<input type="checkbox"/>	<input type="checkbox"/>
CARPET	<input type="checkbox"/>	<input type="checkbox"/>	<input type="checkbox"/>	<input type="checkbox"/>	<input type="checkbox"/>
INT. FINISH	B	1	2	3	U
PLASTER/DW	<input type="checkbox"/>	<input type="checkbox"/>	<input type="checkbox"/>	<input type="checkbox"/>	<input type="checkbox"/>
PANELING	<input type="checkbox"/>	<input type="checkbox"/>	<input type="checkbox"/>	<input type="checkbox"/>	<input type="checkbox"/>
UNFINISHED	<input type="checkbox"/>	<input type="checkbox"/>	<input type="checkbox"/>	<input type="checkbox"/>	<input type="checkbox"/>
ACCOMMODATIONS					
# OF ROOMS					
BEDROOMS					
FIREPLACES					
HEAT & AC	B	1	2	3	U
NO HEAT	<input type="checkbox"/>	<input type="checkbox"/>	<input type="checkbox"/>	<input type="checkbox"/>	<input type="checkbox"/>
CTRL HEAT	<input type="checkbox"/>	<input type="checkbox"/>	<input type="checkbox"/>	<input type="checkbox"/>	<input type="checkbox"/>
HW/STEAM	<input type="checkbox"/>	<input type="checkbox"/>	<input type="checkbox"/>	<input type="checkbox"/>	<input type="checkbox"/>
ELECTRIC	<input type="checkbox"/>	<input type="checkbox"/>	<input type="checkbox"/>	<input type="checkbox"/>	<input type="checkbox"/>
HEAT PUMP	<input type="checkbox"/>	<input type="checkbox"/>	<input type="checkbox"/>	<input type="checkbox"/>	<input type="checkbox"/>
FLR/WALL	<input type="checkbox"/>	<input type="checkbox"/>	<input type="checkbox"/>	<input type="checkbox"/>	<input type="checkbox"/>
STVE/SPCE	<input type="checkbox"/>	<input type="checkbox"/>	<input type="checkbox"/>	<input type="checkbox"/>	<input type="checkbox"/>
GEOHERMAL	<input type="checkbox"/>	<input type="checkbox"/>	<input type="checkbox"/>	<input type="checkbox"/>	<input type="checkbox"/>
OUTSIDE	<input type="checkbox"/>	<input type="checkbox"/>	<input type="checkbox"/>	<input type="checkbox"/>	<input type="checkbox"/>
CTRL A/C	<input type="checkbox"/>	<input type="checkbox"/>	<input type="checkbox"/>	<input type="checkbox"/>	<input type="checkbox"/>
PLUMBING	BASE <input type="checkbox"/>				
X FULL BATH					
X HALF BATH					
X FIXTURES					
SUBTOTAL					0
MULTI-FAMILY #					0
BSMT FINISH					0 S.F.
FIREPLACE #					0
HEATING					0 S.F.
AIR COND					0 S.F.
PLUMBING #					0
GARAGES & CARPORTS					0
EXTRA FEATURES					0
SUBTOTAL					0
GRADE FACTOR					%
UNADJUSTED VALUE					0
FACTOR					%

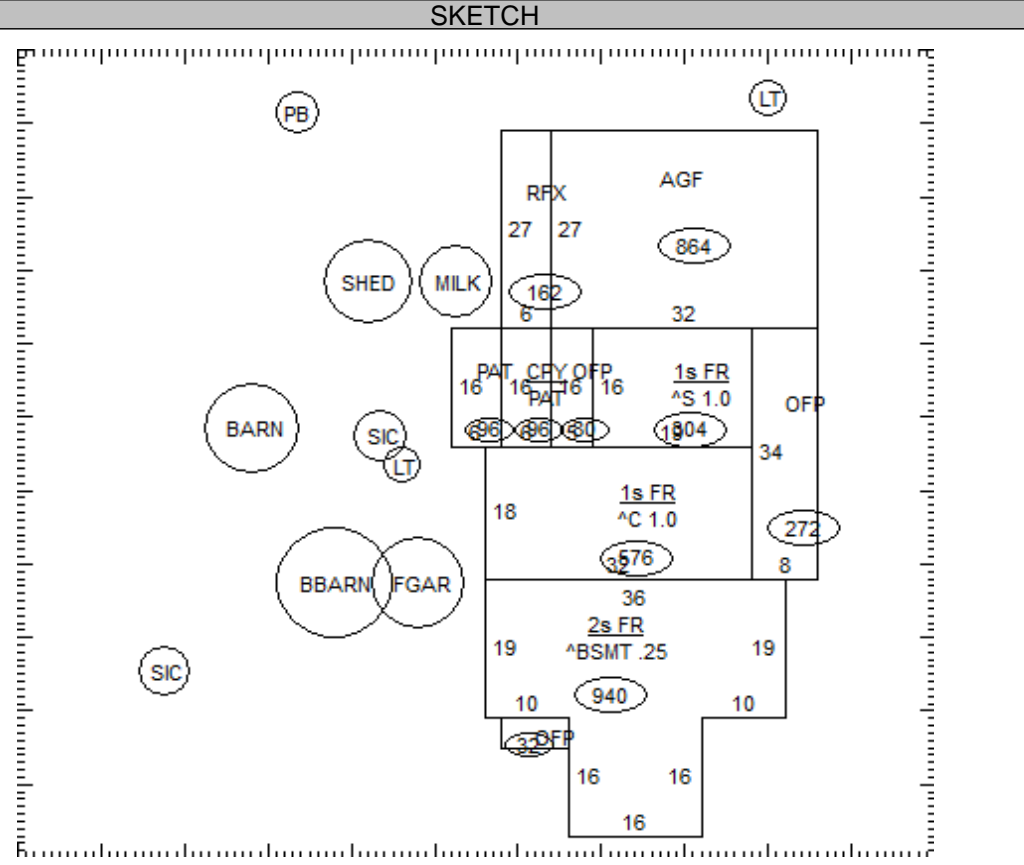

OCCUPANCY	ST.HT	SIZE	AREA	GRADE	PRICE	AGE	REMD	CND	UNADJ VAL	PHYS	PHYS VAL	FUNC	TRUE VAL
DWELLING		SK											
1													
2													
3													
4													
5													
6													
7													
8													
9													
10													
11													

09-134400.0000

TOTAL 0

COMMENTS