

| OCCUPANCY | EXTERIOR | FLOOR | AREA | CONST | VALUE |
|---|--|-------|------|-------|---------|
| <input checked="" type="checkbox"/> SNGL FMLY | <input type="checkbox"/> WOOD | 1 | 1421 | BRK | 113,590 |
| <input type="checkbox"/> DUPLEX | <input type="checkbox"/> STUCCO | 1 | 224 | FR | 16,740 |
| <input type="checkbox"/> TRIPLEX | <input checked="" type="checkbox"/> ALM/VYNL | .25 | 150 | FR | 8,890 |
| <input type="checkbox"/> CONVR | <input type="checkbox"/> CONC BLK | .25 | 355 | BRK | 22,520 |
| <input type="checkbox"/> MOBILE HM | <input type="checkbox"/> METAL | | | | |
| <input type="checkbox"/> BI/L TRI/L | <input checked="" type="checkbox"/> BRICK | | | | |
| <input type="checkbox"/> MOD/MAN | <input type="checkbox"/> STONE | | | | |

| ROOFING | ROOF TYPE |
|--|---|
| <input type="checkbox"/> METAL | <input checked="" type="checkbox"/> GABLE |
| <input type="checkbox"/> SLT/TLE | <input type="checkbox"/> HIP |
| <input checked="" type="checkbox"/> SHINGLES | <input type="checkbox"/> GAMBREL |
| <input type="checkbox"/> SHAKES | <input type="checkbox"/> MANSARD |
| <input type="checkbox"/> COMPOSITE | <input type="checkbox"/> FLAT |

| FLOORS | B | 1 | 2 | 3 | U |
|------------|-------------------------------------|-------------------------------------|--------------------------|--------------------------|--------------------------|
| CONCRETE | <input checked="" type="checkbox"/> | <input type="checkbox"/> | <input type="checkbox"/> | <input type="checkbox"/> | <input type="checkbox"/> |
| WOOD | <input type="checkbox"/> | <input type="checkbox"/> | <input type="checkbox"/> | <input type="checkbox"/> | <input type="checkbox"/> |
| TILE/COMPO | <input type="checkbox"/> | <input checked="" type="checkbox"/> | <input type="checkbox"/> | <input type="checkbox"/> | <input type="checkbox"/> |
| CARPET | <input type="checkbox"/> | <input checked="" type="checkbox"/> | <input type="checkbox"/> | <input type="checkbox"/> | <input type="checkbox"/> |

| INT. FINISH | B | 1 | 2 | 3 | U |
|-------------|-------------------------------------|-------------------------------------|--------------------------|--------------------------|--------------------------|
| PLASTER/DW | <input type="checkbox"/> | <input checked="" type="checkbox"/> | <input type="checkbox"/> | <input type="checkbox"/> | <input type="checkbox"/> |
| PANELING | <input type="checkbox"/> | <input type="checkbox"/> | <input type="checkbox"/> | <input type="checkbox"/> | <input type="checkbox"/> |
| UNFINISHED | <input checked="" type="checkbox"/> | <input type="checkbox"/> | <input type="checkbox"/> | <input type="checkbox"/> | <input type="checkbox"/> |

| ACCOMMODATIONS | # OF ROOMS | 1 | 6 | | |
|----------------|------------|---|---|--|--|
| BEDROOMS | | | 3 | | |

| HEAT & AC | B | 1 | 2 | 3 | U |
|-----------|-------------------------------------|-------------------------------------|-------------------------------------|-------------------------------------|-------------------------------------|
| NO HEAT | <input type="checkbox"/> | <input type="checkbox"/> | <input type="checkbox"/> | <input type="checkbox"/> | <input type="checkbox"/> |
| CTRL HEAT | <input checked="" type="checkbox"/> | <input checked="" type="checkbox"/> | <input checked="" type="checkbox"/> | <input checked="" type="checkbox"/> | <input checked="" type="checkbox"/> |
| HW/STEAM | <input type="checkbox"/> | <input type="checkbox"/> | <input type="checkbox"/> | <input type="checkbox"/> | <input type="checkbox"/> |
| ELECTRIC | <input type="checkbox"/> | <input type="checkbox"/> | <input type="checkbox"/> | <input type="checkbox"/> | <input type="checkbox"/> |
| HEAT PUMP | <input type="checkbox"/> | <input type="checkbox"/> | <input type="checkbox"/> | <input type="checkbox"/> | <input type="checkbox"/> |
| FLR/WALL | <input type="checkbox"/> | <input type="checkbox"/> | <input type="checkbox"/> | <input type="checkbox"/> | <input type="checkbox"/> |
| STVE/SPCE | <input type="checkbox"/> | <input type="checkbox"/> | <input type="checkbox"/> | <input type="checkbox"/> | <input type="checkbox"/> |
| GEOHERMAL | <input type="checkbox"/> | <input type="checkbox"/> | <input type="checkbox"/> | <input type="checkbox"/> | <input type="checkbox"/> |
| OUTSIDE | <input type="checkbox"/> | <input type="checkbox"/> | <input type="checkbox"/> | <input type="checkbox"/> | <input type="checkbox"/> |
| CTRL A/C | <input checked="" type="checkbox"/> | <input checked="" type="checkbox"/> | <input checked="" type="checkbox"/> | <input checked="" type="checkbox"/> | <input checked="" type="checkbox"/> |

| PLUMBING | BASE |
|-------------|--------------------------|
| X FULL BATH | <input type="checkbox"/> |
| X HALF BATH | <input type="checkbox"/> |
| X FIXTURES | <input type="checkbox"/> |

| BSMT | AREA | VALUE |
|-----------------|------|----------------|
| BSMT | 1421 | 18,470 |
| SUBTOTAL | | 180,210 |

| MULTI-FAMILY # | 0 | VALUE |
|-------------------------|------------|----------------|
| MULTI-FAMILY # | 0 | 0 |
| BSMT FINISH | 355 S.F. | 4,620 |
| FIREPLACE # | 0 | 0 |
| HEATING | 0 S.F. | 0 |
| AIR COND | 2,505 S.F. | 3,760 |
| PLUMBING # | 6 | 6,600 |
| GARAGES & CARPORTS | | 11,200 |
| EXTRA FEATURES | | 2,300 |
| SUBTOTAL | | 208,690 |
| GRADE FACTOR | | 115 % |
| UNADJUSTED VALUE | | 239,990 |
| FACTOR | | 100 % |

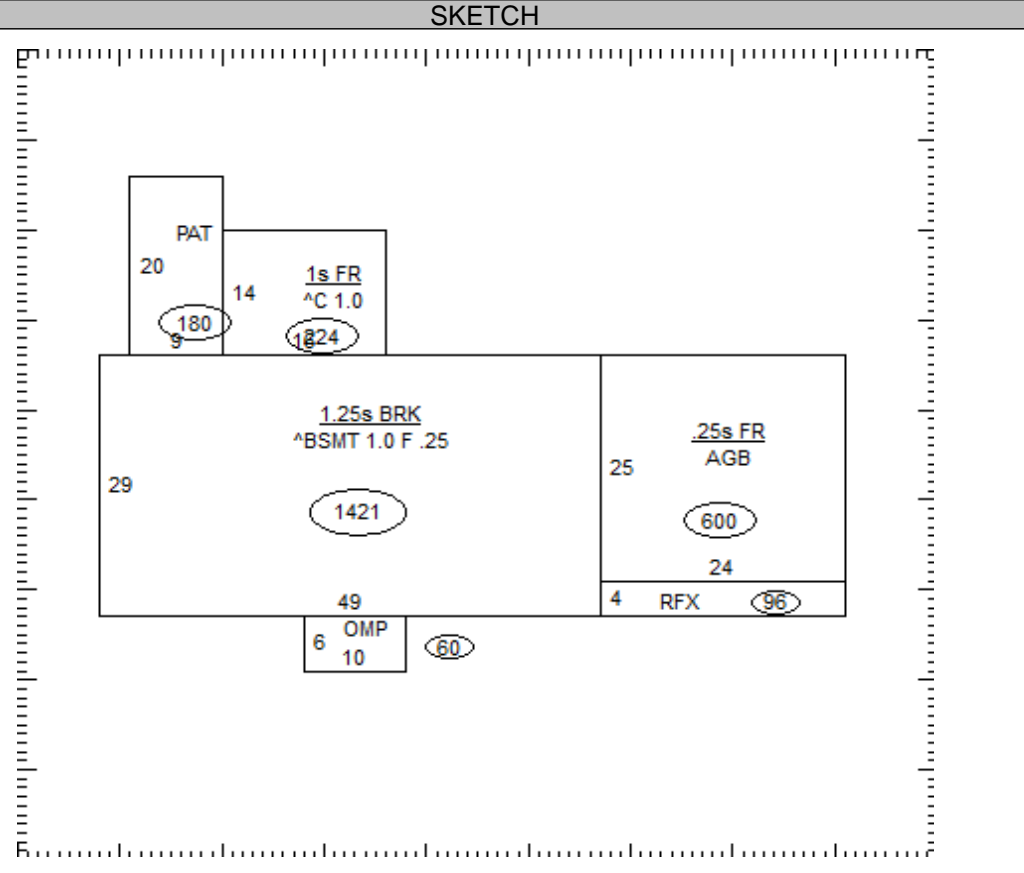

| OCCUPANCY | ST.HT | SIZE | AREA | GRADE | PRICE | AGE | REMD | CND | UNADJ VAL | PHYS | PHYS VAL | FUNC | TRUE VAL |
|-----------|-------|------|-------|-------|-------|------|------|-----|-----------|------|----------|------|----------|
| DWELLING | 1.25 | SK | 2,150 | B- | | 1993 | | A | 239,990 | 19 | 194,390 | | 180,800 |
| 1 | | | | | | | | | | | | | |
| 2 | | | | | | | | | | | | | |
| 3 | | | | | | | | | | | | | |
| 4 | | | | | | | | | | | | | |
| 5 | | | | | | | | | | | | | |
| 6 | | | | | | | | | | | | | |
| 7 | | | | | | | | | | | | | |
| 8 | | | | | | | | | | | | | |
| 9 | | | | | | | | | | | | | |
| 10 | | | | | | | | | | | | | |
| 11 | | | | | | | | | | | | | |

09-062100.0105 TOTAL 180,800

COMMENTS

Dwelling has an Economic Factor of 93%