

OCCUPANCY	EXTERIOR	FLOOR	AREA	CONST	VALUE
<input checked="" type="checkbox"/> SNGL FMLY	<input type="checkbox"/> WOOD	1	2137	FR	145,830
<input type="checkbox"/> DUPLEX	<input type="checkbox"/> STUCCO	+	0	FR	4,520
<input type="checkbox"/> TRIPLEX	<input checked="" type="checkbox"/> ALM/VYNL				
<input type="checkbox"/> CONVR	<input type="checkbox"/> CONC BLK				
<input type="checkbox"/> MOBILE HM	<input type="checkbox"/> METAL				
<input type="checkbox"/> BI/L TRI/L	<input checked="" type="checkbox"/> BRICK				
<input type="checkbox"/> MOD/MAN	<input type="checkbox"/> STONE				

ROOFING	ROOF TYPE
<input type="checkbox"/> METAL	<input checked="" type="checkbox"/> GABLE
<input type="checkbox"/> SLT/TLE	<input type="checkbox"/> HIP
<input checked="" type="checkbox"/> SHINGLES	<input type="checkbox"/> GAMBREL
<input type="checkbox"/> SHAKES	<input type="checkbox"/> MANSARD
<input type="checkbox"/> COMPOSITE	<input type="checkbox"/> FLAT

FLOORS	B	1	2	3	U
CONCRETE	<input checked="" type="checkbox"/>	<input type="checkbox"/>	<input type="checkbox"/>	<input type="checkbox"/>	<input type="checkbox"/>
WOOD	<input type="checkbox"/>	<input type="checkbox"/>	<input type="checkbox"/>	<input type="checkbox"/>	<input type="checkbox"/>
TILE/COMPO	<input type="checkbox"/>	<input checked="" type="checkbox"/>	<input type="checkbox"/>	<input type="checkbox"/>	<input type="checkbox"/>
CARPET	<input type="checkbox"/>	<input checked="" type="checkbox"/>	<input type="checkbox"/>	<input type="checkbox"/>	<input type="checkbox"/>

INT. FINISH	B	1	2	3	U
PLASTER/DW	<input type="checkbox"/>	<input checked="" type="checkbox"/>	<input type="checkbox"/>	<input type="checkbox"/>	<input type="checkbox"/>
PANELING	<input type="checkbox"/>	<input type="checkbox"/>	<input type="checkbox"/>	<input type="checkbox"/>	<input type="checkbox"/>
UNFINISHED	<input checked="" type="checkbox"/>	<input type="checkbox"/>	<input type="checkbox"/>	<input type="checkbox"/>	<input type="checkbox"/>

ACCOMMODATIONS	
# OF ROOMS	7
BEDROOMS	3
FIREPLACES	
HEAT & AC	B 1 2 3 U
NO HEAT	<input type="checkbox"/>
CTRL HEAT	<input checked="" type="checkbox"/>
HW/STEAM	<input type="checkbox"/>
ELECTRIC	<input type="checkbox"/>
HEAT PUMP	<input type="checkbox"/>
FLR/WALL	<input type="checkbox"/>
STVE/SPCE	<input type="checkbox"/>
GEOHERMAL	<input type="checkbox"/>
OUTSIDE	<input type="checkbox"/>
CTRL A/C	<input checked="" type="checkbox"/>

BSMT	AREA	VALUE
BSMT	2137	27,780
SUBTOTAL		178,130

MULTI-FAMILY #	0	0
MULTI-FAMILY #	0	0
BSMT FINISH	0 S.F.	0
FIREPLACE #	0	0
HEATING	0 S.F.	0
AIR COND	2,137 S.F.	3,210
PLUMBING #	5	5,500
GARAGES & CARPORTS		12,100
EXTRA FEATURES		10,200
SUBTOTAL		209,140
GRADE FACTOR		120 %
UNADJUSTED VALUE		250,970
FACTOR		100 %

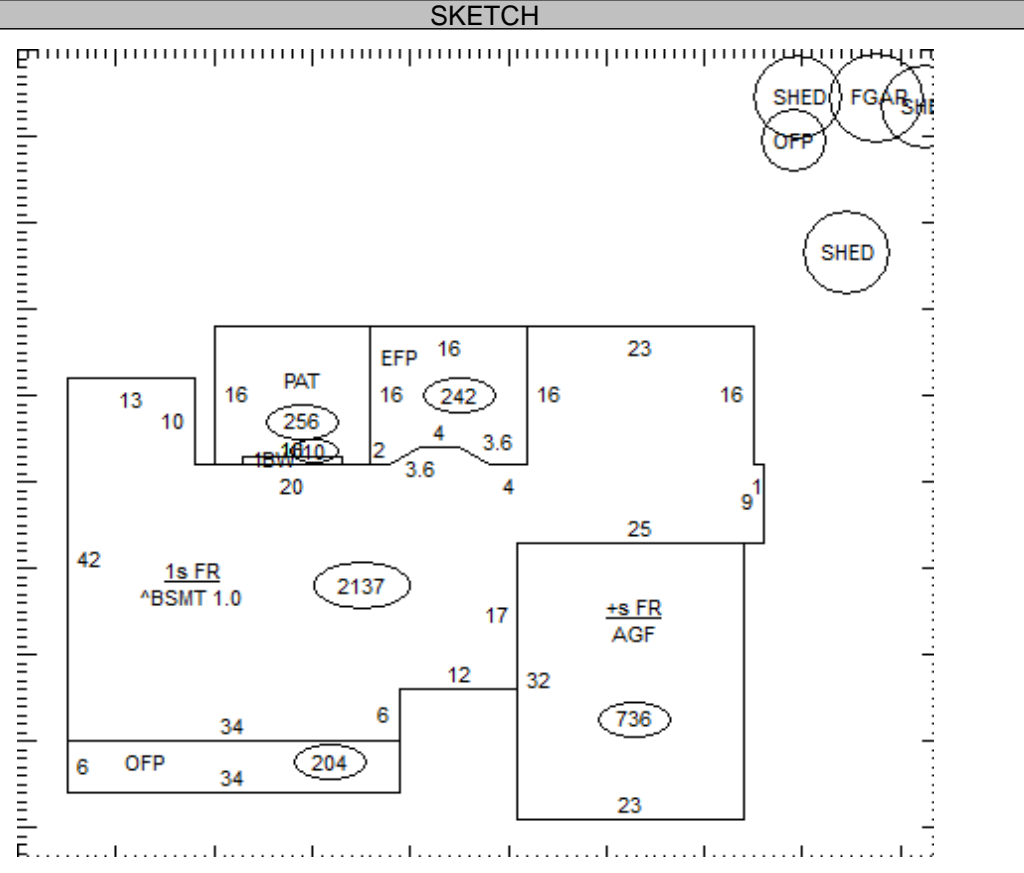

OCCUPANCY	ST.HT	SIZE	AREA	GRADE	PRICE	AGE	REMD	CND	UNADJ VAL	PHYS	PHYS VAL	FUNC	TRUE VAL
DWELLING	1	SK	2,137	B		2001		A	250,970	14	215,830		194,200
1 Shed		10x16	160	C	9.00	2010		A	1,440	9	1,310		1,300
2 Shed		20x34	680	C	6.00	2010		A	4,080	9	3,710		3,700
3 OFF		9x34	306	C	14.58	2010		A	4,460	9	4,060		4,100
4 Shed		16x16	256	C	7.00	2010		A	1,790	9	1,630		1,600
5 Gar - Frame		16x40	640	E	7.90	2010		A	5,060	10	4,550		4,600
6													
7													
8													
9													
10													
11													

06-061800.0800

TOTAL 209,500

COMMENTS
 75 X 8 BRICK TRIM
 Dwelling has an Economic Factor of 90%